

# EASTERN SLOPE REGIONAL AIRPORT FRYEBURG, MAINE

## AIRPORT MASTER PLAN UPDATE

AIP PROJECT  
NO. 3-23-0022-10-2005

AUGUST 2008

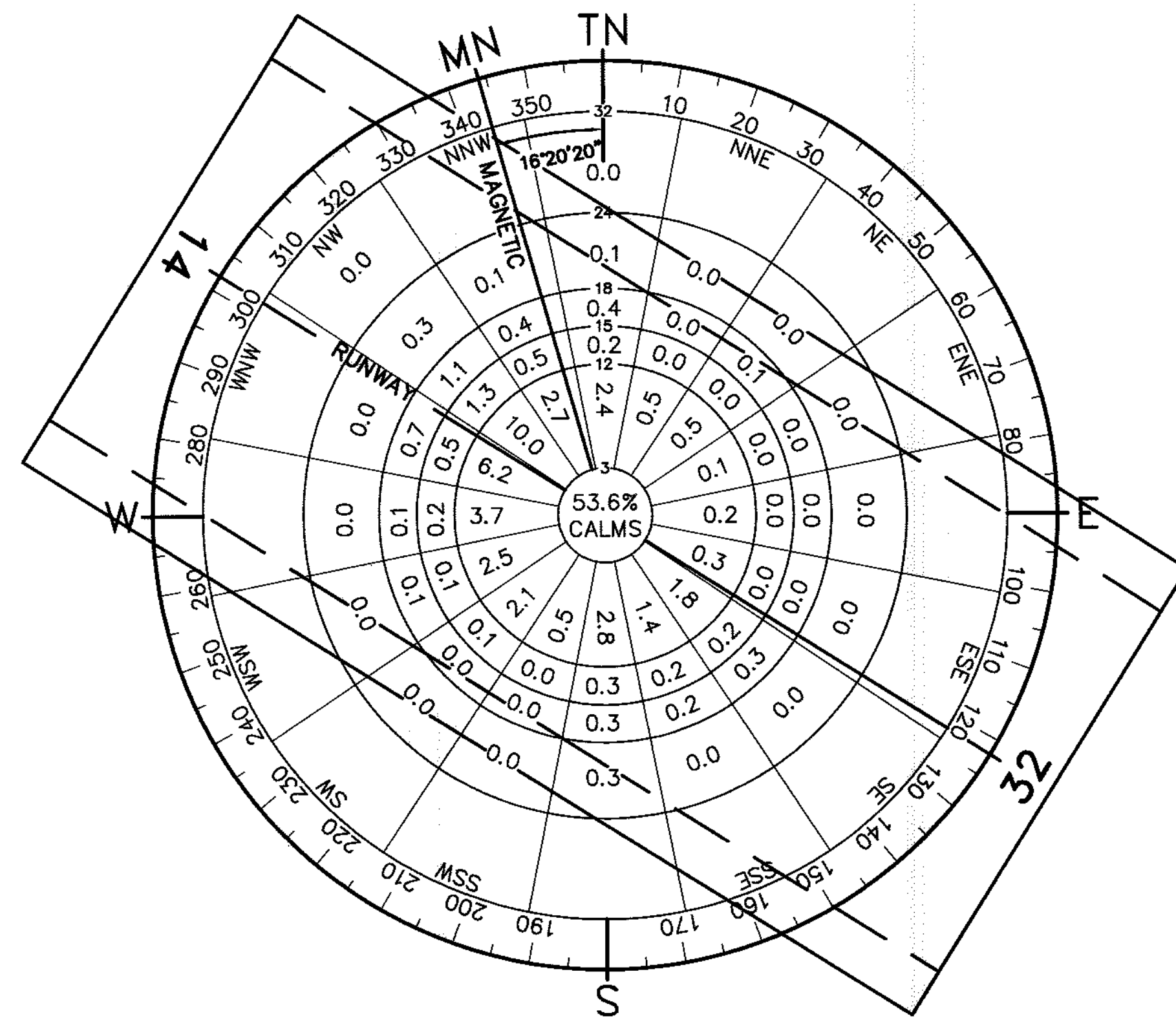
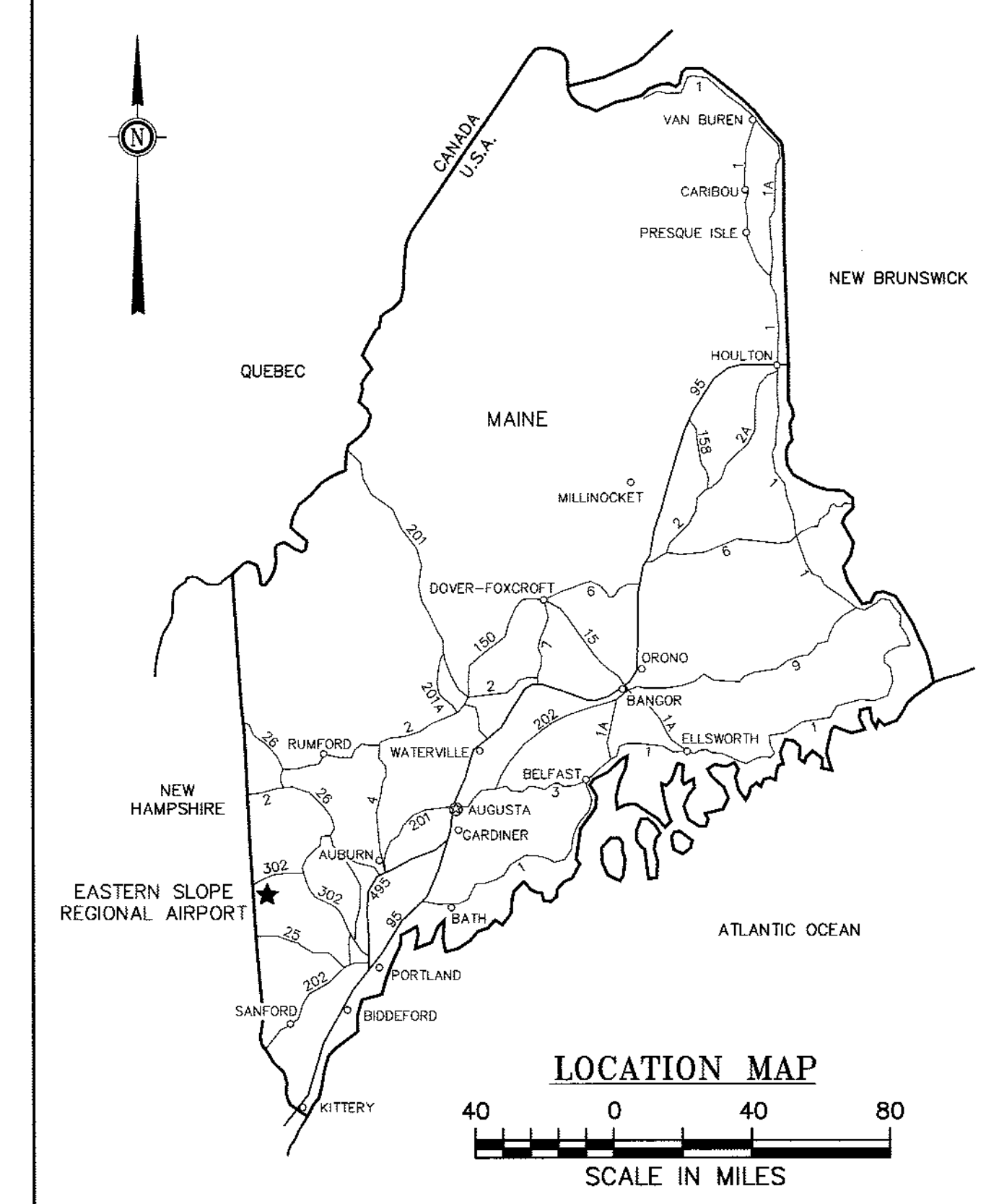
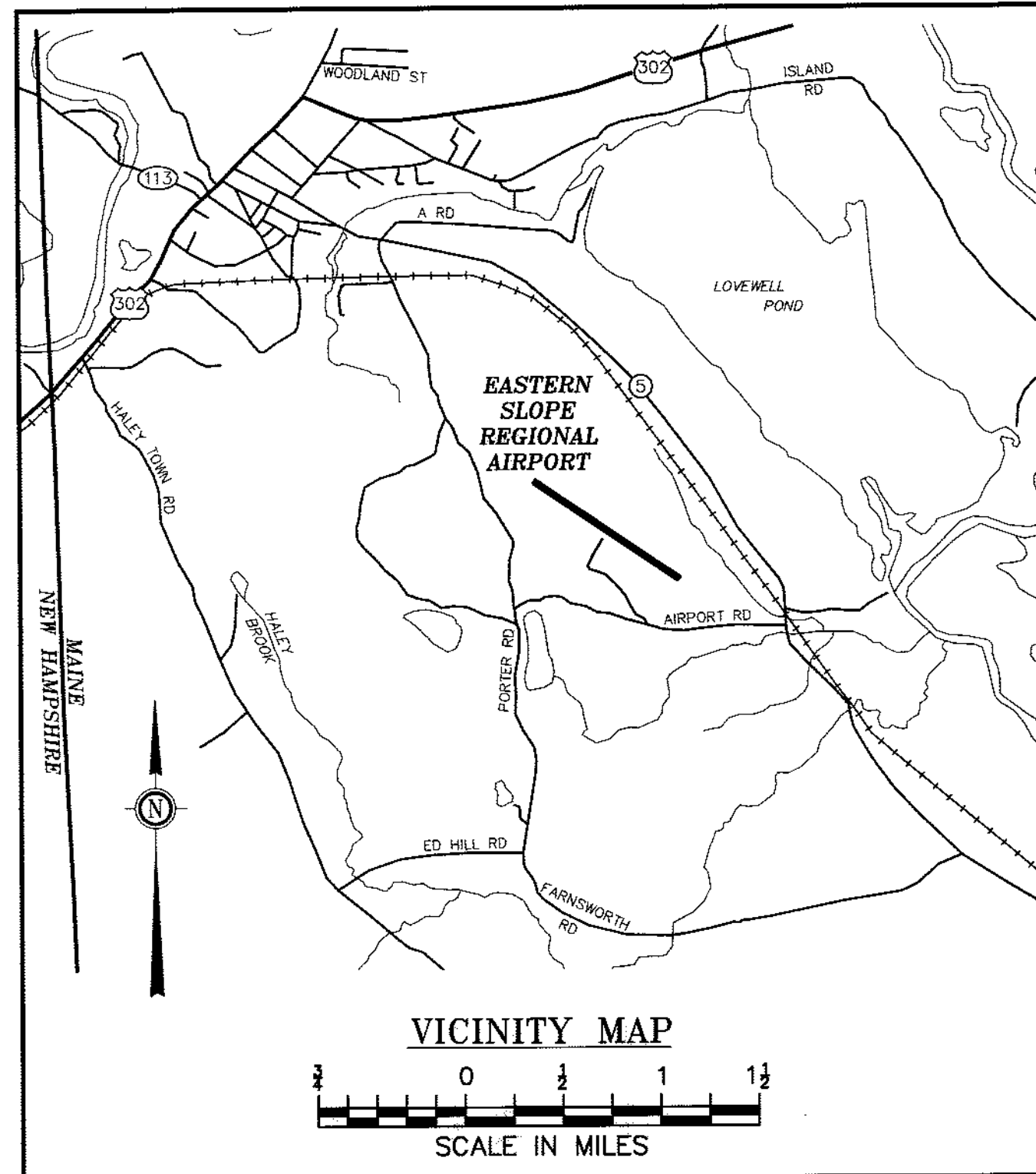

WIND COVERAGE		
	12 MPH	15 MPH
COMBINED	97.8%	99.3%

**WIND ROSE NOTES:**

SOURCE: NATIONAL CLIMATIC DATA CENTER,  
ASHEVILLE, NC

STATION: BERLIN, NEW HAMPSHIRE

PERIOD: 1951-1960, JUNE-SEPTEMBER

NUMBER OF OBSERVATIONS: 8,013

MAGNETIC DECLINATION: 16°20'20" WEST (1980)

**TABLE OF CONTENTS**

SHEET	DESCRIPTION
1	COVER SHEET
2	EXISTING FACILITIES PLAN
3	AIRPORT LAYOUT PLAN
4	PAVEMENT HISTORY PLAN
5	TERMINAL AREA PLAN
6	RUNWAY 14 APPROACH PLAN AND PROFILE
7	RUNWAY 32 APPROACH PLAN AND PROFILE
8	FAR PART 77 SURFACES PLAN

PREPARED BY



Boston Baltimore Orlando San Francisco

Gale Associates, Inc.  
Engineers Architects Planners  
15 Constitution Drive | Bedford, NH 03110  
P 603.471.1887 F 603.471.1809 www.gainc.com

FINAL

Copyright ©2008

SHEET NO.

1

1 OF 8

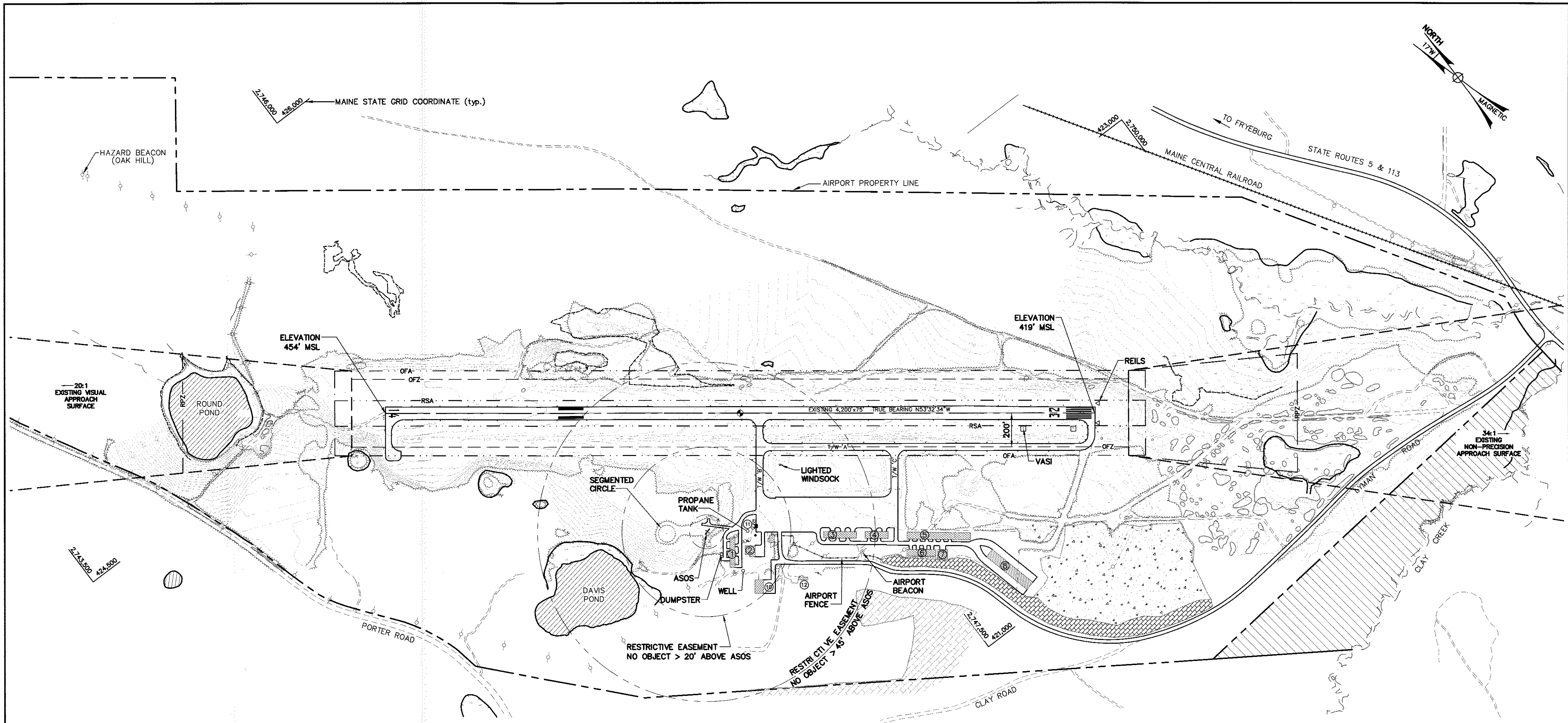

PROJECT  
AIRPORT MASTER PLAN UPDATE  
AIP NO. 3-23-0022-10-2005

OWNER  
EASTERN SLOPE REGIONAL AIRPORT  
FRYEBURG, MAINE

**RUNWAY PROTECTED ZONES**

	EXISTING
RSA WIDTH	150 FEET
RSA LENGTH BEYOND END OF R/W	300 FEET
RSA LENGTH PRIOR TO LANDING THRESHOLD	300 FEET
RUNWAY OBJECT FREE AREA WIDTH	500 FEET
RUNWAY OBJECT FREE AREA LENGTH BEYOND R/W END	300 FEET
RUNWAY OBSTACLE FREE ZONE WIDTH	400 FEET
RUNWAY OBSTACLE FREE ZONE LENGTH BEYOND R/W END	200 FEET

**RPZ DIMENSIONS**

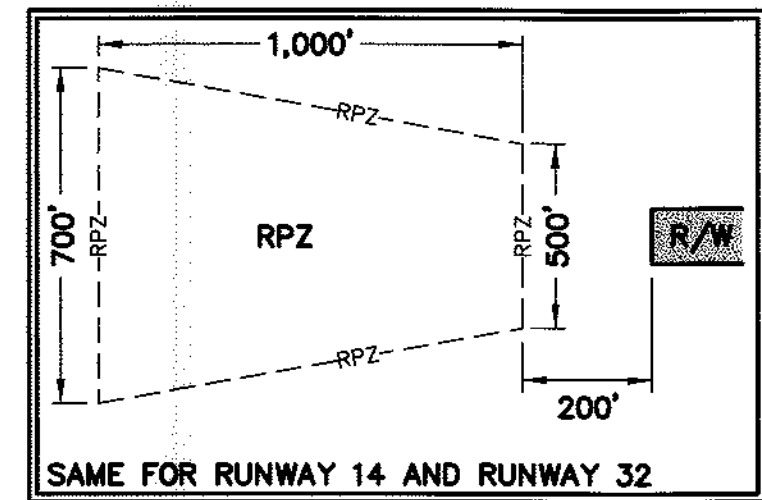

**RUNWAY DATA**

	EXISTING
RUNWAY LENGTH x WIDTH	4,200' x 75'
% ALL WEATHER WIND COVERAGE*	97.8 % (12 M.P.H.) 99.3 % (15 M.P.H.)
PAVEMENT TYPE & STRENGTH	BITUMINOUS CONCRETE / UNKNOWN
RUNWAY LIGHTING	MIRL
APPROACH SURFACE SLOPE / TYPE	R/W 14 20:1 / VISUAL R/W 32 34:1 / NON-PRECISION
APPROACH VISIBILITY MINIMUMS	R/W 14 ≥ 1-1/4 MILES VISIBILITY ≥ 1,500 FEET CEILING R/W 32 ≥ 1-1/4 MILES VISIBILITY ≥ 1,100 FEET CEILING
FAR PART 77 RUNWAY CLASSIFICATION	OTHER THAN UTILITY
EFFECTIVE GRADIENT	0.84 %
RUNWAY MARKING	R/W 14 VISUAL R/W 32 NON-PRECISION
DESIGN AIRCRAFT	BEECH SUPER KING AIR B200
R/W 14 END COORDINATES	LAT 43°59'40" N LONG 70°57'15" W
R/W 32 END COORDINATES	LAT 43°59'15" N LONG 70°56'29" W

\* WIND DATA FROM BERLIN MUNICIPAL AIRPORT FROM 1951-1960 (JUNE-SEPTEMBER).

**AIRPORT FACILITIES**

NO.	EXISTING FACILITY
①	SIX UNIT T-HANGAR
②	FBO MAINTENANCE HANGAR
③	SIX UNIT T-HANGAR
④	FOUR UNIT T-HANGAR
⑤	SIX UNIT T-HANGAR
⑥	FOUR UNIT T-HANGAR
⑦	CONVENTIONAL HANGAR
⑧	13 UNIT T-HANGAR
⑨	TERMINAL BUILDING
⑩	SRE MAINTENANCE & STORAGE BUILDING
⑪	FUEL FARM
⑫	MOBILE HOME

**PITCH PINE/SCRUB OAK COMMUNITIES**

////// PITCH PINE/SCRUB OAK COMMUNITY INTACT CANOPY; MEETS MAINE NATURAL AREAS PROGRAM DEFINITION  
 // PITCH PINE/SCRUB OAK COMMUNITY INTACT BUT FRAGMENTED CANOPY; DOES NOT MEET MAINE NATURAL AREAS PROGRAM DEFINITION  
 . . . . . PITCH PINE/SCRUB OAK COMMUNITY HEAVILY IMPACTED; DOES NOT MEET MAINE NATURAL AREAS PROGRAM DEFINITION

**LEGEND**

- LIMIT OF APPROACH SURFACE
- - - - - OFA RUNWAY OBJECT FREE AREA (OFA)
- - - - - OFZ RUNWAY OBSTACLE FREE ZONE (OFZ)
- RPZ RUNWAY PROTECTION ZONE (RPZ)
- - - - - RSA RUNWAY SAFETY AREA (RSA)
- TREE LINE
- STREAM/ CREEK/ BROOK
- WETLANDS
- EXISTING AVIGATION EASEMENT
- EXISTING AIRPORT REFERENCE POINT
- EXISTING POLE

**AIRPORT DATA**

	EXISTING
AIRPORT ELEVATION	454.3 FT. MSL
AIRPORT REFERENCE POINT (ARP)	LAT 43°59'28" N LONG 70°56'52" W
NORMAL MAXIMUM TEMPERATURE	82° F
TAXIWAY LIGHTING	MITL
TAXIWAY MARKING	STANDARD
NAVIGATIONAL AND VISUAL AIDS	NDB, ASOS, REILS (32), VASI-2L (32) ROTATING BEACON, WINDSOCK
AIRPORT REFERENCE CODE	B II (OTHER THAN UTILITY)

**NOTES:**

1. PITCH PINE/SCRUB OAK COMMUNITY DELINEATION PREPARED BY WOODLOT ALTERNATIVES, INC. ON NOVEMBER 8 AND 10, 2005 AND SURVEYED BY MAINE BOUNDARY CONSULTANTS ON NOVEMBER 18, 2005.

NO.	DATE	DESCRIPTION	BY
PROJECT NO.		775890	
CADD FILE		SHEET 2	
DESIGNED BY		CPL	
DRAWN BY		JAT	
CHECKED BY		AJD	
DATE		MARCH 24, 2008	
DRAWING SCALE		1"=300'	

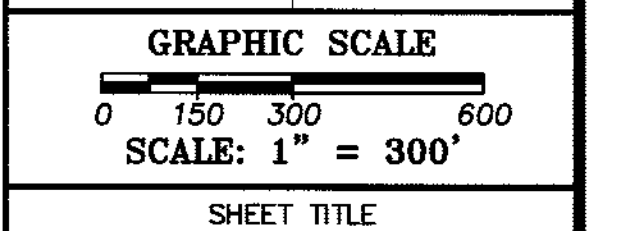

SHEET TITLE  
**EXISTING FACILITIES PLAN**

DRAWING NO.

**SHEET 2**



Gale Associates, Inc  
Engineers Architects Planners  
15 Constitution Drive  
Bedford, NH 03110  
P 603.471.1887 F 603.471.1809  
www.gainc.com

Boston Baltimore Orlando San Francisco  
The Airport Owner retains ownership of this drawing. The Owner may not use this drawing for other than the purpose intended. Gale Associates, Inc. shall not be responsible for any claims or damages, which may occur by virtue of the use of this drawing for any purpose other than that for which it was intended or by the modification of this drawing in any way from its original form. Copyright © 2008

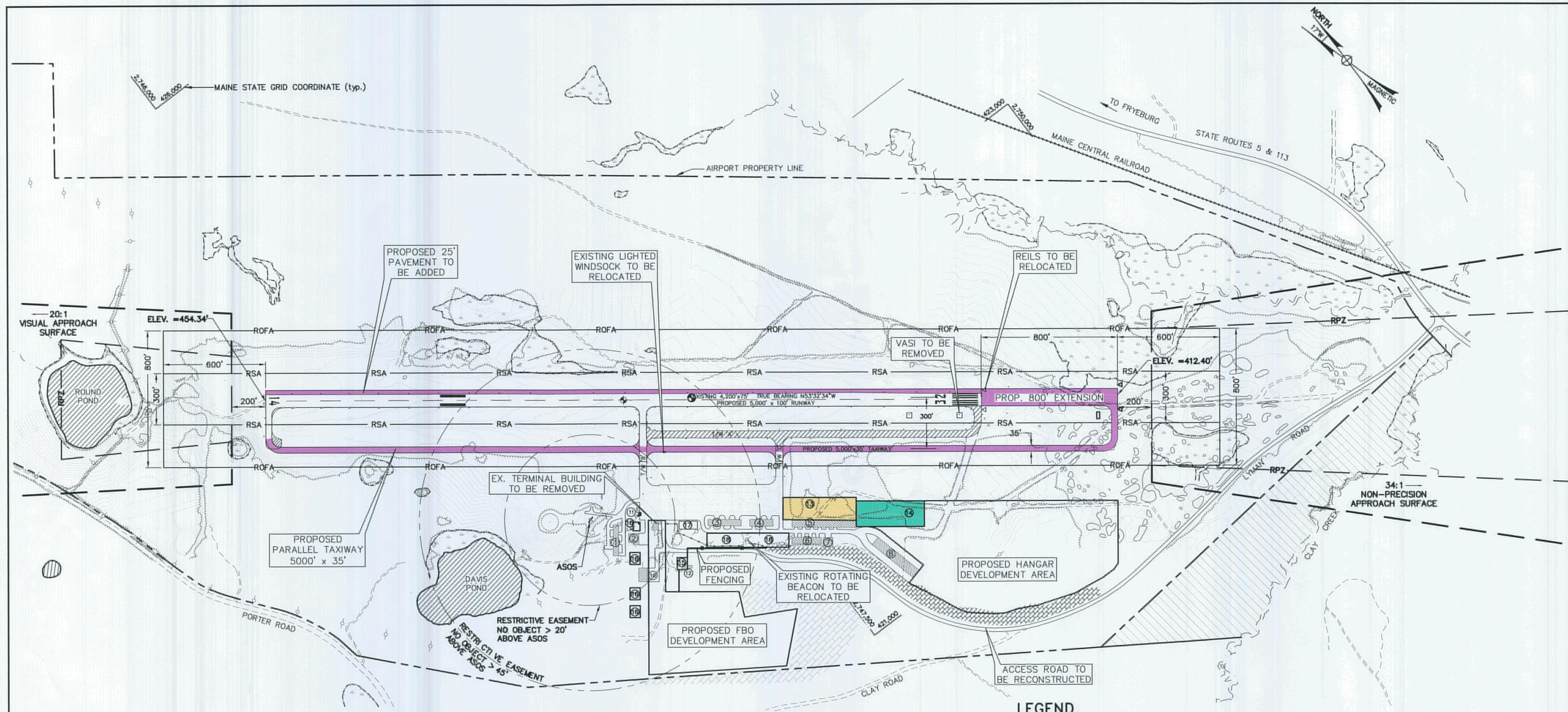

PROJECT  
AIRPORT MASTER PLAN UPDATE  
AIP NO. 3-23-0022-10-2005

OWNER  
EASTERN SLOPE REGIONAL AIRPORT  
FRYEBURG, MAINE

### RUNWAY PROTECTED ZONES

	EXISTING	PROPOSED
RSA WIDTH	150 FEET	300 FEET
RSA LENGTH BEYOND END OF R/W	300 FEET	600 FEET
RSA LENGTH PRIOR TO LANDING THRESHOLD	300 FEET	600 FEET
RUNWAY OBJECT FREE AREA WIDTH	500 FEET	800 FEET
RUNWAY OBJECT FREE AREA LENGTH BEYOND R/W END	300 FEET	600 FEET
RUNWAY OBSTACLE FREE ZONE WIDTH	400 FEET	400 FEET
RUNWAY OBSTACLE FREE ZONE LENGTH BEYOND R/W END	200 FEET	200 FEET

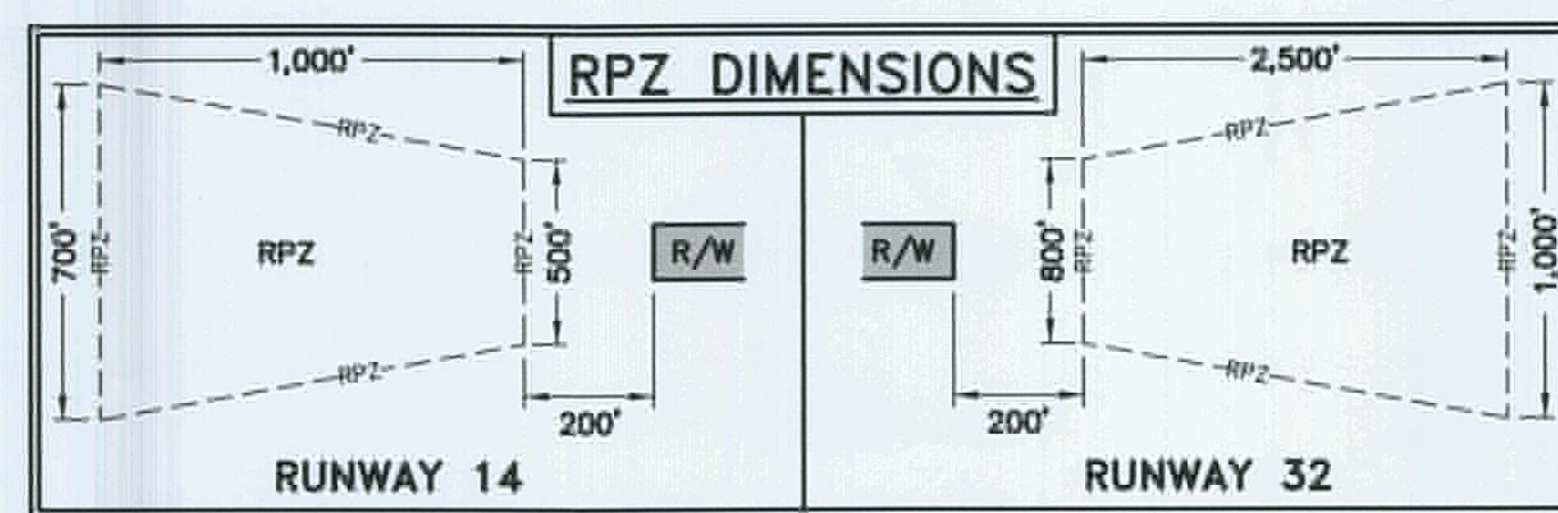

### RUNWAY DATA

	EXISTING	PROPOSED
RUNWAY LENGTH x WIDTH	4,200' x 75'	5,000' x 100'
% ALL WEATHER WIND COVERAGE*	97.8 % (12 M.P.H.) 99.3 % (15 M.P.H.)	97.8 % (12 M.P.H.) 99.3 % (15 M.P.H.)
PAVEMENT TYPE & STRENGTH	BITUMINOUS CONCRETE / UNKNOWN	BITUMINOUS CONCRETE
RUNWAY LIGHTING	MIRL	MIRL
APPROACH SURFACE SLOPE / TYPE	R/W 14 20:1 / VISUAL R/W 32 34:1 / NON-PRECISION	R/W 14 20:1 / VISUAL R/W 32 34:1 / NON-PRECISION
APPROACH VISIBILITY MINIMUMS	R/W 14 ≥ 1-1/4 MILE VISIBILITY ≥ 1,500 FEET CEILING R/W 32 ≥ 1-1/4 MILE VISIBILITY ≥ 1,100 FEET CEILING	R/W 14 ≥ 1-1/4 MILE VISIBILITY ≥ 1,500 FEET CEILING R/W 32 < 3/4 MILE VISIBILITY
FAR PART 77 RUNWAY CLASSIFICATION	OTHER THAN UTILITY	OTHER THAN UTILITY
EFFECTIVE GRADIENT	0.84 %	0.81 %
RUNWAY MARKING	R/W 14 VISUAL R/W 32 NON-PRECISION	R/W 14 VISUAL R/W 32 PRECISION
DESIGN AIRCRAFT	BEECH SUPER KING AIR B200	FALCON 50 BUSINESS JET
R/W 14 END COORDINATES	LAT 43°59'40" N LONG 70°57'15" W	LAT 43°59'41" N LONG 70°57'15" W
R/W 32 END COORDINATES	LAT 43°59'15" N LONG 70°56'29" W	LAT 43°59'11" N LONG 70°56'20" W

### LEGEND

- ROFA: RUNWAY OBJECT FREE AREA (OFA)
- OFZ: RUNWAY OBSTACLE FREE ZONE (OFZ)
- RPZ: RUNWAY PROTECTION ZONE (RPZ)
- RSA: RUNWAY SAFETY AREA (RSA)
- : TREE LINE
- ~~~~~: STREAM / CREEK / BROOK
- |||||: WETLANDS
- .-.-: EXISTING AVIGATION EASEMENT
- + : EXISTING AIRPORT REFERENCE POINT
- o : PROPOSED AIRPORT REFERENCE POINT (ARP)
- o : PROPOSED PAPI
- o : PROPOSED REILS
- ▬ : PAVEMENT TO BE REMOVED

### AIRPORT DATA

	EXISTING	PROPOSED
AIRPORT ELEVATION	454.3 FT. MSL	454.3 FT. MSL
AIRPORT REFERENCE POINT (ARP)	LAT 43°59'28" N LONG 70°56'52" W	LAT 43°59'26" N LONG 70°56'48" W
NORMAL MAXIMUM TEMPERATURE	82° F	82° F
TAXIWAY LIGHTING	MITL	MITL
TAXIWAY MARKING	STANDARD	STANDARD
NAVIGATIONAL AND VISUAL AIDS	NDB, ASOS, REILS (32), VASI-2L (32) ROTATING BEACON, WINDSOCK	NDB, ASOS, REILS (32), PAPI (32) ROTATING BEACON, WINDSOCK
AIRPORT REFERENCE CODE	B II (OTHER THAN UTILITY)	B II (OTHER THAN UTILITY)

### PITCH PINE/SCRUB OAK COMMUNITIES

- ▨: PITCH PINE/SCRUB OAK COMMUNITY INTACT CANOPY; MEETS MAINE NATURAL AREAS PROGRAM DEFINITION
- ▨: PITCH PINE/SCRUB OAK COMMUNITY INTACT BUT FRAGMENTED CANOPY; DOES NOT MEET MAINE NATURAL AREAS PROGRAM DEFINITION

### AIRPORT BUILDINGS

NO.	EXISTING FACILITY	NO.	EXISTING FACILITY
1	SIX UNIT T-HANGAR	11	FUEL FARM
2	FBO MAINTENANCE HANGAR	12	MOBILE HOME
3	SIX UNIT T-HANGAR		
4	FOUR UNIT T-HANGAR	NO.	PROPOSED FACILITY
5	SIX UNIT T-HANGAR	13	SMALL AIRCRAFT APRON 56,500 sq ft (12' TAIL HEIGHT)
6	FOUR UNIT T-HANGAR	14	JET AIRCRAFT APRON 80,000 sq ft (15' TAIL HEIGHT)
7	CONVENTIONAL HANGAR	15	PROPOSED TERMINAL
8	TEN UNIT T-HANGAR	16	FBO HANGARS
9	TERMINAL BUILDING	17	JET A FUEL FACILITY
10	SRE MAINTENANCE & STORAGE BUILDING	18	T-HANGAR DEVELOPMENT AREA

FEDERAL AVIATION ADMINISTRATION  
APPROVED: *Lisa J. Cooperance*  
AIRPORT PLANNER

DATE: *11/16/08 in accordance w/FAA letter 08 11/16/08*

MAINE DEPARTMENT OF TRANSPORTATION  
APPROVED: *Debra*  
DIRECTOR, OFFICE OF PASSENGER TRANSPORTATION

DATE: *11/13/2008*

FRYEBURG, MAINE  
APPROVED: *Don*  
CHAIRMAN, EASTERN SLOPE AIRPORT AUTHORITY

DATE: *9-2-08*

NO.	DATE	DESCRIPTION	BY

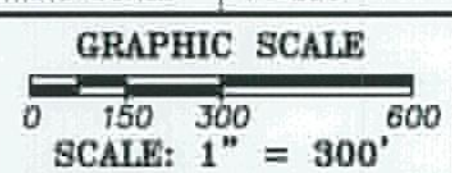

### AIRPORT LAYOUT PLAN

DRAWING NO.

# SHEET 3

3 OF 8

\* WIND DATA FROM BERLIN MUNICIPAL AIRPORT FROM 1951-1960 (JUNE-SEPTEMBER).





Gale Associates, Inc  
 Engineers Architects Planners  
 15 Constitution Drive  
 Bedford, NH 03110  
 P 603.471.1887 F 603.471.1809  
 www.gainc.com

The Airport Owner retains ownership of this drawing. The Owner may not use this drawing for other than the purpose intended. Gale Associates, Inc. shall not be responsible for any claims or damages, which may occur by virtue of the use of this drawing for any purpose other than that for which it was intended or by the modification of this drawing in any way from its original form. Copyright © 2008

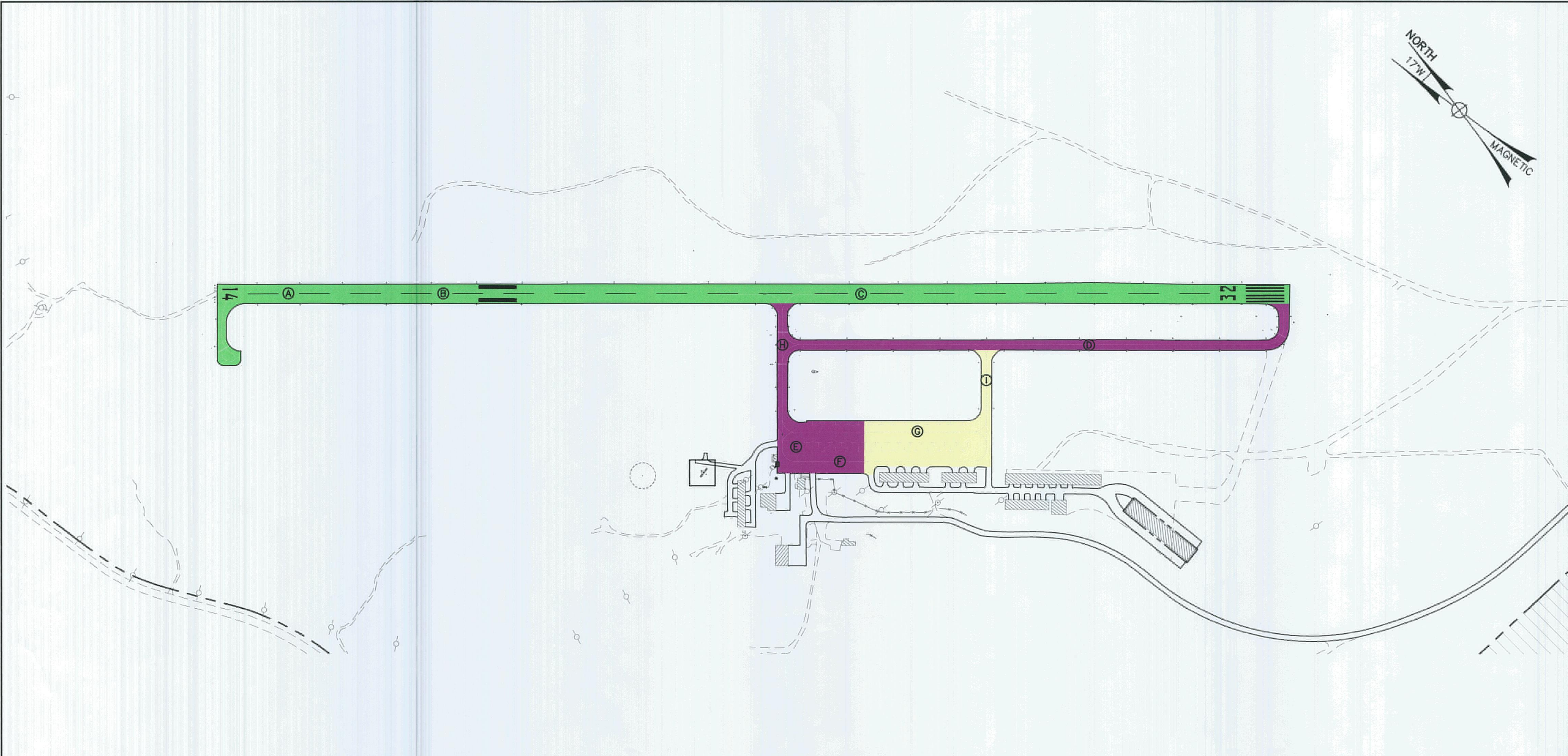
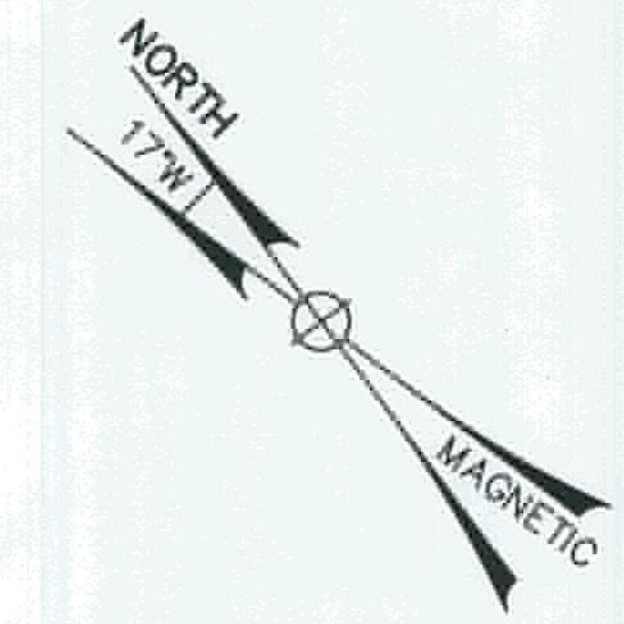

**PAVEMENT HISTORY DATA**

(A)	R/W 14 - 32	BITUMINOUS CONCRETE REHABILITATION EXTENDED R/W 14 1996 (500' x 75')
(B)	R/W 14	BITUMINOUS CONCRETE EXTENDED 1985 (700' x 75')
(C)	R/W 14 - 32	ORIGINAL BITUMINOUS CONCRETE 1961 (3,000' x 75')
(D)	PARALLEL TAXIWAY 'A'	ORIGINAL BITUMINOUS CONCRETE 1985 (2,000' x 40')
(E)	APRON	ORIGINAL BITUMINOUS CONCRETE 1961 (200' x 150')
(F)		EXPANDED BITUMINOUS CONCRETE 1975 (200'± x 210')
(G)		EXPANDED BITUMINOUS CONCRETE 1990 (210' x 500')
(H)	STUB TAXIWAY 'B'	ORIGINAL BITUMINOUS CONCRETE 1961 (460'± x 40')
(I)	STUB TAXIWAY 'C'	ORIGINAL BITUMINOUS CONCRETE 1990 (280' x 40')

**DESIGN LIFE DATA**

- DESIGN LIFE EXPIRED
- DESIGN LIFE EXPIRES 2010
- DESIGN LIFE EXPIRES 2016

PROJECT  
**AIRPORT MASTER PLAN UPDATE**  
 AIP NO. 3-23-0022-10-2005

OWNER  
 EASTERN SLOPE REGIONAL AIRPORT  
 FRYEBURG, MAINE

NO.	DATE	DESCRIPTION	BY
PROJECT NO.	775890		
CADD FILE	SHEET 4		
DESIGNED BY	CPL		
DRAWN BY	JAT		
CHECKED BY	AJD		
DATE	MARCH 24, 2008		
DRAWING SCALE	1"=200'		

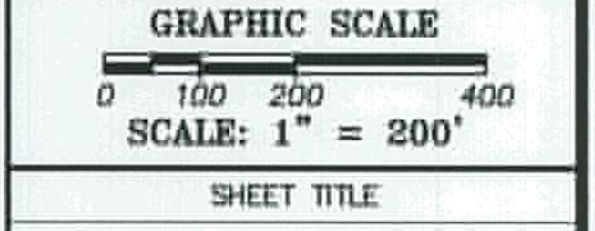

SHEET TITLE  
**PAVEMENT HISTORY PLAN**

DRAWING NO.  
**SHEET 4**

4 OF 8



**PITCH PINE/SCRUB OAK COMMUNITIES**

PITCH PINE/SCRUB OAK COMMUNITY INTACT CANOPY; MEETS MAINE NATURAL AREAS PROGRAM DEFINITION  
 PITCH PINE/SCRUB OAK COMMUNITY INTACT BUT FRAGMENTED CANOPY; DOES NOT MEET MAINE NATURAL AREAS PROGRAM DEFINITION

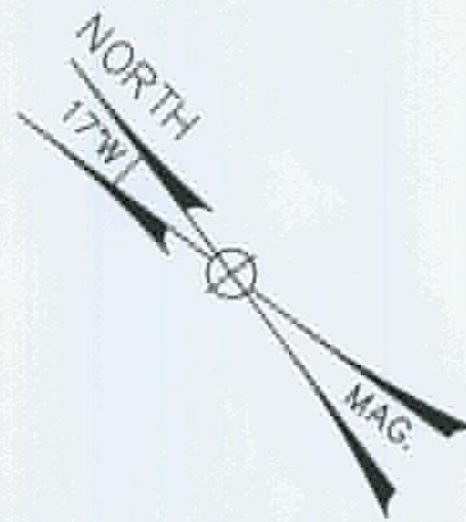
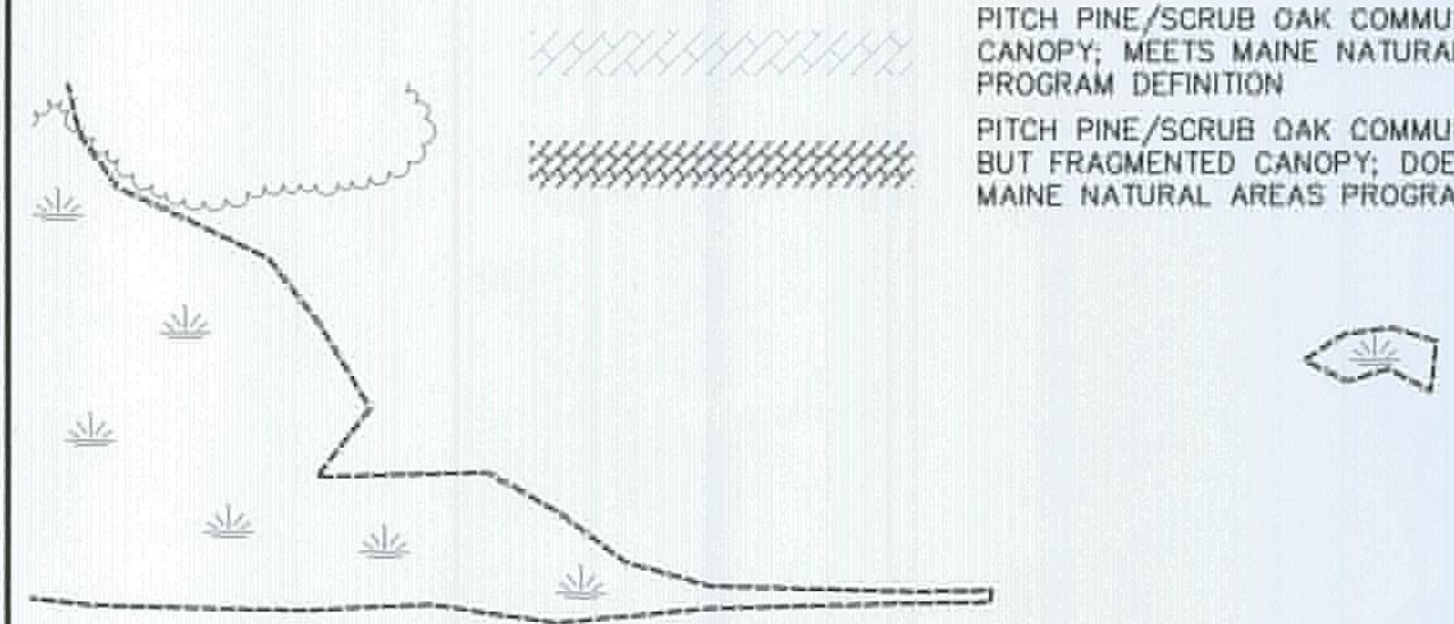

**AIRPORT BUILDINGS**

NO.	EXISTING FACILITY	NO.	EXISTING FACILITY
①	SIX UNIT T-HANGAR	⑪	FUEL FARM
②	FBO MAINTENANCE HANGAR	⑫	MOBILE HOME
③	SIX UNIT T-HANGAR		
④	FOUR UNIT T-HANGAR	NO.	PROPOSED FACILITY
⑤	SIX UNIT T-HANGAR	⑬	SMALL AIRCRAFT APRON
⑥	FOUR UNIT T-HANGAR	⑭	JET AIRCRAFT APRON
⑦	CONVENTIONAL HANGAR	⑮	PROPOSED TERMINAL
⑧	TEN UNIT T-HANGAR	⑯	FBO HANGARS
⑨	TERMINAL BUILDING	⑰	JET A MOBILE REFUELER PARKING
⑩	SRE MAINTENANCE & STORAGE BUILDING		

**LEGEND**

- PROPOSED RUNWAY AND TAXIWAY
- PROPOSED "SMALL AIRCRAFT" APRON
- PROPOSED "JET AIRCRAFT" APRON
- PROPOSED FBO HANGARS
- PROPOSED TERMINAL BUILDING
- FUTURE FBO DEVELOPMENT AREA
- FUTURE T-HANGAR DEVELOPMENT AREA
- PROPOSED FENCING



Gale Associates, Inc  
 Engineers Architects Planners  
 15 Constitution Drive  
 Bedford, NH 03110  
 P 603.471.1887 F 603.471.1809  
 www.gainc.com

The Airport Owner retains ownership of this drawing. The Owner may not use this drawing for other than the purpose intended. Gale Associates, Inc. shall not be responsible for any claims or damages, which may occur by virtue of the use of this drawing for any purpose other than that for which it was intended or by the modification of this drawing in any way from its original form. Copyright © 2008

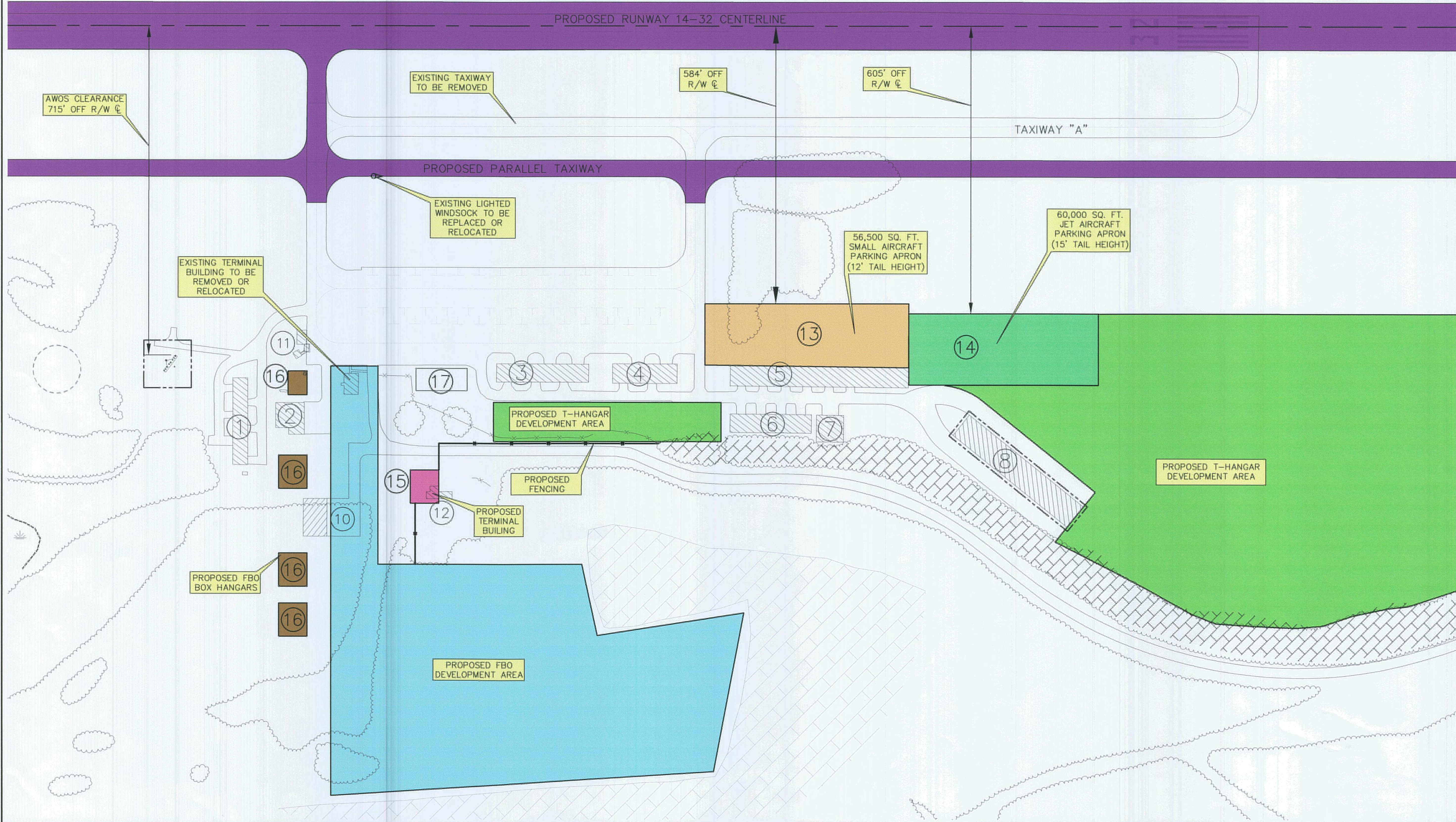

PROJECT  
 AIRPORT MASTER PLAN UPDATE  
 AIP NO. 3-23-0022-10-2005

OWNER  
 EASTERN SLOPE REGIONAL AIRPORT  
 FRYEBURG, MAINE

NO.	DATE	DESCRIPTION	BY
PROJECT NO.	775890		
CADD FILE	SHEET 5		
DESIGNED BY	CPL		
DRAWN BY	JAT		
CHECKED BY	AJD		
DATE	MARCH 24, 2008		
DRAWING SCALE	1"=300'		

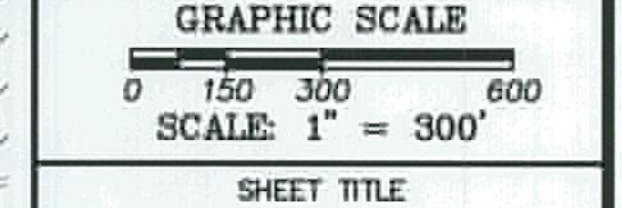

SHEET TITLE  
 TERMINAL AREA PLAN

DRAWING NO.  
**SHEET 5**  
 5 OF 8



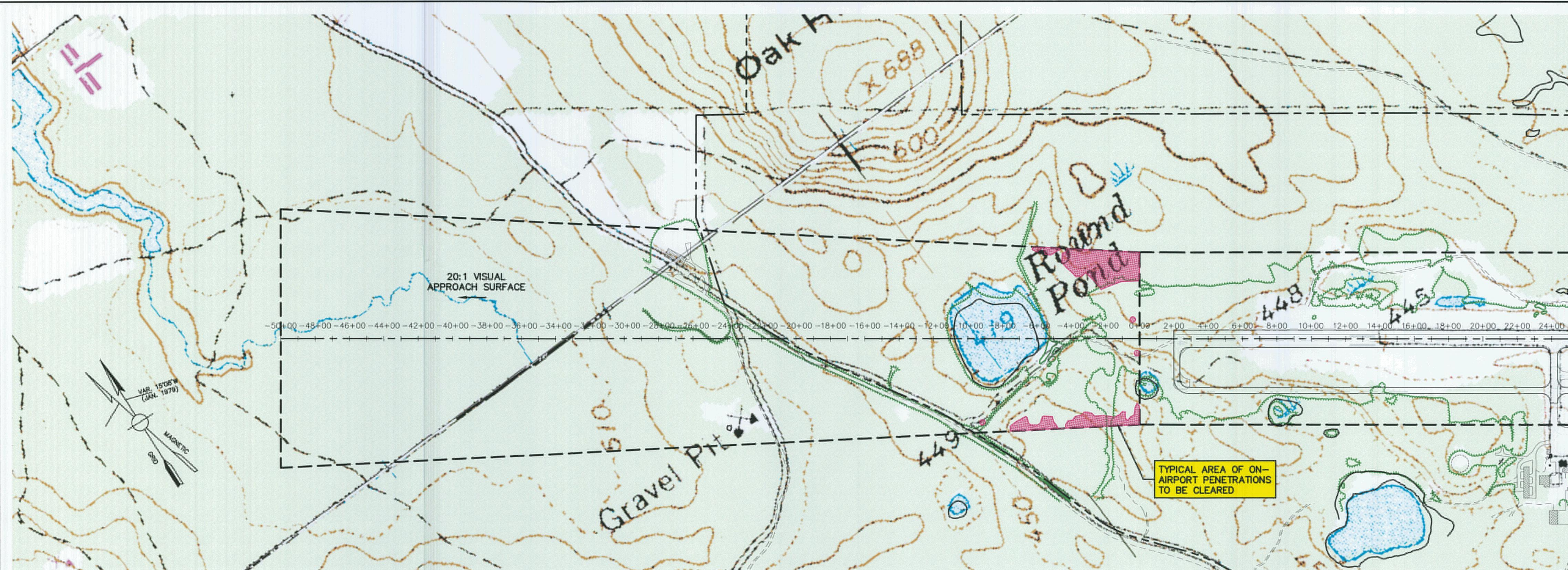

**RUNWAY 14 APPROACH - PLAN VIEW**

SCALE: 1" = 300'

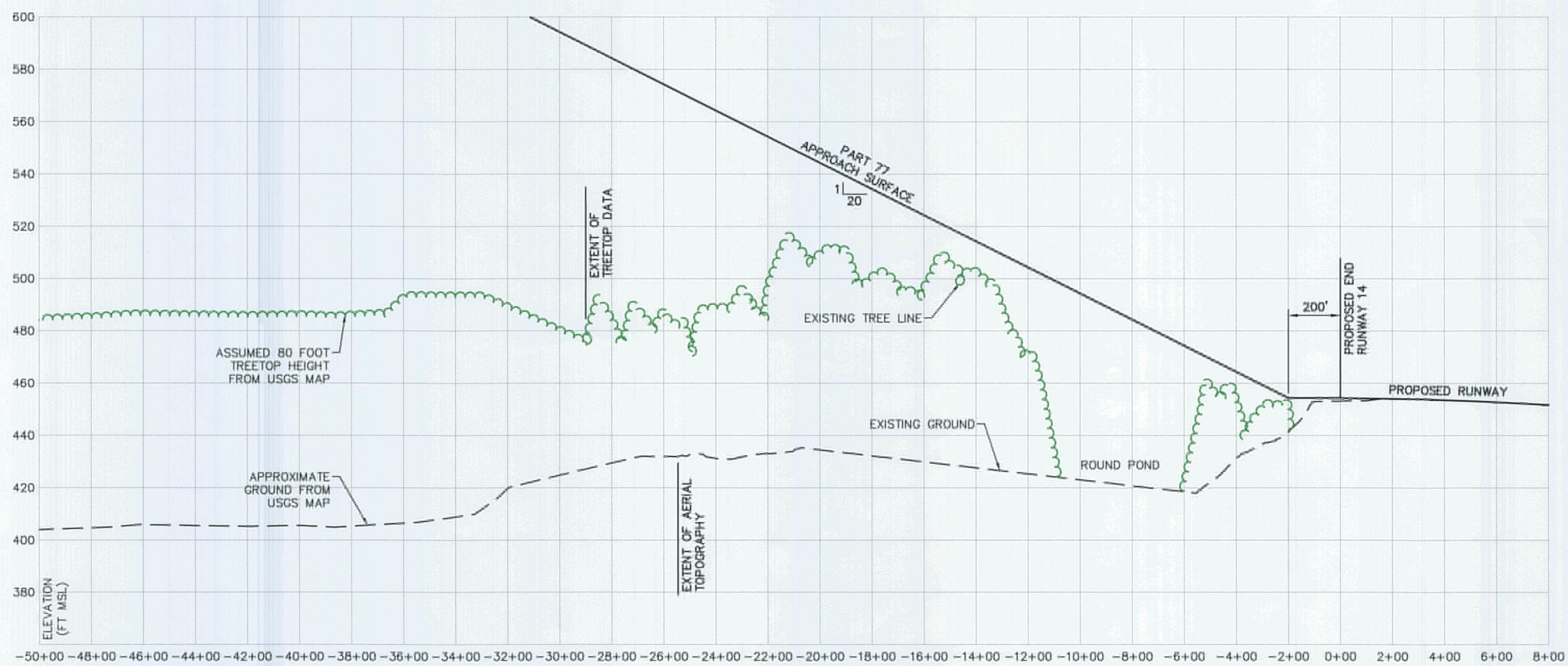

**RUNWAY 14 APPROACH - PROFILE**

SCALE: 1" = 300' HORIZONTAL  
1" = 30' VERTICAL

**LEGEND**

- EXISTING RAILROAD
- EXISTING AIRPORT PROPERTY LINE
- EXISTING AVIGATION EASEMENT
- PROPOSED RUNWAY CENTERLINE
- PROPOSED APPROACH SURFACE



Gale Associates, Inc  
Engineers Architects Planners  
15 Constitution Drive  
Bedford, NH 03110  
P 603.471.1887 F 603.471.1809  
www.gainc.com

Boston Baltimore Orlando San Francisco

The Airport Owner retains ownership of this drawing. The Owner may not use this drawing for other than the purpose intended. Gale Associates, Inc. shall not be responsible for any claims or damages, which may occur by virtue of the use of this drawing for any purpose other than that for which it was intended or by the modification of this drawing in any way from its original form. Copyright © 2008

PROJECT  
AIRPORT MASTER PLAN UPDATE  
AIP NO. 3-23-0022-10-2005

OWNER  
EASTERN SLOPE REGIONAL AIRPORT  
FRYEBURG, MAINE

NO.	DATE	DESCRIPTION	BY
PROJECT NO.		775890	
CADD FILE		SHEET 6	
DESIGNED BY		CPL	
DRAWN BY		JAT	
CHECKED BY		AJD	
DATE		MARCH 24, 2008	
DRAWING SCALE		1"=300'	

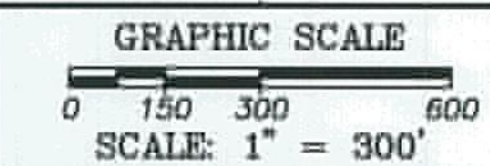

SHEET TITLE

RUNWAY 14  
APPROACH PLAN  
AND PROFILE

DRAWING NO.

**SHEET 6**

6 OF 8



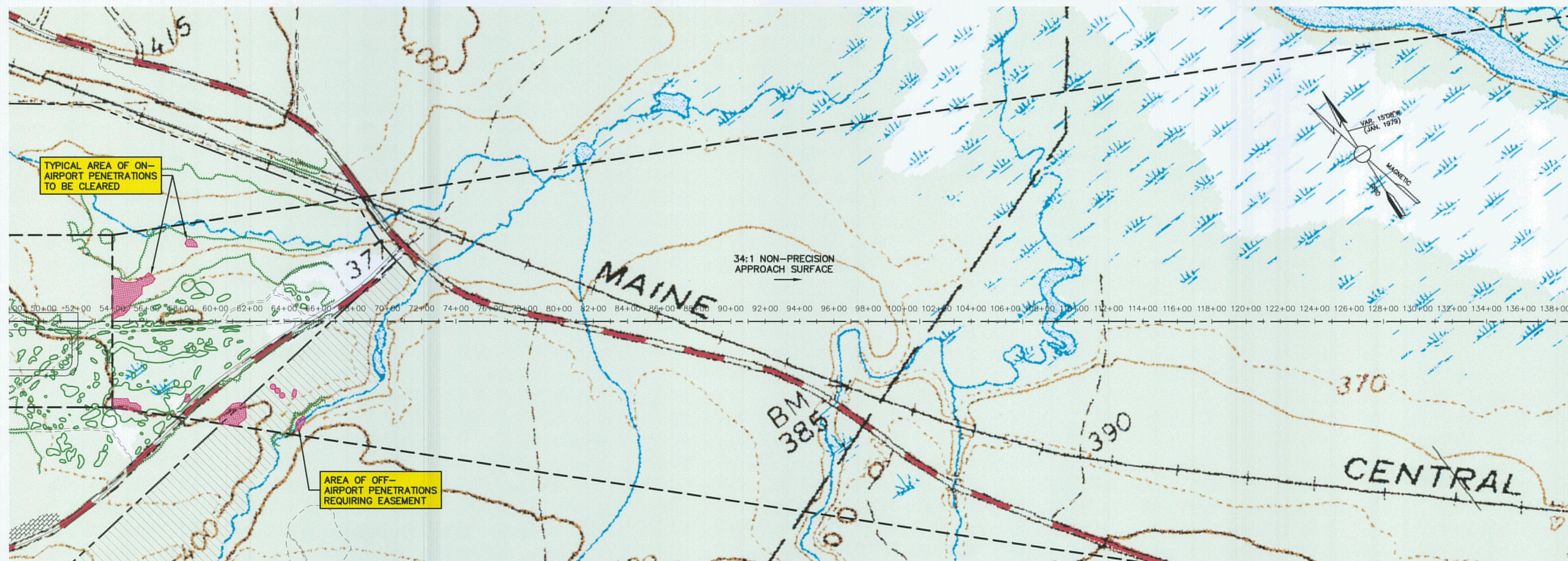

**RUNWAY 32 APPROACH – PLAN VIEW**

SCALE: 1" = 300'

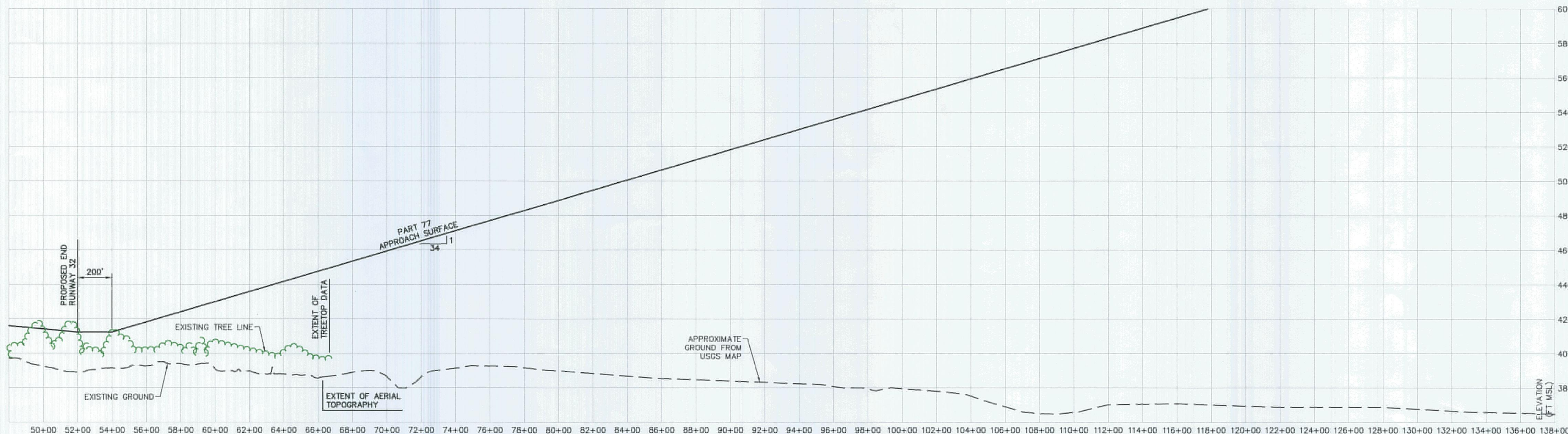

**RUNWAY 32 APPROACH – PROFILE**

SCALE: 1" = 300' HORIZONTAL  
 1" = 30' VERTICAL

**LEGEND**

- EXISTING RAILROAD
- EXISTING AIRPORT PROPERTY LINE
- EXISTING AVIGATION EASEMENT
- PROPOSED RUNWAY CENTERLINE
- PROPOSED APPROACH SURFACE

PROJECT	AIRPORT MASTER PLAN UPDATE AIP NO. 3-23-0022-10-2005
OWNER	EASTERN SLOPE REGIONAL AIRPORT FRYEBURG, MAINE

NO.	DATE	DESCRIPTION	BY
PROJECT NO.		775890	
CADD FILE		SHEET 6	
DESIGNED BY		CPL	
DRAWN BY		JAT	
CHECKED BY		AJD	
DATE		MARCH 24, 2008	
DRAWING SCALE		1"=300'	

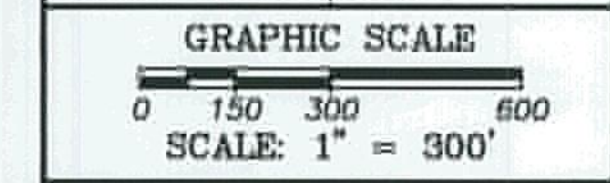

SHEET TITLE  
**RUNWAY 32 APPROACH PLAN AND PROFILE**

DRAWING NO.  
**SHEET 7**  
 7 OF 8



**APPROACH SURFACE STANDARDS**

RUNWAY	EXISTING
14	OTHER THAN UTILITY RUNWAY W/ VISUAL APPROACH
32	OTHER THAN UTILITY RUNWAY W/ NON-PRECISION APPROACH
RUNWAY	ULTIMATE
14	OTHER THAN UTILITY RUNWAY W/ VISUAL APPROACH
32	OTHER THAN UTILITY RUNWAY W/ NON-PRECISION APPROACH

**HAZARD BEACON SITES**

EXISTING	ULTIMATE *
① STARKS HILL NW OF R/W 14 END	④ HILL WNW OF R/W 14 END
② BALD PEAK WSW OF R/W 14 END	⑤ LONG HILL
③ OAK HILL N OF R/W 14 END	⑥ FROST MOUNTAIN
	⑦ PEARY MOUNTAIN

\* PENDING CONCURRENCE BY FAA.

**LEGEND**

	PRIMARY SURFACE
	APPROACH SURFACE
	TRANSITIONAL SURFACE
	HORIZONTAL SURFACE
	CONICAL SURFACE
	APPROACH CENTERLINE
	AIRPORT PROPERTY LINE
	GROUND PENETRATIONS
	TREE PENETRATIONS

NOTE: TREE HEIGHTS IN THE HORIZONTAL AND CONICAL SURFACES WERE ASSUMED AT 80 FEET TALL.

TOPOGRAPHIC SURVEY DATA FROM U.S.G.S. 7 1/2 - MINUTE QUADRANGLE MAPS, BROWNFIELD, ME, 1983 AND FRYEBURG, ME, 1989.

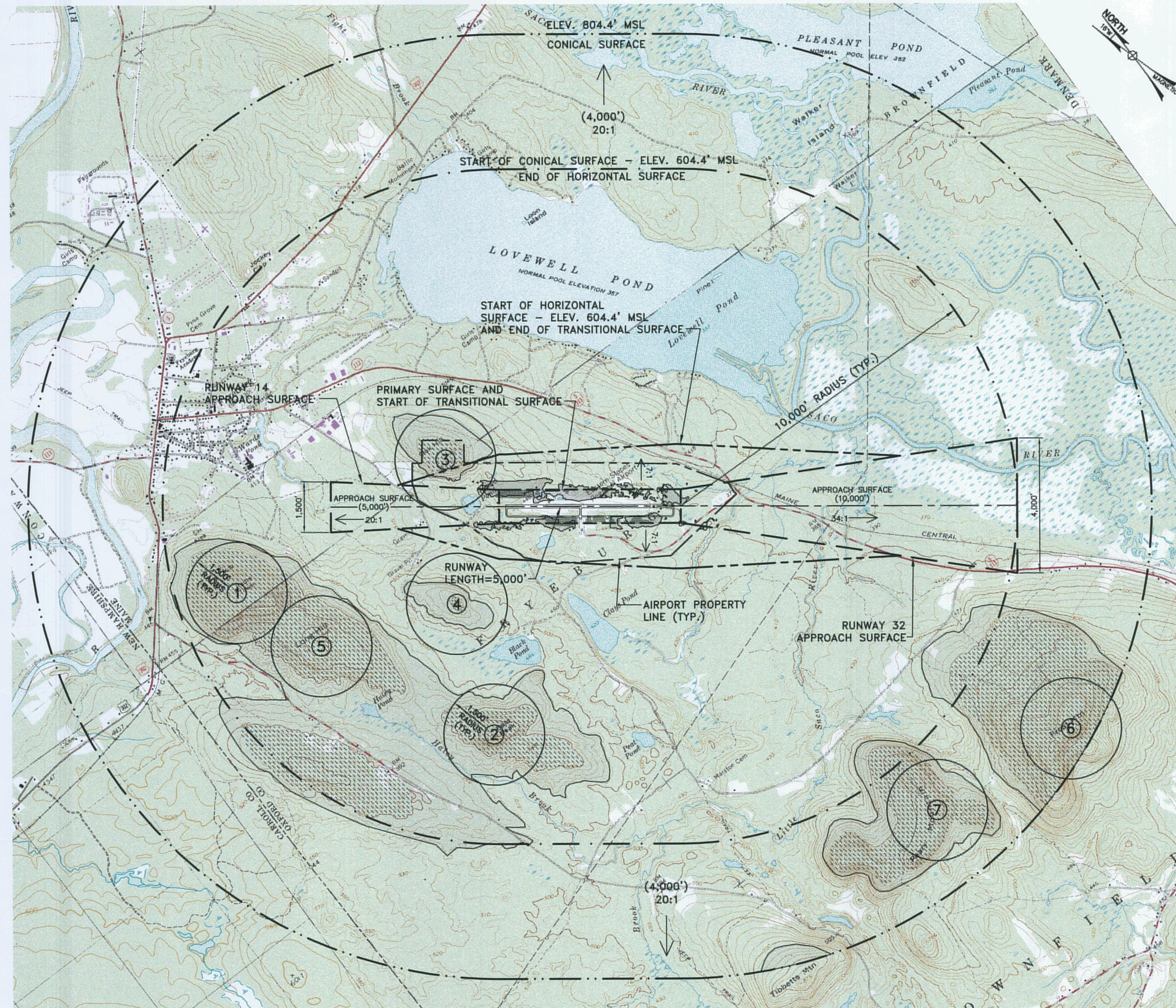

Gale Associates, Inc.  
Engineers Architects Planners  
15 Constitution Drive  
Bedford, NH 03110  
P 603.471.1887 F 603.471.1809  
www.gainc.com

Boston Baltimore Orlando San Francisco  
The Airport Owner retains ownership of this drawing. The Owner may not use this drawing for other than the purpose intended. Gale Associates, Inc. shall not be responsible for any claims or damages, which may occur by virtue of the use of this drawing for any purpose other than that for which it was intended or by the modification of this drawing in any way from its original form. Copyright © 2008

PROJECT  
**AIRPORT MASTER PLAN UPDATE**  
AIP NO. 3-23-0022-10-2005

OWNER  
**EASTERN SLOPE REGIONAL AIRPORT**  
FRYEBURG, MAINE

NO.	DATE	DESCRIPTION	BY

GRAPHIC SCALE  
0 750 1,500 3,000  
SCALE: 1" = 1,500'

SHEET TITLE  
**FAR PART 77**  
**SURFACES PLAN**

DRAWING NO.  
**SHEET 8**