

PRESQUE ISLE MUNICIPAL AIRPORT

PRESQUE ISLE, MAINE

AIRPORT MASTER PLANS

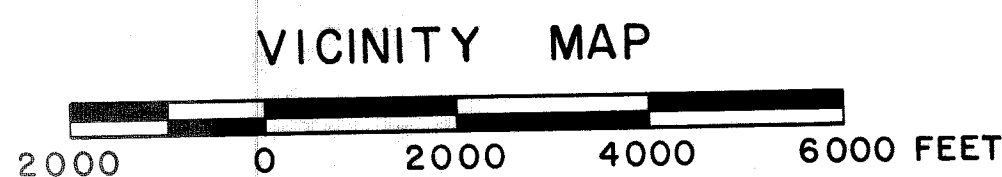
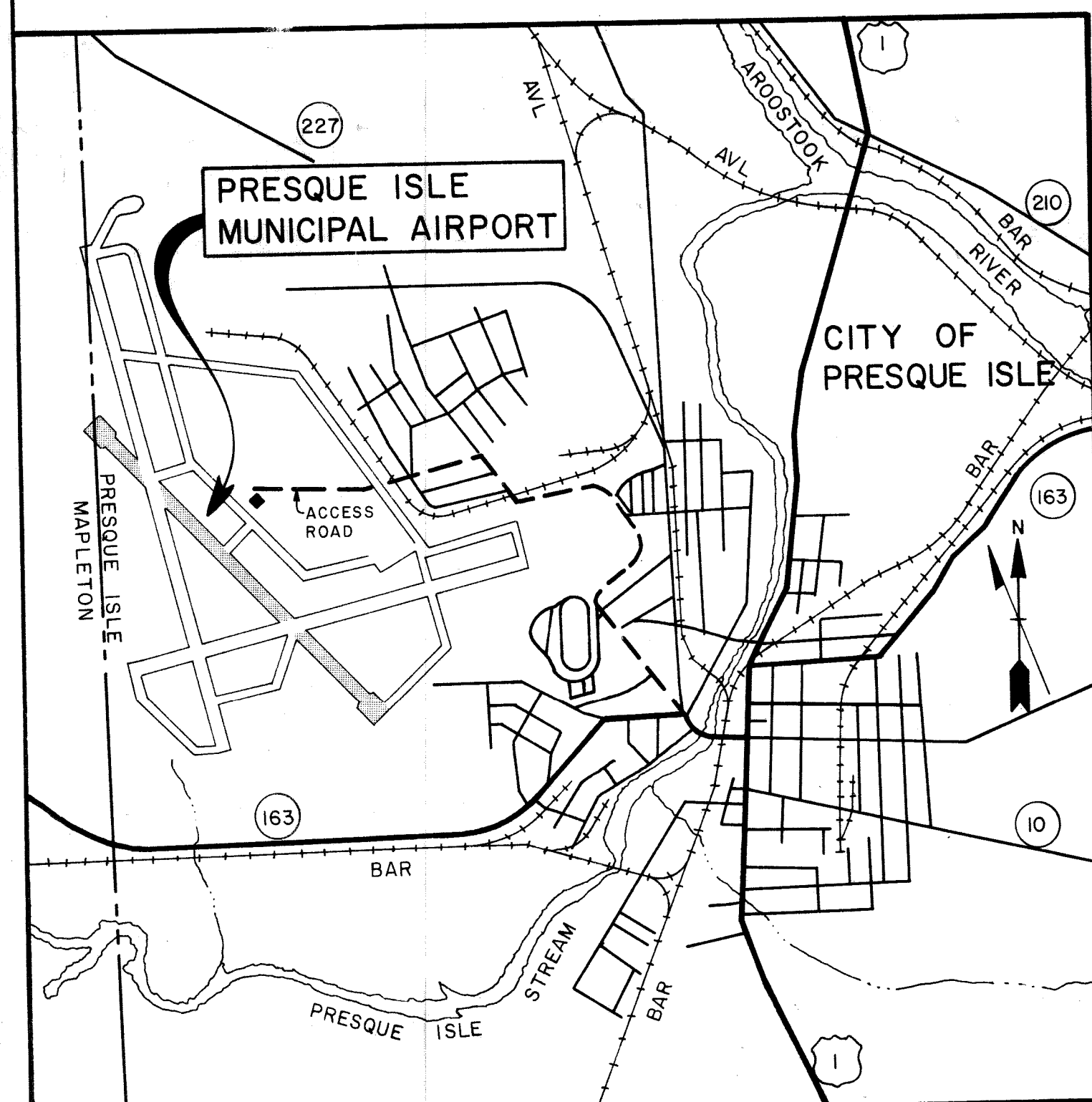
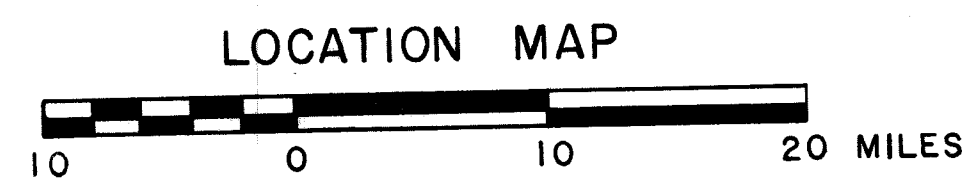
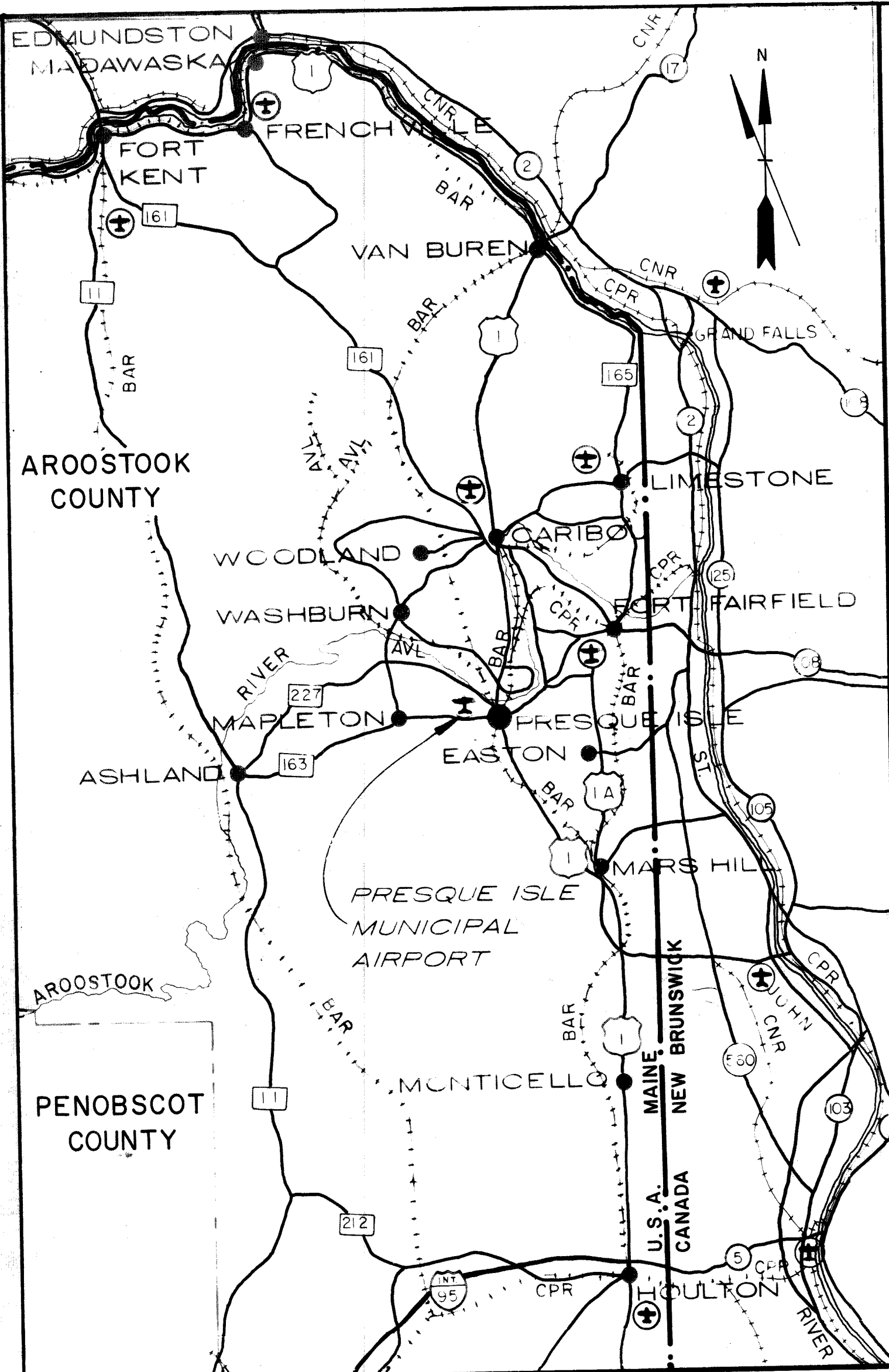

SPONSOR - CITY OF PRESQUE ISLE

SINCE THE COMPLETION OF THE AIRPORT MASTER PLAN STUDY, THE OFFICIAL NAME OF THE AIRPORT HAS BEEN CHANGED TO "NORTHERN MAINE REGIONAL AIRPORT AT PRESQUE ISLE."

INDEX

SHEET NO.	TITLE
1	-----COVER SHEET
2	-----AIRPORT ACCESS
3	-----EXISTING LAND USE ZONES
4	-----EXISTING AIRPORT LAYOUT AND FACILITIES
5	-----APPROACH CLEARANCES
6	-----AIRPORT LAYOUT PLAN
7	-----CONCEPTUAL LAYOUT OF FUTURE PASSENGER TERMINAL AREA
8	-----CONCEPTUAL LAYOUT OF FUTURE AIR CARGO TERMINAL AND EMERGENCY EQUIPMENT FACILITY AREA

APPROVALS

CITY OF PRESQUE ISLE, MAINE

Dana F. Connor
CITY MANAGER

Maxwell P. Bunk
AIRPORT MANAGER

U.S. DEPARTMENT OF TRANSPORTATION
FEDERAL AVIATION ADMINISTRATION

CHIEF AIRPORTS DIVISION
FAA APPROVAL IS NOTED ON SHEET 6

MAINE DEPARTMENT OF TRANSPORTATION

Robert J. Walsh

EDWARD C. JORDAN CO., INC.

E.C. Jordan
E.C. JORDAN, PRESIDENT

DATE

Sept 13, 1974

Sept 13, 1974

MAY 7 1976

APRIL 8, 1975

10 SEPT 74

APPROVED	DATE	BY	FOR
AIRPORT MASTER PLANS			
CITY OF PRESQUE ISLE, MAINE			
AS NOTED: 7109494			

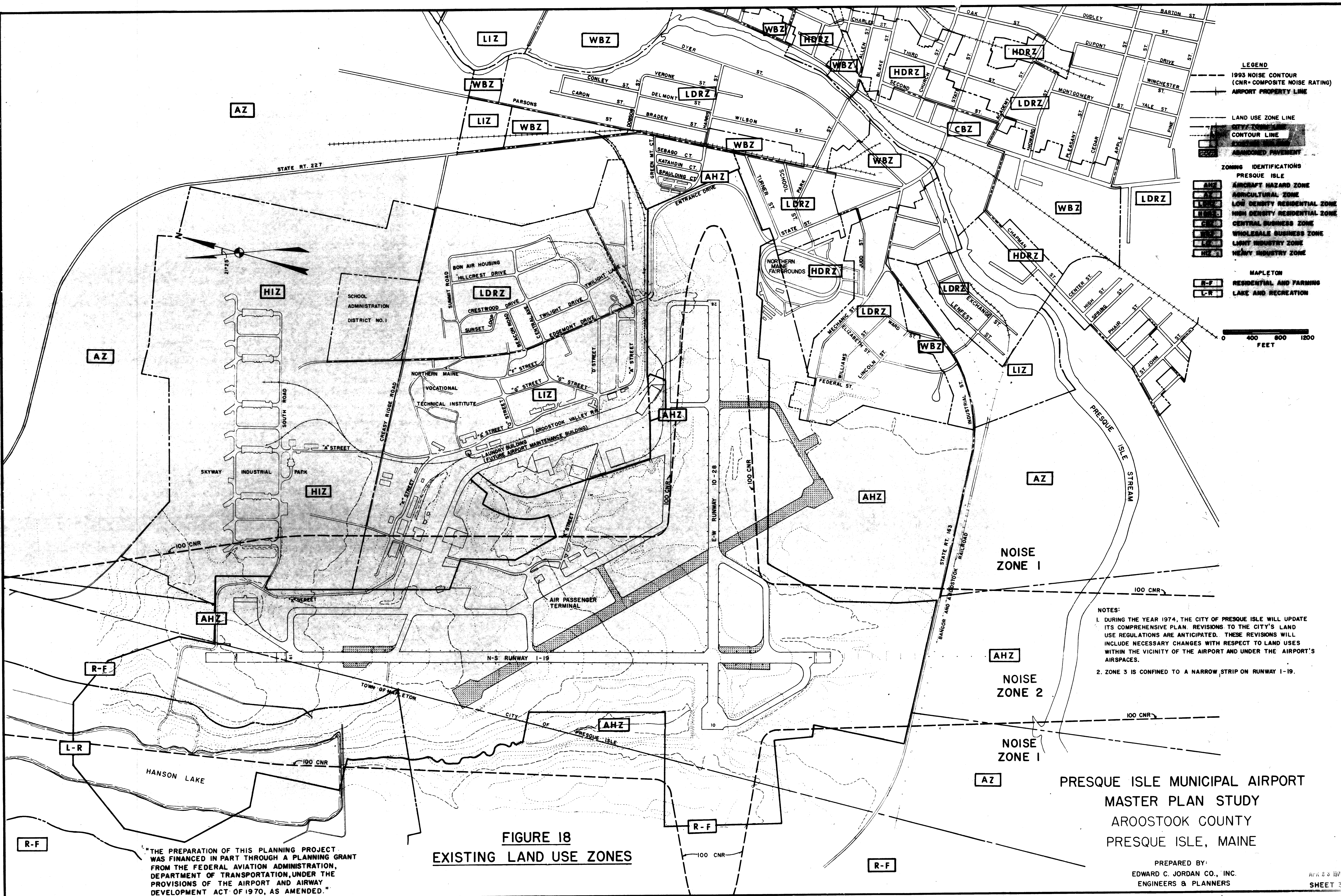

- LEGEND**
- 1993 NOISE CONTOUR (CNR=COMPOSITE NOISE RATING)
 - - - AIRPORT PROPERTY LINE
 - LAND USE ZONE LINE
 - CITY/TOWN BOUNDARY
 - CONTOUR LINE
 - ABANDONED PAVEMENT
- ZONING IDENTIFICATIONS**
- PRESQUE ISLE
 - AIRCRAFT HAZARD ZONE
 - AGRICULTURAL ZONE
 - LOW DENSITY RESIDENTIAL ZONE
 - HIGH DENSITY RESIDENTIAL ZONE
 - CENTRAL BUSINESS ZONE
 - WHOLESALE BUSINESS ZONE
 - LIGHT INDUSTRY ZONE
 - HEAVY INDUSTRY ZONE
- MAPLETON**
- R-F RESIDENTIAL AND FARMING
 - L-R LAKE AND RECREATION



- NOTES:**
1. DURING THE YEAR 1974, THE CITY OF PRESQUE ISLE WILL UPDATE ITS COMPREHENSIVE PLAN. REVISIONS TO THE CITY'S LAND USE REGULATIONS ARE ANTICIPATED. THESE REVISIONS WILL INCLUDE NECESSARY CHANGES WITH RESPECT TO LAND USES WITHIN THE VICINITY OF THE AIRPORT AND UNDER THE AIRPORT'S AIRSPACES.
 2. ZONE 3 IS CONFINED TO A NARROW STRIP ON RUNWAY 1-19.

FIGURE 18
EXISTING LAND USE ZONES

PRESQUE ISLE MUNICIPAL AIRPORT
MASTER PLAN STUDY
AROOSTOOK COUNTY
PRESQUE ISLE, MAINE

PREPARED BY:
EDWARD C. JORDAN CO., INC.
ENGINEERS & PLANNERS

"THE PREPARATION OF THIS PLANNING PROJECT WAS FINANCED IN PART THROUGH A PLANNING GRANT FROM THE FEDERAL AVIATION ADMINISTRATION, DEPARTMENT OF TRANSPORTATION, UNDER THE PROVISIONS OF THE AIRPORT AND AIRWAY DEVELOPMENT ACT OF 1970, AS AMENDED."

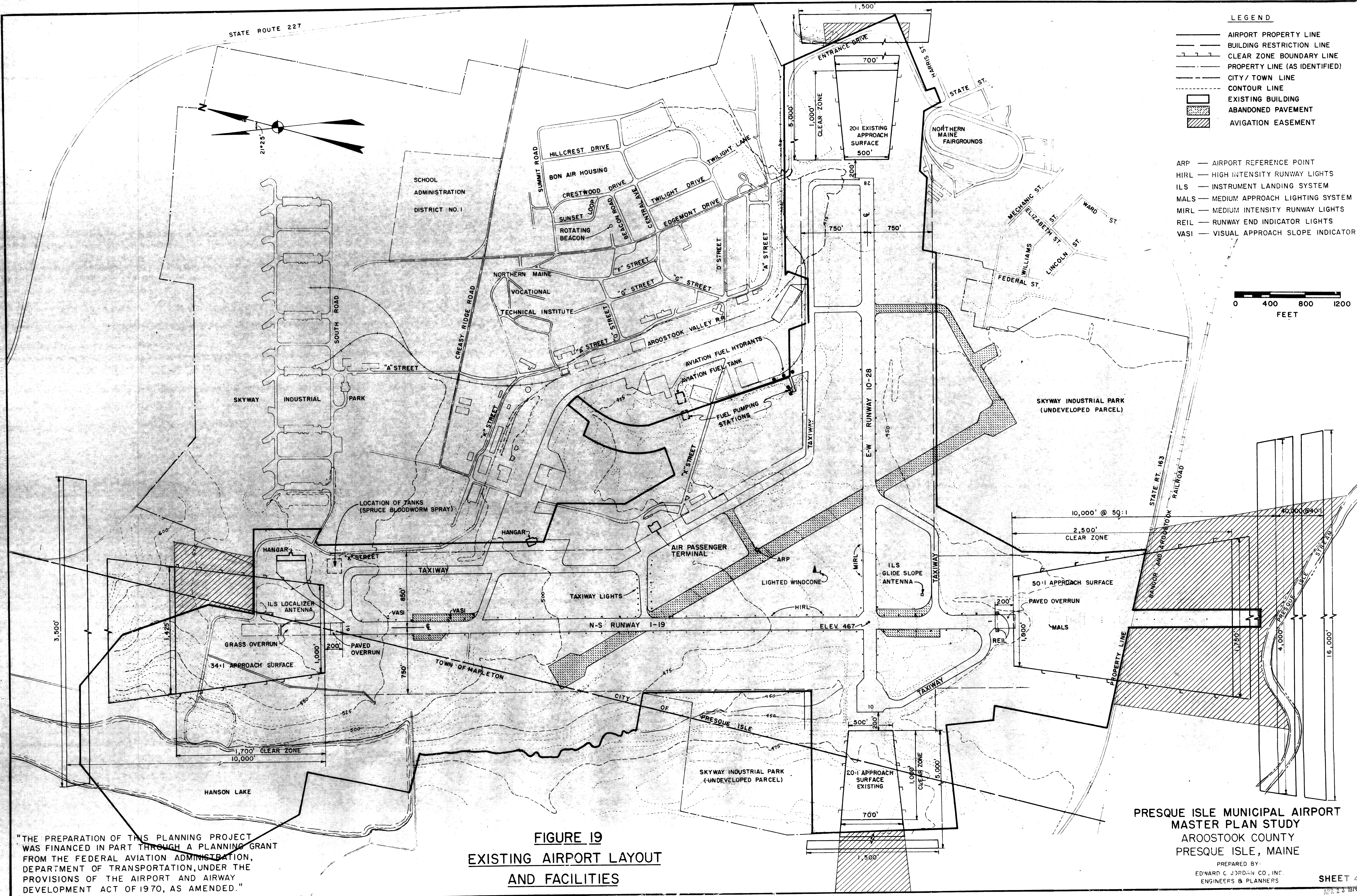

LEGEND

- AIRPORT PROPERTY LINE
- BUILDING RESTRICTION LINE
- CLEAR ZONE BOUNDARY LINE
- PROPERTY LINE (AS IDENTIFIED)
- CITY/TOWN LINE
- CONTOUR LINE
- ▭ EXISTING BUILDING
- ▨ ABANDONED PAVEMENT
- ▩ AVIGATION EASEMENT

- ARP — AIRPORT REFERENCE POINT
- HIRL — HIGH INTENSITY RUNWAY LIGHTS
- ILS — INSTRUMENT LANDING SYSTEM
- MALS — MEDIUM APPROACH LIGHTING SYSTEM
- MIRL — MEDIUM INTENSITY RUNWAY LIGHTS
- REIL — RUNWAY END INDICATOR LIGHTS
- VASI — VISUAL APPROACH SLOPE INDICATOR



FIGURE 19
EXISTING AIRPORT LAYOUT
AND FACILITIES

PRESQUE ISLE MUNICIPAL AIRPORT
MASTER PLAN STUDY
AROOSTOOK COUNTY
PRESQUE ISLE, MAINE

PREPARED BY:
 EDWARD C. JORDAN CO., INC.
 ENGINEERS & PLANNERS

"THE PREPARATION OF THIS PLANNING PROJECT WAS FINANCED IN PART THROUGH A PLANNING GRANT FROM THE FEDERAL AVIATION ADMINISTRATION, DEPARTMENT OF TRANSPORTATION, UNDER THE PROVISIONS OF THE AIRPORT AND AIRWAY DEVELOPMENT ACT OF 1970, AS AMENDED."

"THE PREPARATION OF THIS PLANNING PROJECT WAS FINANCED IN PART THROUGH A PLANNING GRANT FROM THE FEDERAL AVIATION ADMINISTRATION, DEPARTMENT OF TRANSPORTATION, UNDER THE PROVISIONS OF THE AIRPORT AND AIRWAY DEVELOPMENT ACT OF 1970, AS AMENDED."

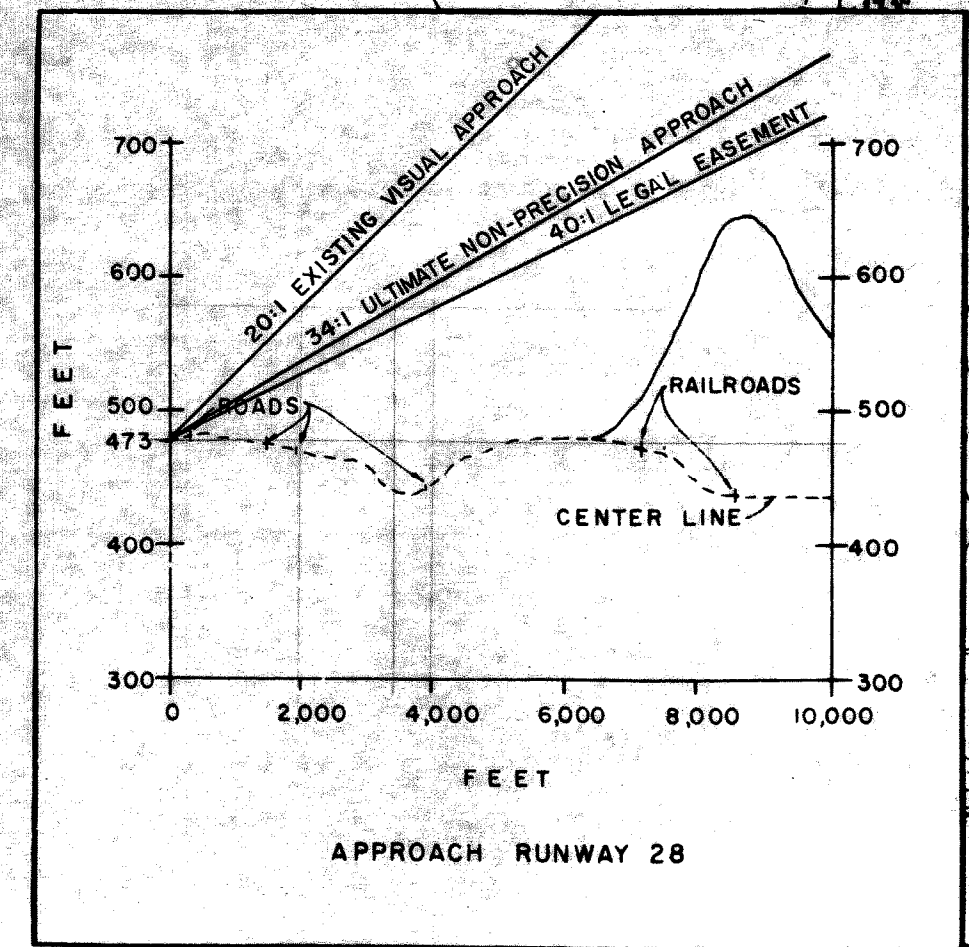
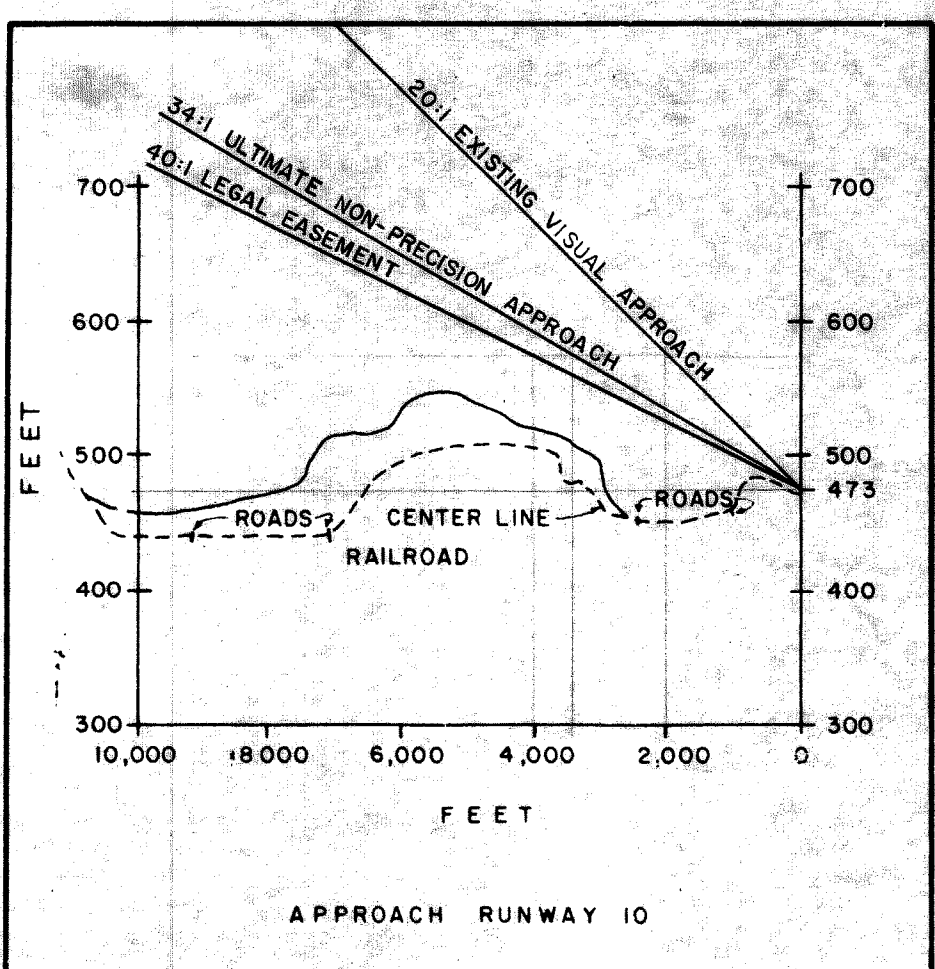
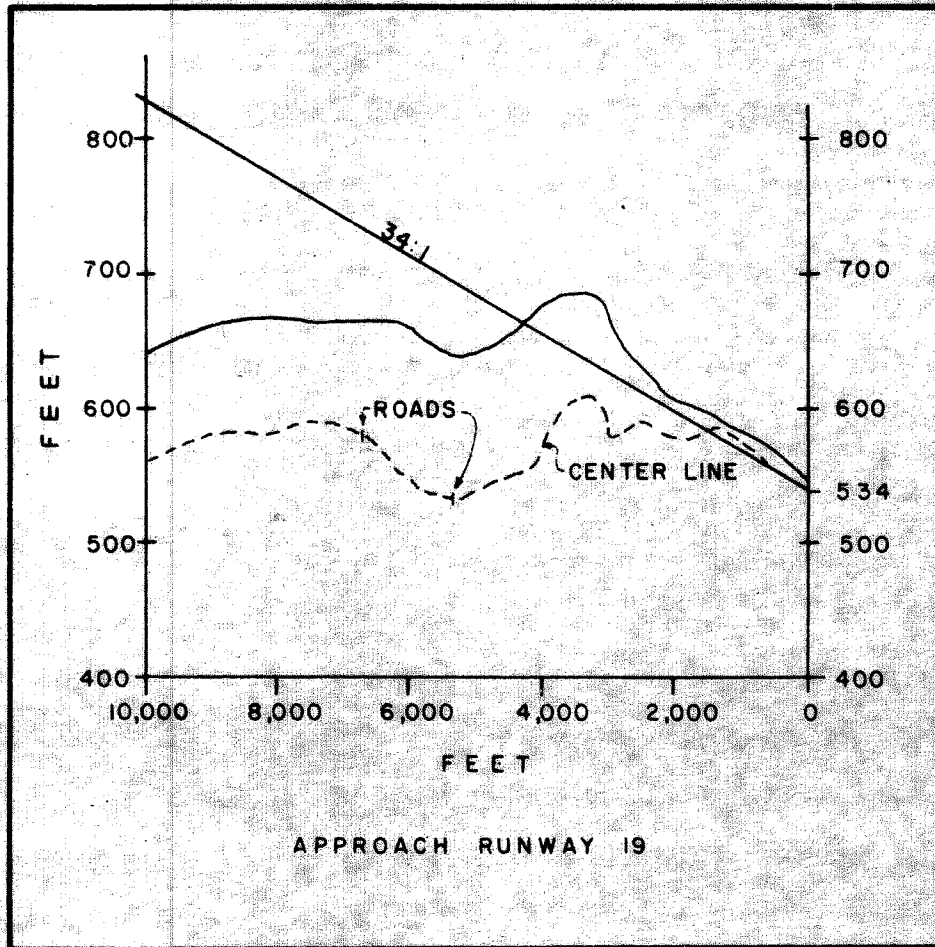
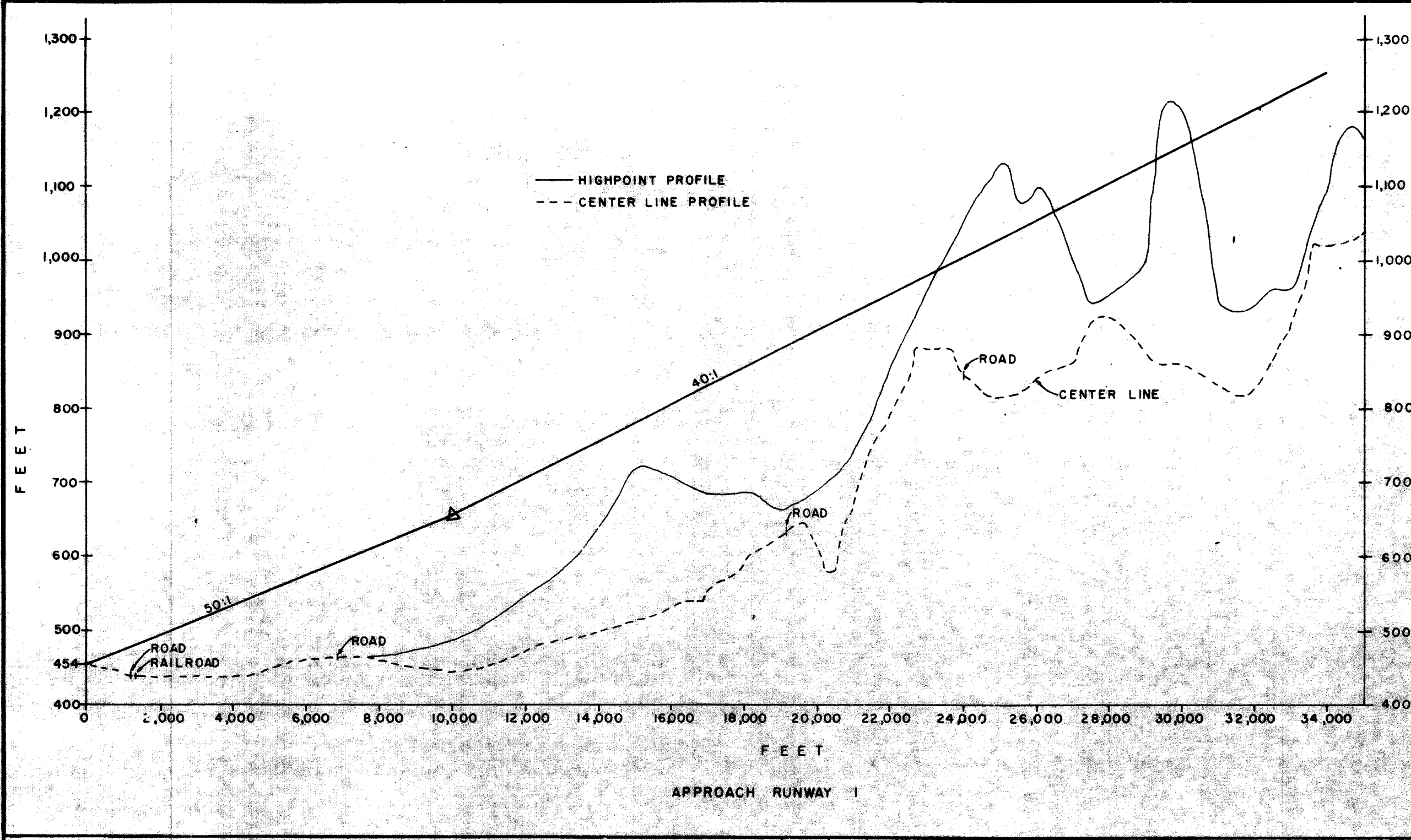
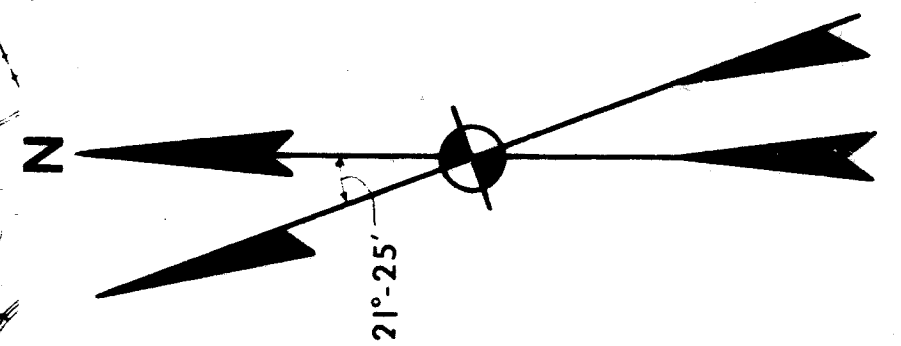
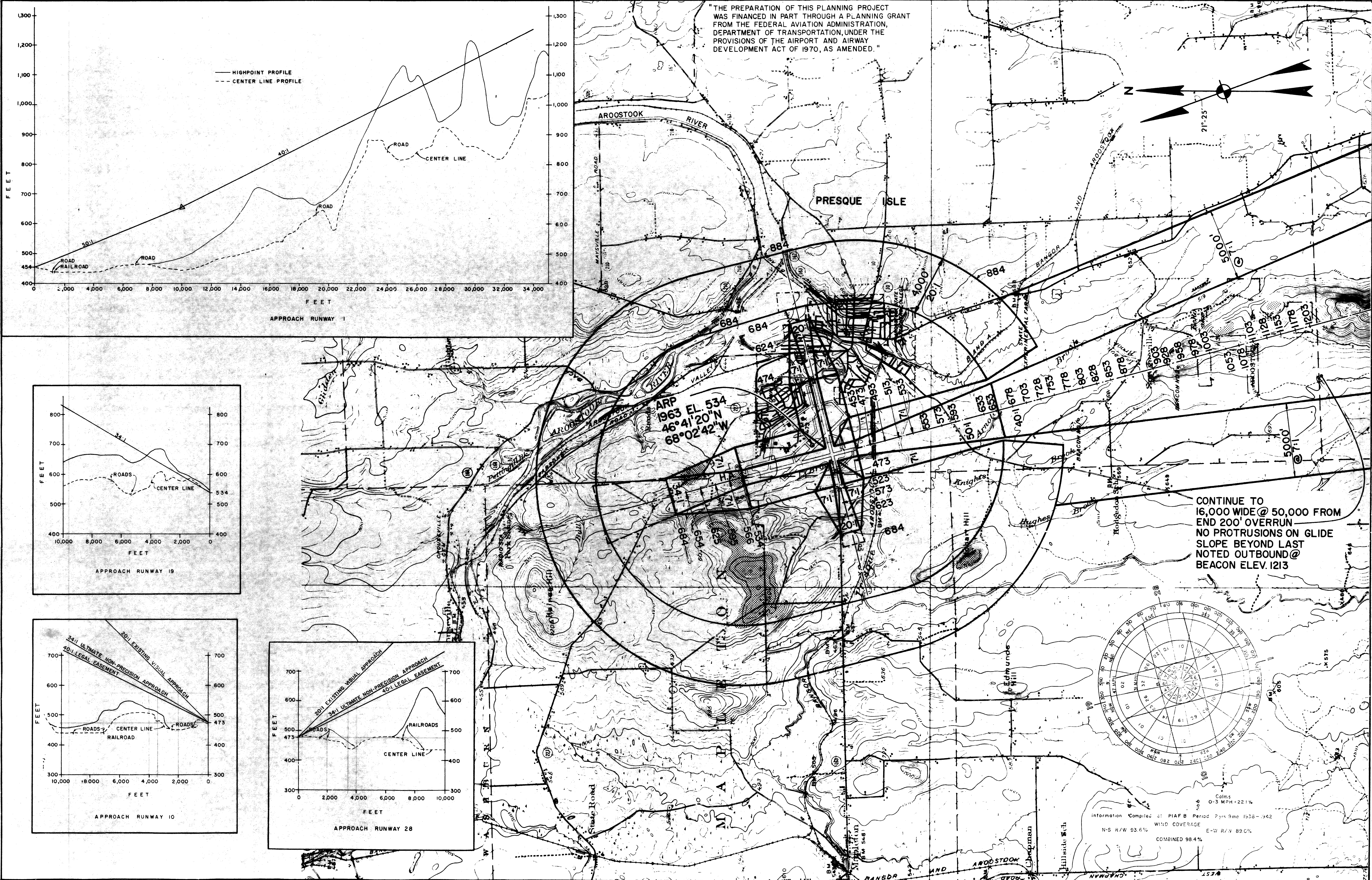

CONTINUE TO 16,000 WIDE @ 50,000 FROM END 200' OVERRUN NO PROTRUSIONS ON GLIDE SLOPE BEYOND LAST NOTED OUTBOUND @ BEACON ELEV. 1213

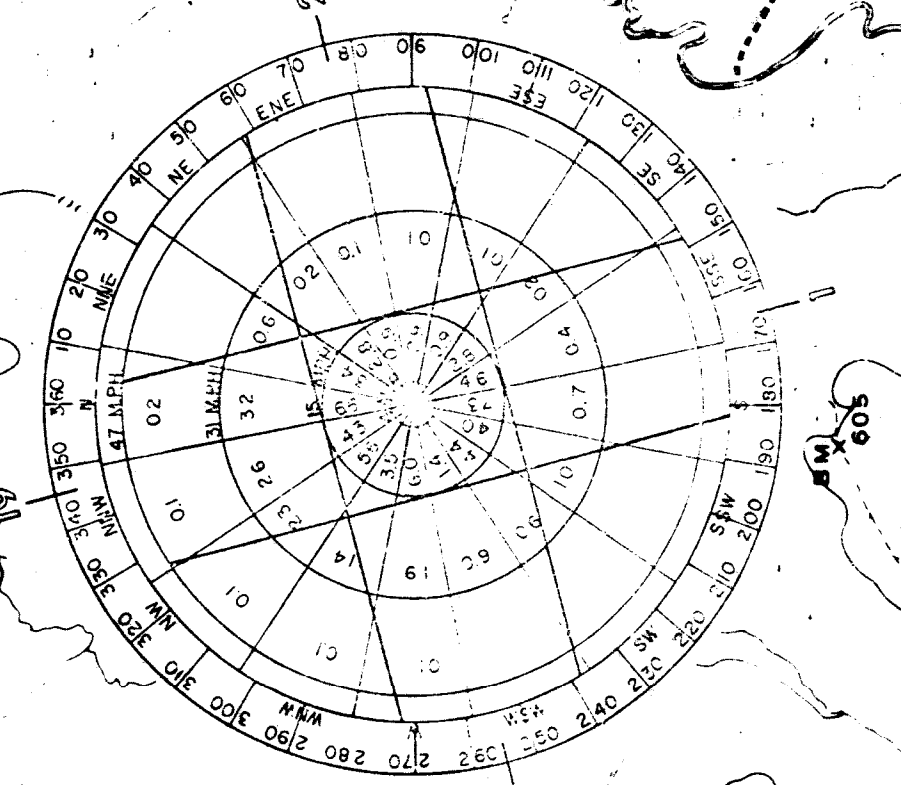

PREPARED BY:
EDWARD C. JORDAN CO., INC.
ENGINEERS & PLANNERS

LEGEND
 GROUND OBSTRUCTION

SCALE
 2000 0 2000 6000
 FEET

FIGURE 20
 APPROACH CLEARANCES

PRESQUE ISLE MUNICIPAL AIRPORT
 MASTER PLAN STUDY
 AROOSTOOK COUNTY
 PRESQUE ISLE, MAINE

RUNWAY DATA TABLE				
	RUNWAY 1-19		RUNWAY 10-28	
	EXISTING	ULTIMATE	EXISTING	ULTIMATE
EFFECTIVE GRADIENT (IN %)	1.07	SAME	0.35	SAME
% WIND COVERAGE (15 MPH)	93.60	SAME	89.00	SAME
INSTRUMENT RUNWAY	✓	✓		
PAVEMENT STRENGTH *	85S, 108D, 167DT	145S, 170D, 275DT	57S, 70D, 105DT	SAME
APPROACH SURFACES	50:1, 34:1	SAME	20:1	SAME
RUNWAY LIGHTING	HIRL	SAME	MIRL	SAME
RUNWAY MARKING	PREC. INSTR.	SAME	BASIC	SAME
NAVIGATIONAL AIDS	VOR-DME, ILS, VASI, MALS	SAME & BACK COURSE MARKER	NONE	VASI

* RUNWAY STRENGTHS ARE STATED AS GIVEN IN THE "AIRPORT MASTER RECORD" FOR THE PRESQUE ISLE MUNICIPAL AIRPORT (DATED 6/29/72). IT IS NOTED THAT THESE STRENGTHS HAVE RECENTLY BEEN SUBJECT TO SOME QUESTION AND WILL HAVE TO BE INVESTIGATED PRIOR TO FUTURE RUNWAY CONSTRUCTION WORK.

AIRPORT DATA TABLE		
	EXISTING	ULTIMATE
AIRPORT ELEVATION	534'	SAME
AIRPORT REFERENCE POINT COORDINATES	LAT. 46° 41' 20" LWG. 68° 02' 43"	SAME
MEAN MAXIMUM TEMPERATURE OF HOTTEST MONTH	78°	SAME
AIRPORT AND TERMINAL NAVIGATIONAL AIDS	VOR-DME, ILS, VASI, MALS	SAME & BACK COURSE MARKER & CONTROL TOWER
MISCELLANEOUS FACILITIES	RUNWAY MARKINGS	SAME & TAXIWAY LIGHTS, SIGNS & MARKINGS

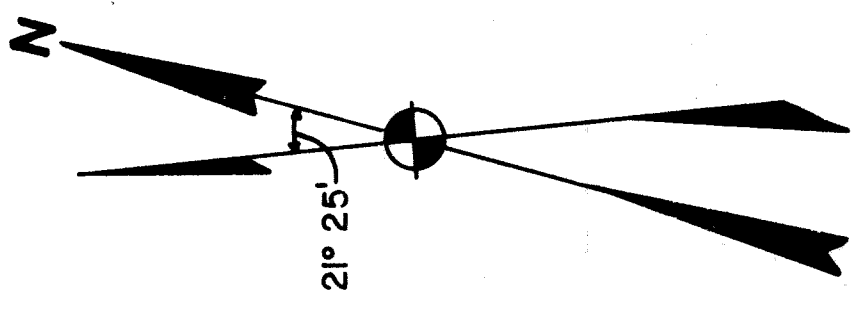

THE APPROVAL INDICATED BY MY SIGNATURE IS GIVEN SUBJECT TO THE CONDITION, TO WHICH THE SPONSOR OF THE AIRPORT AGREES BY HIS ACCEPTANCE OF THE STATEMENT OF APPROVAL, THAT (1) ANY PROPOSED AIRPORT DEVELOPMENT DEPICTED IN THE PLAN MAY NOT BE TAKEN WITHOUT THE PRIOR WRITTEN APPROVAL OF FAA, AND THAT (2) THE PRIOR WRITTEN APPROVAL WILL BE DEEMED TO BE A FEDERAL ACTION SUBJECT TO THE REQUIREMENTS OF THE NATIONAL ENVIRONMENTAL POLICY ACT OF 1969.

APPROVED: *[Signature]* 5/1/76
CHIEF AIRPORTS PLANNING BRANCH DATE

ACCEPTED: *[Signature]* April 21, 76
CITY MANAGER DATE

LEGEND

- AIRPORT PROPERTY LINE
- BUILDING RESTRICTION LINE
- CLEAR ZONE BOUNDARY LINE
- PRINCIPAL LINE (AS IDENTIFIED)
- CITY/TOWN LINE
- CONTOUR LINE
- EXISTING BUILDING
- ▒ FUTURE BUILDING
- ▓ PRINCIPAL IMPROVEMENT AREAS
- ▔ ABANDONED PAVEMENT
- ▕ AVIGATION EASEMENT
- ▖ FUTURE CONSTRUCTION

NOTE:

- LIGHTING TO BE INSTALLED ON ALL TAXIWAYS
- AIRCRAFT HOLDING LINES TO BE PLACED ON ALL TAXIWAYS

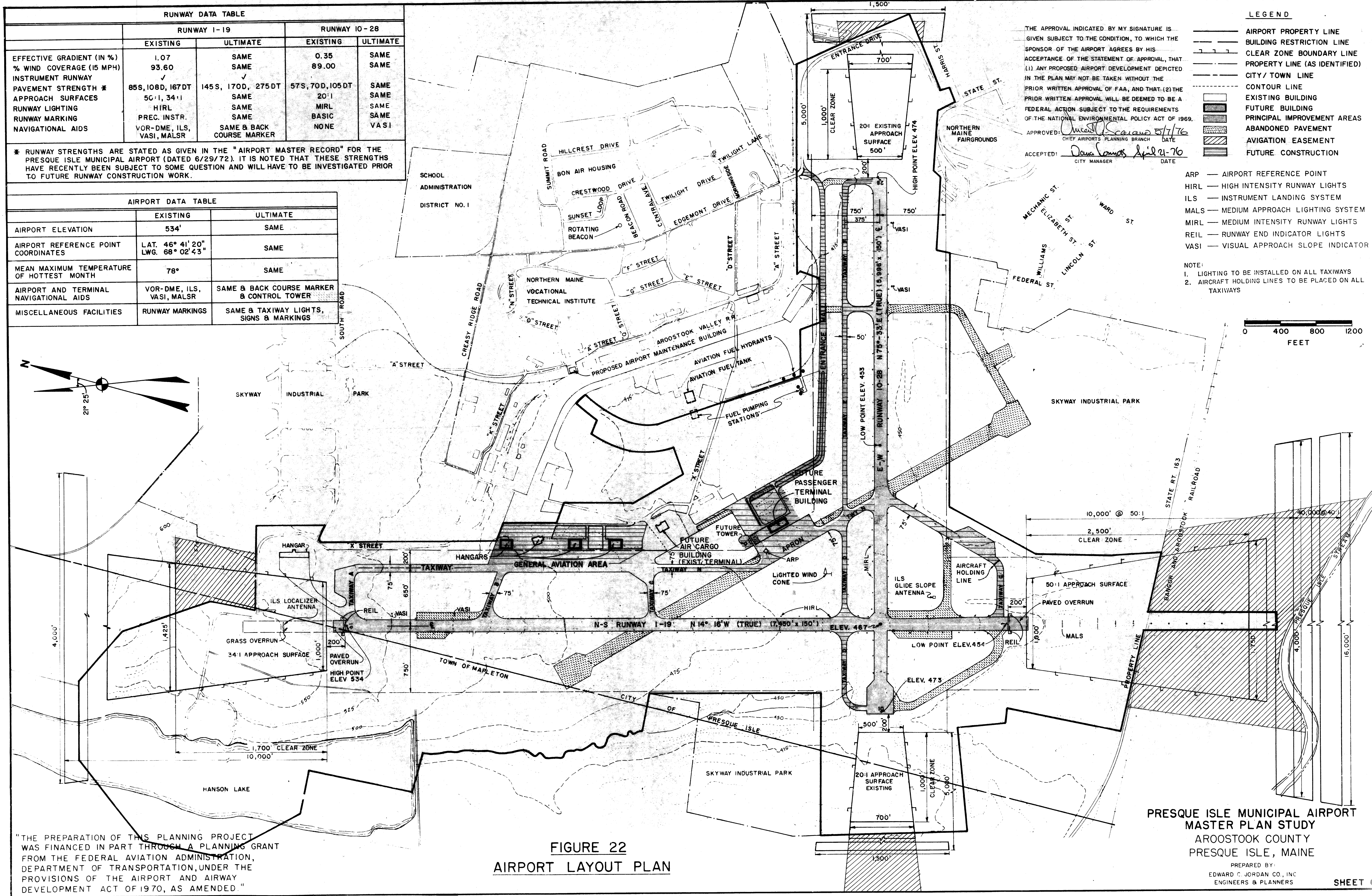
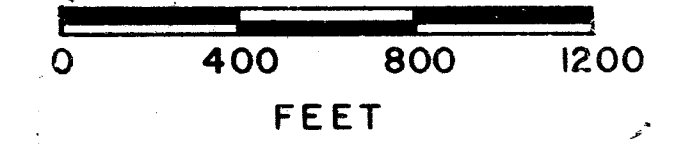

FIGURE 22
AIRPORT LAYOUT PLAN

PRESQUE ISLE MUNICIPAL AIRPORT
MASTER PLAN STUDY
AROOSTOOK COUNTY
PRESQUE ISLE, MAINE

PREPARED BY:
EDWARD C. JORDAN CO., INC.
ENGINEERS & PLANNERS

SHEET 6

"THE PREPARATION OF THIS PLANNING PROJECT WAS FINANCED IN PART THROUGH A PLANNING GRANT FROM THE FEDERAL AVIATION ADMINISTRATION, DEPARTMENT OF TRANSPORTATION, UNDER THE PROVISIONS OF THE AIRPORT AND AIRWAY DEVELOPMENT ACT OF 1970, AS AMENDED."

