

**REDINGTON PARCEL TO FLAGSTAFF LAKE**

Color	Range Beg.	Range End	Percent	Area
Orange	0.00	8.00	7.0	17.9 Acres
Yellow	8.00	15.00	20.7	52.3 Acres
Light Green	15.00	20.00	22.2	56.5 Acres
Green	20.00	25.00	18.0	45.7 Acres
Pink	25.00	30.00	13.5	34.3 Acres
Red	30.00	33.00	8.6	21.9 Acres
Purple	33.00	>33.00	10.0	25.4 Acres
<b>TOTAL</b>			<b>100.0</b>	<b>254 Acres</b>

**LEGEND**

- DRAINAGE DIVIDE
- PROPERTY LINE
- BUFFER LIMITS
- WIND TURBINE LOCATION

NOTE: BUFFER LIMITS ARE DESIGNATED BY DASHED AREAS

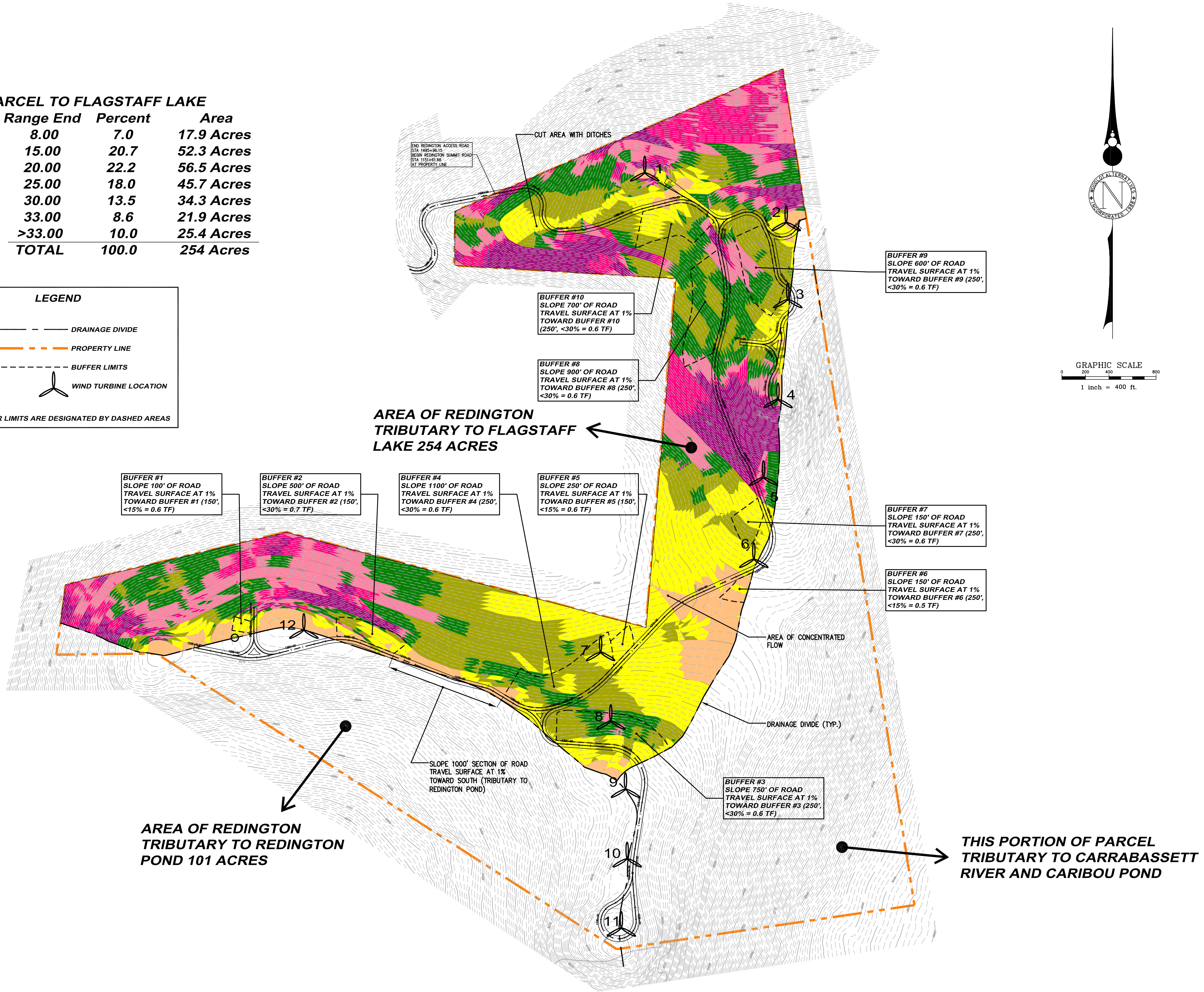

<b>REDINGTON PARCEL WATER QUALITY BUFFER AREAS</b>		<b>DRAWN:</b> LECJ	<b>DATE:</b> DEC. 2005
		<b>DESIGNED:</b> DDA	<b>SCALE:</b> 1"=400'
		<b>CHECKED:</b> WGH	<b>JOB NO.:</b> 1708.06
		<b>FILE NAME:</b> 1708.06-WATER QUALITY	
<b>REDINGTON WIND FARM PROJECT REDINGTON MOUNTAIN WINDPOWER, LLC</b>		<b>DeLuca-Hoffman Associates, Inc.</b> 778 MAIN STREET, SUITE 8 SOUTH PORTLAND, ME 04106 207.775.1121 WWW.DELUCAHOFFMAN.COM	
<b>FIGURE</b>		<b>B-1</b>	
		<b>NO.:</b> 1	<b>DATE:</b> 12.15.05
		<b>REVISIONS:</b>	<b>ISSUED TO CLIENT FOR REVIEW</b>



**BLACK NUBBLE PARCEL TO FLAGSTAFF LAKE**

Color	Range Beg.	Range End	Percent	Area
Orange	0.00	8.00	5.4	21.5 Acres
Yellow	8.00	15.00	13.6	54.3 Acres
Light Green	15.00	20.00	14.7	59.1 Acres
Green	20.00	25.00	15.7	62.8 Acres
Light Purple	25.00	30.00	12.6	50.4 Acres
Pink	30.00	33.00	6.5	25.8 Acres
Dark Purple	33.00	>33.00	31.5	125.8 Acres
<b>TOTAL</b>			<b>100.0</b>	<b>399.7 Acres</b>

**LEGEND**

- DRAINAGE DIVIDE
- - - - - PROPERTY LINE
- - - - - BUFFER LIMITS
- ⊙ WIND TURBINE LOCATION

NOTE: BUFFER LIMITS ARE DESIGNATED BY DASHED AREAS

GRAPHIC SCALE  
0 200 400 800  
1 inch = 400 ft.

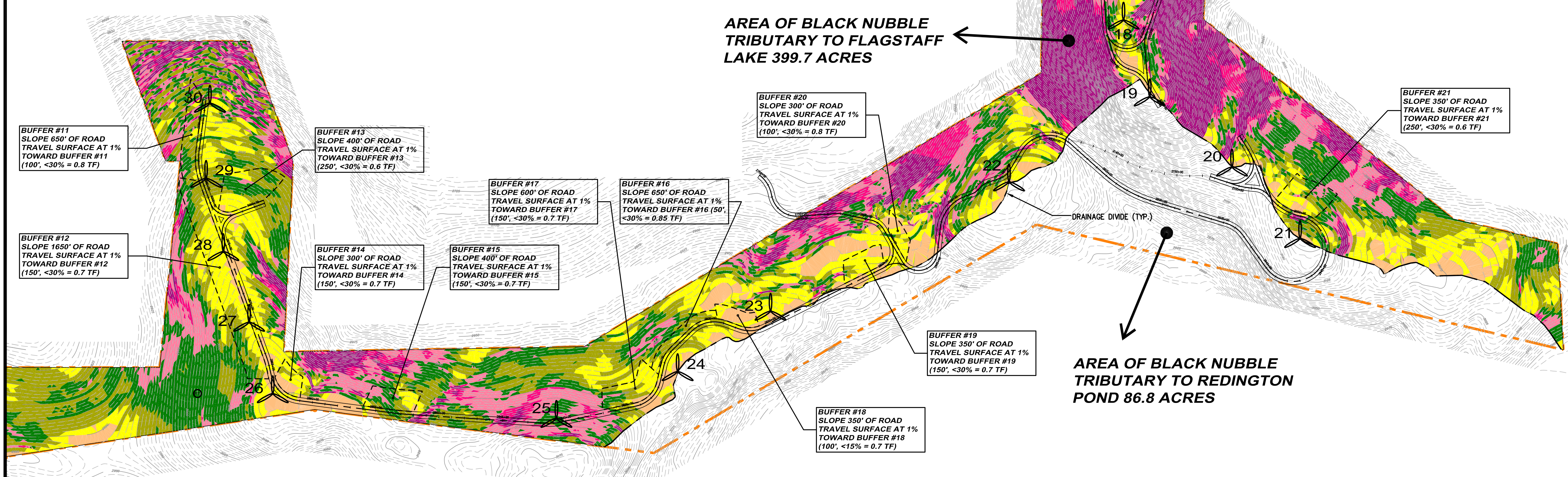

AREA OF BLACK NUBBLE TRIBUTARY TO FLAGSTAFF LAKE 399.7 ACRES

AREA OF BLACK NUBBLE TRIBUTARY TO REDINGTON POND 86.8 ACRES

BUFFER #22  
SLOPE 700' OF ROAD TRAVEL SURFACE AT 1% TOWARD BUFFER #22 (50', <30% = 0.85 TF)

BUFFER #21  
SLOPE 350' OF ROAD TRAVEL SURFACE AT 1% TOWARD BUFFER #21 (250', <30% = 0.6 TF)

BUFFER #20  
SLOPE 300' OF ROAD TRAVEL SURFACE AT 1% TOWARD BUFFER #20 (100', <30% = 0.8 TF)

BUFFER #16  
SLOPE 650' OF ROAD TRAVEL SURFACE AT 1% TOWARD BUFFER #16 (50', <30% = 0.85 TF)

BUFFER #17  
SLOPE 600' OF ROAD TRAVEL SURFACE AT 1% TOWARD BUFFER #17 (150', <30% = 0.7 TF)

BUFFER #15  
SLOPE 400' OF ROAD TRAVEL SURFACE AT 1% TOWARD BUFFER #15 (150', <30% = 0.7 TF)

BUFFER #14  
SLOPE 300' OF ROAD TRAVEL SURFACE AT 1% TOWARD BUFFER #14 (150', <30% = 0.7 TF)

BUFFER #13  
SLOPE 400' OF ROAD TRAVEL SURFACE AT 1% TOWARD BUFFER #13 (250', <30% = 0.6 TF)

BUFFER #11  
SLOPE 650' OF ROAD TRAVEL SURFACE AT 1% TOWARD BUFFER #11 (100', <30% = 0.8 TF)

BUFFER #12  
SLOPE 1650' OF ROAD TRAVEL SURFACE AT 1% TOWARD BUFFER #12 (150', <30% = 0.7 TF)

BUFFER #19  
SLOPE 350' OF ROAD TRAVEL SURFACE AT 1% TOWARD BUFFER #19 (150', <30% = 0.7 TF)

BUFFER #18  
SLOPE 350' OF ROAD TRAVEL SURFACE AT 1% TOWARD BUFFER #18 (100', <15% = 0.7 TF)

**BLACK NUBBLE PARCEL WATER QUALITY BUFFER AREAS**

**REDINGTON WIND FARM PROJECT  
REDINGTON MOUNTAIN WINDPOWER, LLC**

DeLuca-Hoffman Associates, Inc.  
778 MAIN STREET, SUITE 8  
SOUTH PORTLAND, ME 04106  
207.775.1121  
WWW.DELUCAHOFFMAN.COM

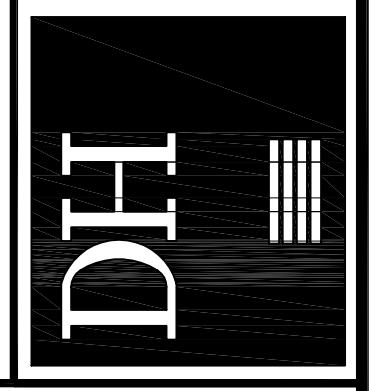

FIGURE

**B-2**

DRAWN:	LECJ	DATE:	DEC. 2005
DESIGNED:	DDA	SCALE:	1"=400'
CHECKED:	WGH	JOB NO.:	1708.06
FILE NAME:	1708.06-WATER QUALITY		

NO.	DATE	REVISIONS
1	12.15.05	ISSUED TO CLIENT FOR REVIEW