

Emergency Traffic Alert

I-295 Northbound Closure

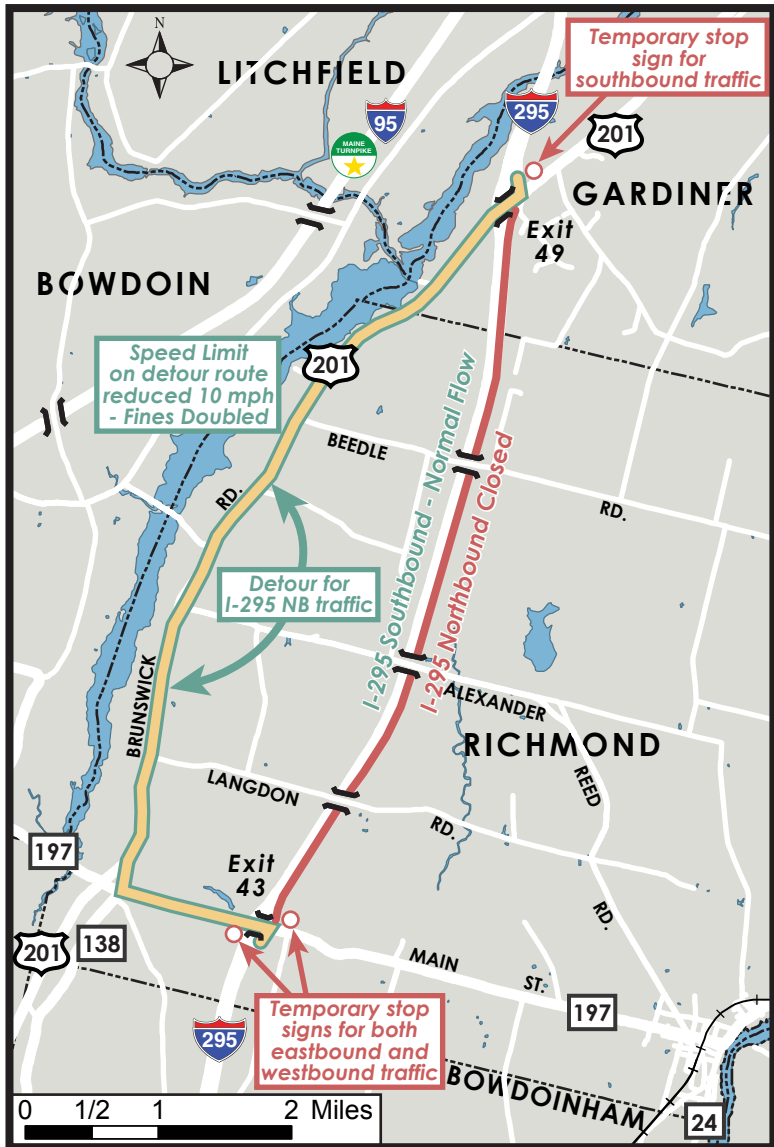

Due to the failure of a culvert under the northbound lanes of I-295 in Richmond, MaineDOT is temporarily closing a section of I-295 beginning at noon on Sunday, June 7th and reopening by the morning commute on Wednesday, June 10th. Northbound motorists will exit I-295 at Richmond Exit 43 and will be detoured along Routes 197, 138 and 201, then back onto I-295 in Gardiner at Exit 49. This detour should add no more than 15 minutes of travel time. **Motorists in passenger cars going north from the Portland area are encouraged to use the Maine Turnpike.**

The speed limits on I-295 in Richmond will drop 15-25 miles per hour as traffic is channeled down to one lane as motorists approach Exit 43 for the detour. **Speed limits on the detour route are being reduced 10 mph and fines will be doubled.** It is anticipated that there will be an increased police presence to ensure motorists obey the temporary speed limits along the rural, residential detour.

MaineDOT is initiating this northbound closure out of an abundance of caution for the safety of motorists and work crews. The closure also expedites the work and thereby minimizes inconvenience for the traveling public.

We appreciate the public's patience as we deal with this unexpected situation and ask that motorists drive safely and courteously throughout the detour.

Construction is weather-dependent, so schedules are subject to change.



mainedot.gov

MaineDOT