



**Bernstein, Shur,
Sawyer & Nelson, P.A.**
100 Middle Street
PO Box 9729
Portland, ME 04104-5029

T (207) 774 - 1200
F (207) 774 - 1127

Katherine Joyce
207-228-7297
kjoyce@bernsteinshur.com

VIA FEDERAL EXPRESS

July 11, 2024

Laura Paye
Maine Department of Environmental Protection
Bureau of Land Resources
312 Canco Road
Portland, Maine 04103

Re: Petition for Release from Dam Ownership

Dear Ms. Paye:

Please find enclosed a consolidated Petition for Release from Dam Ownership related to Bucksport Mill, LLC's ownership of impoundments at Alamoosook Lake, Silver Lake and Toddy Pond. Note that we have separately sent a copy to the Augusta office to be available for public inspection as described in the Public Notice.

We look forward to further discussion regarding the disposition of these facilities.

Sincerely,

A handwritten signature in black ink, appearing to read "Katherine Joyce".

Katherine Joyce

Enclosures

cc: Department of Environmental Protection, Augusta, ME (Via Regular U.S. Mail)

DEPARTMENT OF ENVIRONMENTAL PROTECTION
Bureau of Land Resources
17 State House Station
Augusta, ME 04333
Telephone: (207) 287-7688

FOR DEP USE

#L-
Date Received:

**PETITION FOR RELEASE FROM DAM OWNERSHIP
AND WATER LEVEL MAINTENANCE**

The undersigned hereby petitions the Department of Environmental Protection for release from dam ownership or water level maintenance for the dam described below.

DAM INFORMATION

Address (use "911 address", if available): 31 Soper Road identified as Tax Map 36, Lot 34 & Tax Map 26, Lots 9 & 10, Alamoosook Lake

GPS Coordinates, if known: _____

Name of Impounded Water Body: Alamoosook Lake

DAM OWNER INFORMATION

Name of Owner: AIM Demolition USA LLC

Mailing Address: PO BOX 1874, Bucksport, ME 04416

Name of Agent or Contact: David Bryant, Project Manager

Telephone: 630-986-1972 (Office); 630-399-0578 (Mobile)

CERTIFICATION OF FILING

The undersigned hereby represents and avers that he/she or the organization represented is the owner of the dam described above.

By signing below, the petitioner or authorized agent certifies that this petition and all accompanying materials are complete and accurate to the best of his/her knowledge, and further certifies that he/she has complied with the public notice requirements of 38 MRSA § 901(2) & (3).

DATE: July 11, 2024



SIGNATURE OF PETITIONER
David Bryant
Project Manager

DEPARTMENT OF ENVIRONMENTAL PROTECTION
Bureau of Land Resources
17 State House Station
Augusta, ME 04333
Telephone: (207) 287-7688

FOR DEP USE

#L-
Date Received:

**PETITION FOR RELEASE FROM DAM OWNERSHIP
AND WATER LEVEL MAINTENANCE**

The undersigned hereby petitions the Department of Environmental Protection for release from dam ownership or water level maintenance for the dam described below.

DAM INFORMATION

Address (use "911 address", if available): off Central Street identified as Tax Map 1 Lot 82

GPS Coordinates, if known: _____

Name of Impounded Water Body: Silver Lake

DAM OWNER INFORMATION

Name of Owner: Bucksport Mill, LLC

Mailing Address: 30 Generation Lane, Bucksport, ME 04416

Name of Agent or Contact: David Bryant, Project Manager

Telephone: 630-986-1972 (Office); 630-399-0578 (Mobile)

CERTIFICATION OF FILING

The undersigned hereby represents and avers that he/she or the organization represented is the owner of the dam described above.

By signing below, the petitioner or authorized agent certifies that this petition and all accompanying materials are complete and accurate to the best of his/her knowledge, and further certifies that he/she has complied with the public notice requirements of 38 MRSA § 901(2) & (3).

DATE: July 11, 2024



SIGNATURE OF PETITIONER

David Bryant

Project Manager

DEPARTMENT OF ENVIRONMENTAL PROTECTION FOR DEP USE
Bureau of Land Resources
17 State House Station
Augusta, ME 04333
Telephone: (207) 287-7688

#L-
Date Received:

**PETITION FOR RELEASE FROM DAM OWNERSHIP
AND WATER LEVEL MAINTENANCE**

The undersigned hereby petitions the Department of Environmental Protection for release from dam ownership or water level maintenance for the dam described below.

DAM INFORMATION

Address (use "911 address", if available): Toddy Dam Road identified as Tax Map 039 Lot 2

GPS Coordinates, if known: _____

Name of Impounded Water Body: Toddy Pond

DAM OWNER INFORMATION

Name of Owner: AIM Demolition USA LLC

Mailing Address: PO BOX 1874, Bucksport, ME 04416

Name of Agent or Contact: David Bryant, Project Manager

Telephone: 630-986-1972 (Office); 630-399-0578 (Mobile)

CERTIFICATION OF FILING

The undersigned hereby represents and avers that he/she or the organization represented is the owner of the dam described above.

By signing below, the petitioner or authorized agent certifies that this petition and all accompanying materials are complete and accurate to the best of his/her knowledge, and further certifies that he/she has complied with the public notice requirements of 38 MRSA § 901(2) & (3).

DATE: July 11, 2024



SIGNATURE OF PETITIONER



Project Manager

LIST OF AFFECTED TOWNS/COUNTIES/TRIBES.

A. Alamoosook Lake

- A. The dam or the impoundment is located in Town of Orland;
- B. The dam or the impoundment is located in Hancock County; and
- C. Any Indian tribe or nation in whose territory(ies) the dam or the impoundment created by the dam are located: None

B. Silver Lake

- A. The dam or the impoundment is located in Town of Bucksport;
- B. The dam or the impoundment is located in Hancock County; and
- C. Any Indian tribe or nation in whose territory(ies) the dam or the impoundment created by the dam are located: None

C. Toddy Pond

- A. The dam or the impoundment is located in Town of Orland;
- B. The dam or the impoundment is located Hancock County; and
- C. Any Indian tribe or nation in whose territory(ies) the dam or the impoundment created by the dam are located: None

PLANS OF DAMS

A plan of each dam, to scale, showing the design and dimensions of the dam is located on the subsequent pages. The plan includes any gates, embankments, or other structures that are part of the dam or are necessary for the maintenance and operation of the dam.

P:\ME11299-AMM_DEVELOPMENT\02-RIVER RD BUCKSPORT EAP_UPDATES 3 DAMS-DBK02-CAD_DRAWINGS\CIVIL\11299.023_ALAMOOSOOK LAKE - FIGURE 2.DWG

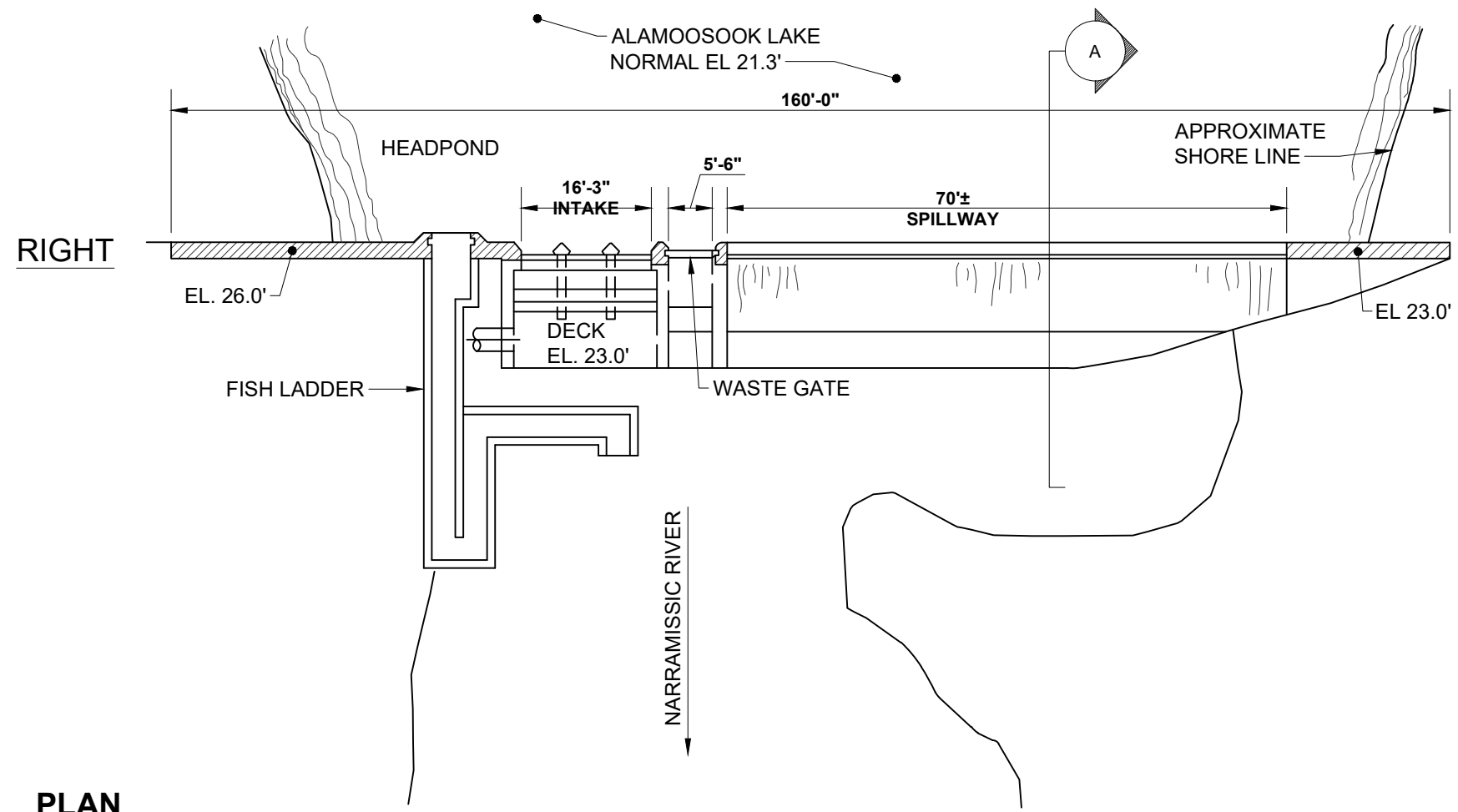

PLAN
SCALE: 1"=20'-0"

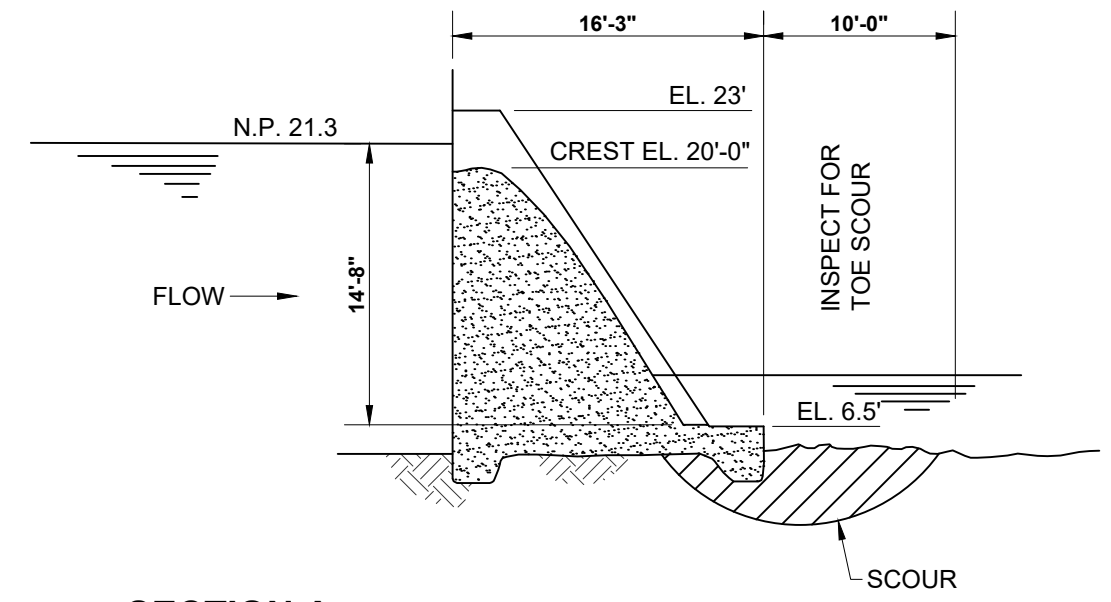

SECTION A
SCALE: 1"=10'-0"

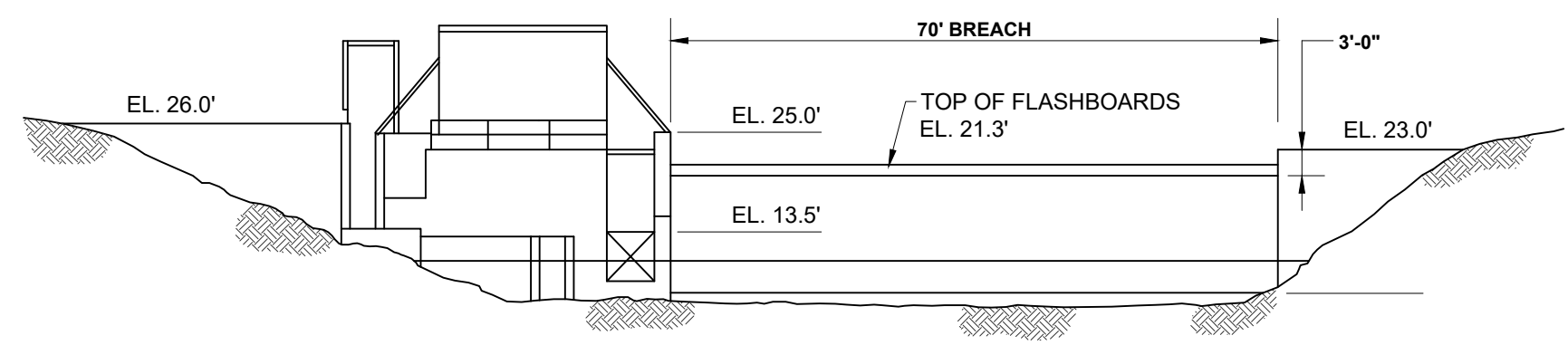

ELEVATION
SCALE: 1"=20'-0"

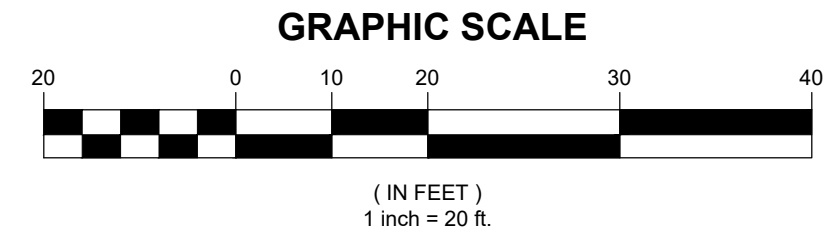

PROJECT	ALAMOOSOOK LAKE DAM, ORLAND, MAINE		DWG No.	FIGURE 2	BY	MEB / DBK	DRAWING STATUS
			JN	11299.023	DATE	2024.06.04	
TITLE	PLAN & ELEVATION		SCALE	AS NOTED	REV.		NOT FOR CONSTRUCTION
					REV. DATE		



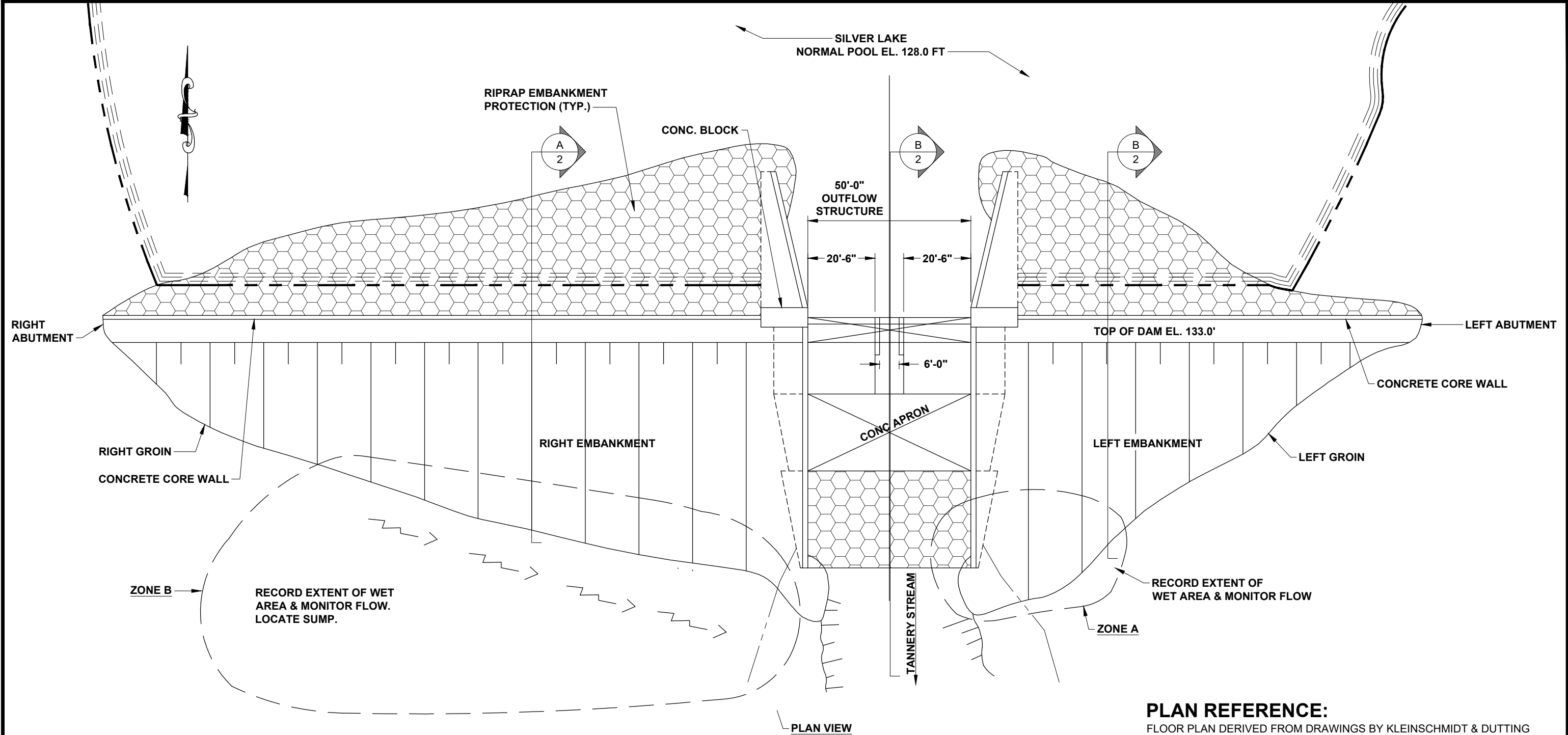

PLAN REFERENCE:
 FLOOR PLAN DERIVED FROM DRAWINGS BY KLEINSCHMIDT & DUTTING 1984 PLANS AND DAM INSPECTION REPORT 2021 PROVIDED TO HALEY WARD, INC AND ARE NOT WARRANTED AS TO ACCURACY AND ARE INTENDED TO BE SCHEMATIC.

PLAN VIEW
 SCALE: 1"=30'

PROJECT	#105 SILVER LAKE DAM BUCKSPORT, MAINE	DWG No.	1	BY	MEB	DRAWING STATUS
		JN	11299.023	DATE	2023.03.23	
TITLE	FIGURE 2: SITE PLAN	SCALE	1"=30'	REV.		NOT FOR CONSTRUCTION
				REV. DATE		



P:\11299-AM_DEVELOPMENT\023-RIVER RD BUCKSPORT EAP UPDATES 3 DAMS-DBK02-CAD_DRAWINGS\CIVIL\105 SILVER LAKE DAM\11299.023 FIGURE 2.DWG

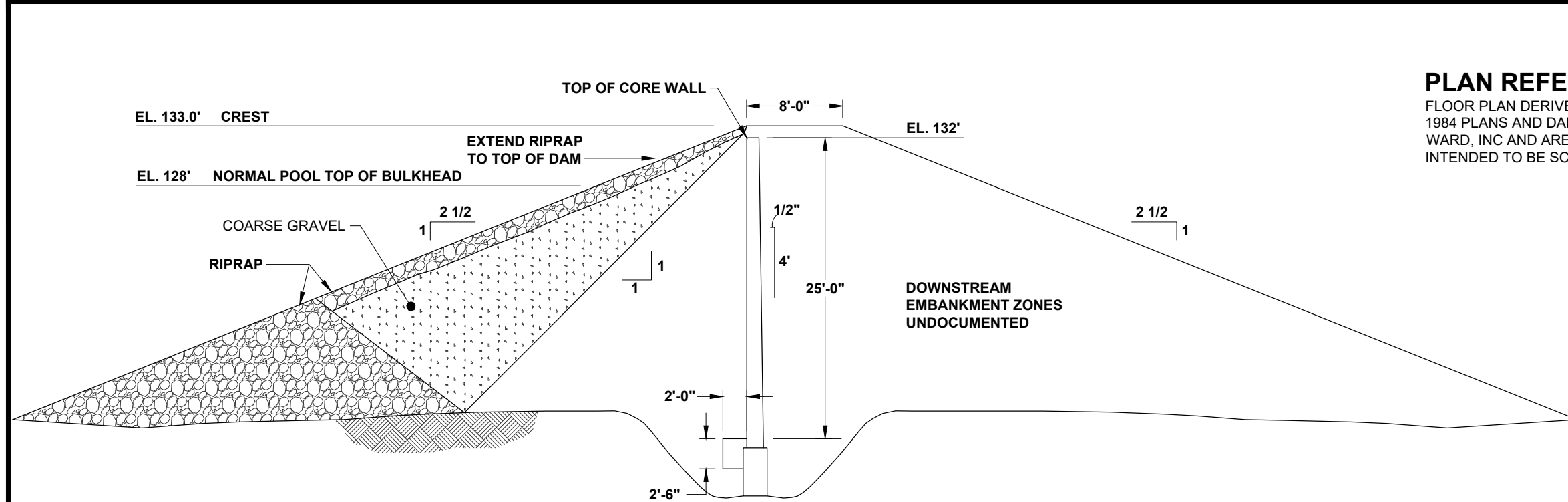

PLAN REFERENCE:

FLOOR PLAN DERIVED FROM DRAWINGS BY KLEINSCHMIDT & DUTTING 1984 PLANS AND DAM INSPECTION REPORT 2021 PROVIDED TO HALEY WARD, INC AND ARE NOT WARRANTED AS TO ACCURACY AND ARE INTENDED TO BE SCHEMATIC.

SECTION - THROUGH RIGHT EMBANKMENT

SCALE: 3/32"=1'-0"

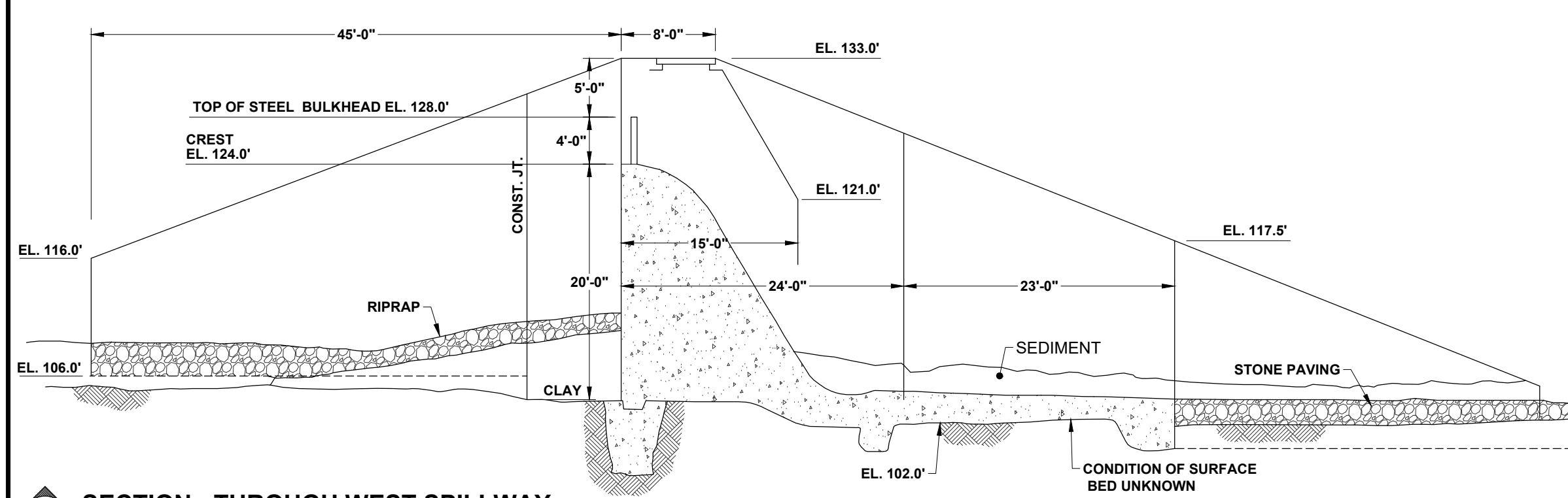

SECTION - THROUGH WEST SPILLWAY

SCALE: 3/32"=1'-0"

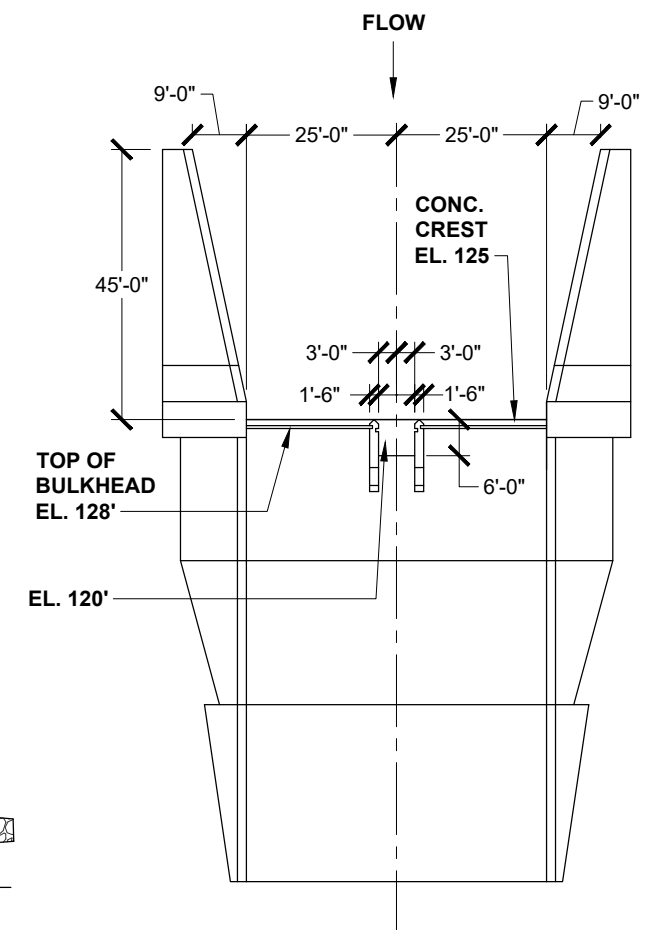

SPILLWAY PLAN

SCALE: 1/32"=1'-0"

PROJECT	#105 SILVER LAKE DAM BUCKSPORT, MAINE		DWG No.	3	BY	MEB	DRAWING STATUS
TITLE	FIGURE 3: DETAILS		JN	11299.023	DATE	2023.03.23	NOT FOR CONSTRUCTION
			SCALE	3/32"=1'-0"	REV.		
					REV. DATE		



P:\11299-AM_DEVELOPMENT\023-RIVER RD BUCKSPORT EAP UPDATES 3 DAMS-DBK02-CAD_DRAWINGS\CIVIL\105 SILVER LAKE DAM\11299.023 FIGURE 3.DWG

LEGEND

- ϕ UTILITY POLE
- OHU — OVERHEAD WIRES
- — — EDGE OF WATER
- - - - - TOE OF DAM
- GUIDE RAIL



DOWNSTREAM TOE OF DAM ASSUMED AT CHANNEL OUTLET TO BRIDGE IN 2021 DAM INSPECTION REPORT

DISCONTINUED POWER TAKE OFF. (ALIGNMENT UNDOCUMENTED)

SUPPORT POLE

DOWNSTREAM EMBANKMENT

HATCHERY RD

LEFT ABUTMENT

GUY

TODDY POND STREAM

FISHWAY

BRIDGE 5205

FISHWAY

DOWNSTREAM EMBANKMENT

RIGHT ABUTMENT

TODDY DAM RD

CONCRETE WALL CREST EL. 167.4±

RIGHT SPILLWAY CREST EL. 165.0±

GATE STRUCTURE WITH ELECTRONIC CONTROLS

WOODEN FOOT BRIDGE OVER LEFT SPILLWAY CREST EL. 165.0±

APPROXIMATE TOE OF DAM AS IDENTIFIED ON 1925 SURVEY FOR REPLACEMENT OF TODDY POND BRIDGE

DISCONTINUED INTAKE STRUCTURE

CONCRETE CORE WALL CREST EL. 166.5±

NOTES:

1. MAP IS PROJECTED USING UTM ZONE 19 COORDINATES, AND REFERENCES THE NORTH AMERICAN DATUM OF 1983 (NAD83).
2. NORTH ARROW IS ORIENTED TO GRID NORTH IN ALL MAP EXTENTS DEPICTED HEREIN.
3. BASE MAP COURTESY OF GOOGLE MAPS.
4. THE LOCATION OF OVERHEAD WIRES SHOULD BE CONSTRUED AS APPROXIMATE.
5. ELEVATIONS FOR SPILLWAY CREST AND DAM WALLS WERE OBTAINED FROM THE 2021 INSPECTION REPORT FOR TODDY POND DAM #111 ON FILE AT MEMA.
6. BRIDGE FEATURES AND APPROXIMATE TOE OF DAM WERE OBTAINED FROM PLANS DATED 1925 FOR BRIDGE 2505 ON FILE AT MDOT.
7. INFORMATION PROVIDED IN THE 1925 DAM SURVEY AND 2021 INSPECTION REPORT REFERENCED HEREIN CONFLICT WITH RESPECT TO THE LOCATION OF THE DAM'S DOWNSTREAM TOE. FURTHER INVESTIGATION IS REQUIRED TO DOCUMENT DOWNSTREAM LIMITS OF THE DAM.

GRAPHIC SCALE

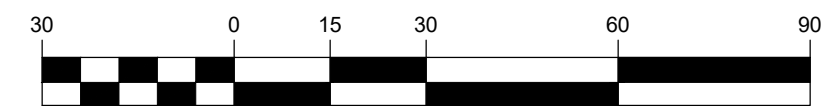

(IN FEET)
1 inch = 30 ft.

PROJECT

TODDY POND DAM, ORLAND, MAINE

TITLE

SITE PLAN

DWG No.

FIGURE 2

JN

11299.023

SCALE

AS NOTED

BY

MEB / DNB

DATE

2023.05.18

REV.

REV. DATE

DRAWING STATUS

NOT FOR CONSTRUCTION



P:\11299-AM_DEVELOPMENT\023-RIVER RD BUCKSPORT EAP UPDATES 3 DAMS-DBK02-CAD_DRAWINGS\CIVIL\TODDY POND DAM\11299.023 FIGURE 2.DWG

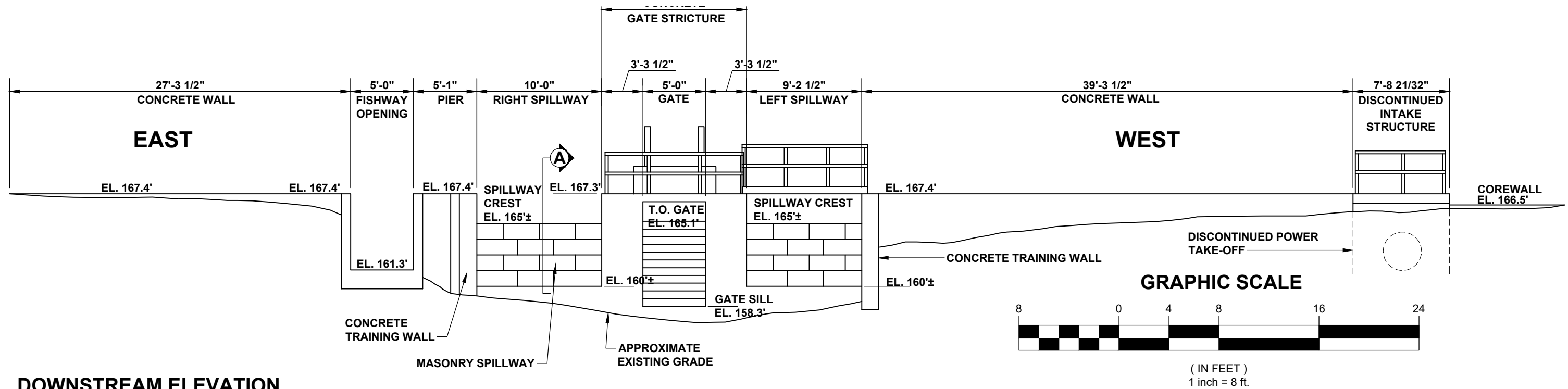

DOWNSTREAM ELEVATION

SCALE: 1"=8'-0"

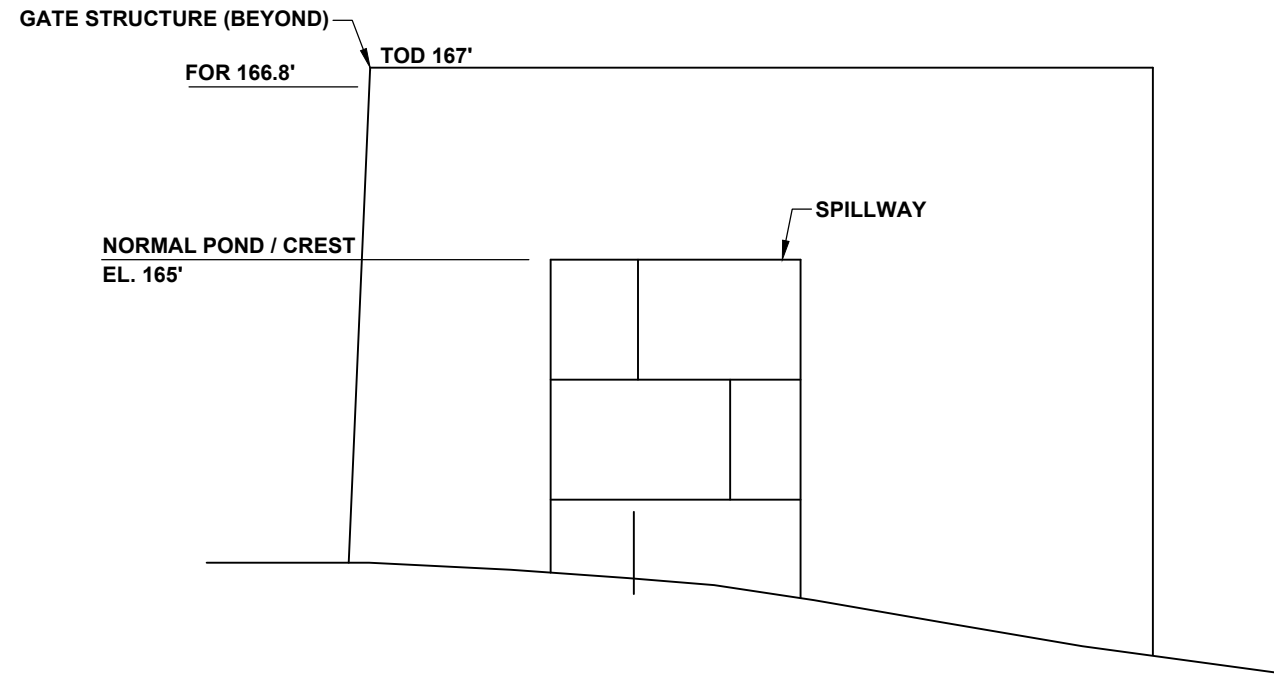
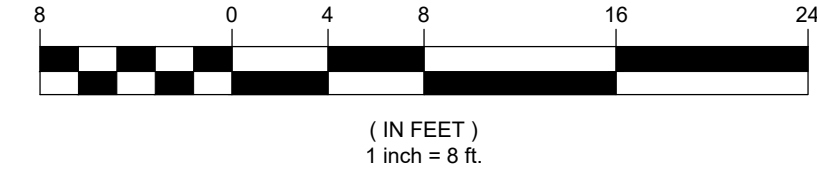

SECTION A

SCALE: 1"=2'-0"

NOTES:

1. THIS DRAWING WAS DIGITIZED BY HALEY WARD, INC. FROM A 1998 DRAWING BY KLEINSCHMIDT ASSOCIATES AND SHOULD BE CONSTRUED AS APPROXIMATE.
2. ELEVATIONS DEPICTED ON THIS DRAWING WERE OBTAINED FROM THE ABOVE-MENTIONED KLEINSCHMIDT DRAWING AS ANNOTATED BY MEMA IN THE 10/12/21 HAZARD & CONDITION REPORT FOR #111 TODDY POND DAM. ELEVATIONS APPEAR TO BE APPROXIMATELY REFERENCED TO NGVD-1929

P:\11299-AM_DEVELOPMENT\023-RIVER RD BUCKSPORT TEAP UPDATES 3 DAMS-DBK02-CAD_DRAWINGS\CIVIL\TODDY POND DAM\11299.023 2.DWG

PROJECT	TODDY POND DAM, ORLAND, MAINE	
TITLE	DOWNSTREAM ELEVATION	

DWG No.	FIGURE 3	BY	MEB / DNB
		DATE	2023.04.19
JN	11299.023	REV.	
SCALE	AS NOTED	REV. DATE	

DRAWING STATUS	NOT FOR CONSTRUCTION
----------------	-----------------------------



DESCRIPTION OF DAMS AND OPERATIONS

Provide a description of the physical condition of the dam and how the dam has been operated over the past five or more years.

A. Alamoosook Lake

Alamoosook Lake dam is a 93-year-old, 18-foot-high, significant hazard, concrete mass gravity structure, located in the Town of Orland, Hancock County Maine. The dam is part of the old Champion Lake Water System. The right abutment fishway, pumphouse & gate structure are accessed from Soper Road. The left abutment is accessed from Carrier Road through forest. There is no walkway across the dam. The dam's gate structure is fenced, gated and locked. Alamoosook Lake is primarily recreational.

(Credit – Hazard and Condition Report dated October 12, 2021)

Since acquisition by Bucksport Mill LLC in January of 2015, Alamoosook Lake has been operated by personnel originally employed by Verso Paper and subsequently by Bucksport Mill LLC or its then affiliated company, Bucksport Generation LLC. In November of 2019, ownership of the power plant (Bucksport Generation LLC) was sold. At the time of the sale, Bucksport Mill LLC entered into an agreement with Bucksport Generation LLC to continue to operate the water system. That agreement remains in place as of today. The system has continued to be operated in accordance with policies and procedures originally developed by the previous owner, Verso Paper Company.

Bucksport Generation LLC personnel, operating on behalf of Bucksport Mill LLC and pursuant to the aforementioned agreement, monitors the water level maintenance requirements at Alamoosook Lake. The Alamoosook dam gate is operated by personnel to maintain lake water level to prescribed guidelines outlined in the operations and maintenance manual. Dam and lake maintenance needs are reported as identified to Bucksport Mill LLC who reviews, approves and funds any necessary maintenance. Bucksport Mill LLC and operating personnel work collaboratively with 3rd party contractors to accomplish required maintenance and repairs.

B. Silver Lake

Silver Lake dam is a 30-foot-high, 450-foot-long, high hazard, composite mass gravity/earth dam, located on Tannery Brook, upstream of downtown Bucksport. The dam was designed by the New England Public Services Company for St. Regis Paper Co., to supply water to its paper mill as well as to the Town of Bucksport. It was built in 1930 and extensively rehabilitated in 1984, 54 years after construction. The dam is 93 years old.

(Credit – Hazard and Condition Report dated October 12, 2021)

Silver Lake is the primary impoundment servicing the Bucksport Mill site including the Maine Maritimes Academy building and Bucksport Generation power plant as well as the municipal water supply for the Town of Bucksport. There are no other end users of water supplied by Silver Lake.

Since acquisition by Bucksport Mill LLC in January of 2015, Silver Lake has been operated by personnel originally employed by Verso Paper and subsequently by Bucksport Mill LLC or its then affiliated company, Bucksport Generation LLC. In November of 2019, ownership of the power plant (Bucksport Generation LLC) was sold. At the time of the sale, Bucksport Mill LLC

entered into an agreement with Bucksport Generation LLC to continue to operate the water system. That agreement remains in place as of today. The system has continued to be operated in accordance with policies and procedures originally developed by the previous owner, Verso Paper Company.

Bucksport Generation LLC personnel, operating on behalf of Bucksport Mill LLC and pursuant to the aforementioned agreement, monitors the water level maintenance requirements at Silver Lake. Dam and lake maintenance needs are reported as identified to Bucksport Mill LLC who reviews, approves and funds any necessary maintenance. Bucksport Mill LLC and operating personnel work collaboratively with 3rd party contractors to accomplish required maintenance and repairs.

C. Toddy Pond

Toddy Pond Dam is a 102-year-old, significant hazard dam, located in the Town of Orland, Hancock County, Maine. The dam is 14-foot-high, 196-foot-long, composite mass gravity/earth dam structure fitted with a concrete fishway. The dam was built in 1921 as a mill dam to store water to supply downstream mills along the downstream Marramissic River. After the mills were closed, the dam continued to supply Alamoosook Lake, from which water was pumped across the watershed into Silver Lake for use by the Town of Bucksport. Since closure of the Bucksport paper mill, the lake is used primarily for recreation. The dam's last major repair was in 1947. The dam raises Toddy Pond, a glacial lake, by about 8' – storing a substantial volume of water.

(Credit – Hazard and Condition Report dated October 12, 2021)

Since acquisition by Bucksport Mill LLC in January of 2015, Toddy Pond has been operated by personnel originally employed by Verso Paper and subsequently by Bucksport Mill LLC or its then affiliated company, Bucksport Generation LLC. In November of 2019, ownership of the power plant (Bucksport Generation LLC) was sold. At the time of the sale, Bucksport Mill LLC entered into an agreement with Bucksport Generation LLC to continue to operate the water system. That agreement remains in place as of today. The system has continued to be operated in accordance with policies and procedures originally developed by the previous owner, Verso Paper Company.

Bucksport Generation LLC personnel, operating on behalf of Bucksport Mill LLC and pursuant to the aforementioned agreement, monitors the water level maintenance requirements at Toddy Pond. The Toddy Pond dam gate is operated by personnel to maintain lake water level to prescribed guidelines outlined in the operations and maintenance manual. Dam and pond maintenance needs are reported as identified to Bucksport Mill LLC who reviews, approves and funds any necessary maintenance. Bucksport Mill LLC and operating personnel work collaboratively with 3rd party contractors to accomplish required maintenance and repairs.

CONSULTATION

Please note that Petitioner has notified via certified mail local, regional and statewide private organizations whose interests may be affected by each dam. Those organizations who have been notified via certified mail are Atlantic Salmon Federation, Great Pond Mountain Conservation Trust, Frenchman Bay Conservancy, Trout Unlimited, Conservation Law Foundation and Natural Resources Council of Maine. A copy of the certified mail receipts, which includes these organizations as well as those required to receive certified mailings pursuant to Application 7.C, has been included at the end of this Petition as an Attachment to the Public Notice.

Please note that the Petitioner has also sent notice to all abutting property owners via US first class mail pursuant to 38 MRS Section 901.3, and, pursuant to 38 MRS Section 902.4-A, will file a report confirming all consultation details in compliance with Sections 902.1 and 902.3 in the coming weeks.

NOTICE OF INTENT TO FILE

PETITION FOR RELEASE FROM DAM OWNERSHIP AND WATER LEVEL MAINTENANCE

Please take notice that AIM Demolition USA LLC of PO BOX 1874, Bucksport, ME 04416 and Bucksport Mill, LLC of 30 Generation Lane, Bucksport, ME 04416 are intending to file a petition with the Maine Department of Environmental Protection for release from dam ownership or water level maintenance under the provisions of Title 38, Maine Revised Statutes Annotated, Sections 901 to 908.

This petition pertains to the dams impounding:

- A. Alamoosook Lake, located at 31 Soper Road in the town of Orland in Hancock County;
- B. Silver Lake, located off Central Street in the town of Bucksport in Hancock County; and
- C. Toddy Pond, located off Toddy Dam Road (identified as Tax Map 039, Lot 2) in the town of Orland in Hancock County.

The petition will be filed on or around July 12, 2024 and will be available for public inspection at the DEP's offices in Augusta during normal working hours.

In the event that a new owner is not found for the dam, the DEP will issue an order requiring the dam owner to release the water from the dam.

A dam owner is not prohibited from requesting compensation for the transfer of the dam to a new owner. However, the DEP will not issue a water release order to a dam owner who has refused to transfer the dam to a person willing to assume ownership because that person refused to compensate the dam owner for the property.

PUBLIC NOTICE

By signing this petition, the petitioner or authorized agent certifies that he or she has:

- A. Published a completed Notice of Intent to File at least once in a newspaper circulated in the area in which the dam and impoundment are located within 30 days prior to the filing of the petition. Please see the attached tear sheet evidencing publication. NOTE: Tear sheet will be provided separately once it is available after July 12 publishing in Bangor Daily News.
- B. Sent a copy of a completed Notice of Intent to File by first class mail to all persons who own property abutting the dam site, the impoundment, or the waterway immediately downstream from the dam. Please see the attached list of abutters for each project to whom notices were sent.
- C. Sent a copy of a completed Notice of Intent to File by certified mail or Certificate of Mailing to:
 - The Commissioner of Inland Fisheries and Wildlife, 41 State House Station, Augusta, ME 04333. (207-287-5202)
 - The Commissioner of Conservation, 22 State House Station, Augusta, ME 04333. (207-287-2211)
 - The Director of the Maine Emergency Management Agency, 72 State House Station, Augusta, ME 04333. (207-626-4202)
 - The municipal officers of any municipality and the county commissioners of any unorganized territories in which the dam or impoundment is located.
 - Representatives of the tribal governments of any of the following Indian tribes or nations in whose territory a dam or impoundment is located¹:
 - Governor and Tribal Council, Passamaquoddy Tribe/Pleasant Point, PO Box 343, Perry, ME 04667. (207-853-2600)
 - Governor and Tribal Council, Passamaquoddy Tribe/Indian Township, PO Box 301, Princeton, ME 04668. (207-796-2301)
 - Governor and Tribal Council, Penobscot Indian Nation, Indian Island/6 River Road, Old Town, ME 04468. (207-827-7776)
 - Tribal Chief and Tribal Council, Aroostook Band of Micmac Indians, 531 D Street, Presque Isle, ME 04769. (207-764-1972)
 - Tribal Chief and Tribal Council, Houlton Band of Maliseet Indians, RR#3 Box 450, Houlton, ME 04730. (207-532-4273)

¹ Please note that notice has only been mailed to the Penobscot Tribal Nation as the relevant dams in this petition are not located in any of the other tribal government territories.

Attachment to Public Notice – List of Abutters – Alamoosook Lake

Note this list is based on the 2023-2024 Real Estate Tax Commitment Book and 2023 Tax Maps on file with the Town of Orland, Maine (Tax Maps 10, 26, 27, 28, 29, 30, 31, 32, 34, 35, 36 & 37)

Tax Map-Lot	Property Owner	Mailing Address	Mailing T/S/Z	Deed Reference
TM 037 Lot 011	Alamoosook Lake Camp, LLC	1040 Timberlake Drive	Bloomfield, MI 48302	6926-126
TM 037 Lot 010	Dale Sehulster Weathervane Farm	PO BOX 242	Ringoes, NJ 08551	1763-559
TM 037 Lot 009	Linda A. Shawen Scott A. Shawen	5523 Meadowhaven Lane	Charlotte, NC 28270	5921-198
TM 037 Lot 008	John A. Streeter	18 Chute Road	Windham, ME 04062	1702-39
TM 037 Lot 007	Kelly R. Sawyer Mark A. Sawyer	222 Hatchery Road	Orland, ME 04472	5139-313
TM 037 Lot 006	Peter R. Walton Barbara Family Trust	PO BOX 68	East Orland, ME 04431	5898-195
TM 037 Lot 005	Susan D. Kinter	104 Amsbury Court	Severna Park, MD 21146	5457-256
TM 037 Lot 004	L. Brott Russell Jeanne Russell	PO BOX 353	Bucksport, ME 04416	5105-240
TM 037 Lot 003	Darryl N. Bagley	454 Front Ridge Road	Orland, ME 04472	3618-238
TM 037 Lot 002	Andrew K. Silvernail Shelby H. Silvernail	471 Hasting Road	Lake Forest, IL 60045	4615-120
TM 037 Lot 001	Carolyn R. Henderson William M. Henderson	529 Main Street	Shrewsbury, MA 01545	1439-64
TM 036 Lot 038	Edward A. Rodgers Mary Lane Rodgers	PO BOX 1	East Orland, ME 04431	1368-607
TM 036 Lot 037	J. Cullinan Rodgers Edward A. Rodgers	PO BOX 1	East Orland, ME 04431	3592-295
TM 036 Lot 036	Andrew I. McKinnon	235 French Street	Bangor, ME 04401	6140-208
TM 036 Lot 034	AIM Demolition USA LLC	PO BOX 1874	Bucksport, ME 04416	4588-26
TM 036 Lot 028	Archie McCallister Lorraine McCallister c/o David McCallister	PO BOX 3022	Zephyrhillis, FL 33539	7091-781
TM 036 Lot 027	Not Listed	Not Listed	Not Listed	Not Listed

Tax Map-Lot	Property Owner	Mailing Address	Mailing T/S/Z	Deed Reference
TM 036 Lot 026	Nancy J. Schloss David C. Schloss	PO BOX 15	East Orland, ME 04431	7108-534
TM 036 Lot 017	Robert J. Lambert Megan M. Lambert	208 Wells Street	North Berwick, ME 03906	7059-416
TM 036 Lot 010	New England Sports Complex, Inc.	61 locust Street, Suite 220	Dover, NH 03820	7059-425
TM 036 Lot 009	Rodney E. Rockwell	27 Rockwell Lane	Eddington, ME 04428	5468-245
TM 035 Lot 012	Faylene Cunningham	76 Back Searsport Road	Searsport, ME 04974	2760-620
TM 034 Lot 008- 00A	Not Listed	Not Listed	Not Listed	Not Listed
TM 034 Lot 008	MW Inglis Qualified Personal Resident Trust	67 Players Club Villas Drive	Ponte Vedra Beach, FL 32082	5921-225
TM 034 Lot 007	Jose A. Faleiro	5168 Aurora Lake Circle	Green Acres, FL 33463	2076-284
TM 034 Lot 006	Nelson Revocable Trust c/o Lorilyn Lucy	223 West Side Drive	Verona Island, ME 04416	6173-37
TM 034 Lot 005	William P. Lucy Lorilyn G. Lucy	223 West Side Drive	Verona Island, ME 04416	1958-73
TM 034 Lot 004	Kendrick H. Chase	PO BOX 296	Bucksport, ME 04416	3189-183
TM 034 Lot 003	David Walter Smith Amy S. Pierce, Trustee	3508 Kyle Court	Wilmington, NC 28409	6422-311
TM 034 Lot 002	Richard R. Riemersma	PO Box 1849	Bucksport, ME 04416	2182-40
TM 034 Lot 001	Fox Holdings LLC	1504 Happytown Road	Orland, ME 04472	7066-31
TM 032 Lot 007	Hartmann Trust	18 Rainbow Pond Drive Apt 2C	Walpole, MA 02081	4194-262
TM 032 Lot 007- 003	Timothy P. Hartman	480 Appleton Street	Arlington, MA 02476	6187-280
TM 032 Lot 007- 002	Eric Murphy Sarah Murphy & Eileen Reilly	PO BOX 1792	Bucksport, ME 04416	6906-918
TM 032 Lot 007- 001	Karen L. Wardwell	PO BOX 502	Bucksport, ME 04416	2299-86
TM 032 Lot 005	Buck Camp LLC	404 Dunsinane Road	Singal Mountain, TN 37377	6268-273
TM 032 Lot 003- D	Ellen Cleveland	PO BOX 1071	Ellsworth, ME 04605	6653-291

Tax Map-Lot	Property Owner	Mailing Address	Mailing T/S/Z	Deed Reference
TM 032 Lot 002	Saumsiegle Family LLC Elizabeth Quinn Lane Barbara Elizabeth Quinn c/o Stephen H. Saumsiegle	205 Hillcrest Court	McCormick, SC 29835	7247-671
TM 032 Lot 001	Jason M. Moore	3003 West Stovall St.	Tampa, FL 33629	6813-130
TM 032 Lot 001-A	Katherine Marshall Greenman	PO BOX 465	Orland, ME 04472	5478-48
TM 031 Lot 009	Earl L. Soper	PO BOX 64	Orland, ME 04472	1101-209
TM 031 Lot 008	Earl L. Soper	PO BOX 64	Orland, ME 04472	1275-142
TM 031 Lot 007	Melissa J. Mensah-OSAFO	301 Sawgrass Drive	Charles Town, WV 25414	7029-866
TM 031 Lot 006	David B. Burgess Linda M. Burgess	637 Acadia Highway	Orland, ME 04472	3092-279
TM 031 Lot 005	Not Listed	Not Listed	Not Listed	Not Listed
TM 031 Lot 004	Joanne Pierce	695 Acadia Highway	Orland, ME 04472	2744-187
TM 031 Lot 003	Clyde M. Grindle Joanne A. Grindle, Heirs c/o Jason Grindle	8 Cedar Street	Bucksport, ME 04416	3925-82
TM 031 Lot 002	Sandra Dillon M. Loveland Dillon	929 Manatawna Ave	Philadelphia, PA 19128	6091-62
TM 031 Lot 001	Marie Flesher	123 Meadowbrook Lane	Orland, ME 04472	7171-597
TM 030 Lot 001	Ellen Susan Russell	136 Maple Street	Bangor, ME 04401	2494-89
TM 030 Lot 002	Hanson Irrevocable Real Estate Trust	PO BOX 443	Orland, ME 04472	2874-91
TM 030 Lot 003	Charles Kittridge Katherine Kittridge	11 Cromwell Drive	Orono, ME 04473	6203-217
TM 030 Lot 004	Catherine A. Crosby	PO BOX 243	Orland, ME 04472	5070-310
TM 030 Lot 005	Kevin Barry Janine Barry	PO BOX 216	Orland, ME 04472	4897-149
TM 030 Lot 006	Richard D. Kelley Henrietta S. Kelley	840 Kennebeck Road	Hampden, ME 04444	1532-648
TM 030 Lot 007	Earl L. Soper	PO BOX 64	Orland, ME 04472	1129-447
TM 030 Lot 008	Michael McAllian Laurie McAllian	PO BOX 228	Orland, ME 04472	7189-220
TM 030 Lot 009	Mary D. Murray	PO BOX 61	Orland, ME 04472	6801-181

Tax Map-Lot	Property Owner	Mailing Address	Mailing T/S/Z	Deed Reference
TM 029 Lot 001	Sturfels Family Camp Trust	123 Briarwood Drive	Little Egg Harbor, NJ 08087	7233-92
TM 029 Lot 002	Darlene S. Ratte	217 Skowhegan Rd	Fairfield, ME 04937	6368-180
TM 029 Lot 003	Harrison Living Trust	13 Highview Road	Cape Elizabeth, ME 04107	5528-35
TM 029 Lot 004	Marianne Sacknoff Revocable Trust	2 City Center, Suite 300	Portland, ME 04101	6600-128
TM 029 Lot 005	Gregory S. Doucette Donna C. Doucette	66 Crossing Brook Road	Cumberland, ME 04021	5074-55
TM 029 Lot 006	Georgeia Rae Doucette Winsor John Fuller Wesson	4 Colonial Court	Portland, ME 04102	7117-533
TM 029 Lot 007	Lawrence A. Larson	24 Hero's Brook Lane	Bucksport, ME 04416	4067-159
TM 028 Lot 009	Jennifer Jo Annis Carrie Jane Drake Lacey Mae Hammond	50 Northwood Drive	Portland, ME 04103	6816-123
TM 028 Lot 008	Charleyne A. Gilbert	439 Bucks Mills Road	Bucksport, ME 04416	1494-147
TM 028 Lot 007	Wesley C. Stubbs	45 Turkey Path Road	Bucksport, ME 04416	2899-35
TM 028 Lot 006	Wesley C. Stubbs Marie Stubbs	45 Turkey Path Road	Bucksport, ME 04416	2328-64
TM 028 Lot 005	Trina McCormick	1345 Springbank Road	Kingstree, SC 29556	6773-155
TM 028 Lot 004	Jensen Family Camp LLC	605 Kent Oaks Way	Gaithersburg, MD 20878	5950-213
TM 028 Lot 003	Bull Frog Holdings LLC c/o Marguerite Rogers	210 Locust Street, 31-B	Philadelphia, PA 19106	6583-221
TM 028 Lot 002	Trust for Maine Properties	2080 Beans Bright Rd NE	Bainbridge Island, WA 98110	6866-476
TM 028 Lot 001	Trust for Maine Properties	2080 Beans Bright Rd NE	Bainbridge Island, WA 98110	6866-476
TM 027 Lot 021	Nanson, Brian C.	29 Sprucewood Lane	Orland, ME 04472	3922-191
TM 027 Lot 020	Milan, David	23 Red Paint Lane	Orland, ME 04472	1937-59
TM 027 Lot 019	Bushong, Regina	PO Box 304	Orland, ME 04472	6882-356
TM 027 Lot 018	Sawyer, James B.	2 Jodys Acres	SW Harbor, ME 04679	6076-304
TM 027 Lot 017	Sawyer, James B.	2 Jodys Acres	SW Harbor, ME 04679	6076-304
TM 027 Lot 016-A	Moulton, Norman Jr.	39 Vokes Drive	Trenton, ME 04605	2837-187

Tax Map-Lot	Property Owner	Mailing Address	Mailing T/S/Z	Deed Reference
TM 027 Lot 016	Kennedy et als., Caitlin	400 Woodlawn Rd	Baltimore, MD 21210	2884-584
TM 027 Lot 013	IAA, LLC	PO Box 16	Orland, ME 04472	6881-620
TM 027 Lot 010	Johnson, Alan P.	PO Box 11	Orland, ME 04472	4261-45
TM 027 Lot 009	Giard, Mary H.	211 Soper Road	Orland, ME 04472	3973-230
TM 027 Lot 023	Giard Family Alamoosook Lake Trust	203 Soper Road	Orland, ME 04472	6936-548
TM 027 Lot 008	Not Listed	Not Listed	Not Listed	Not Listed
TM 027 Lot 007	Not Listed	Not Listed	Not Listed	Not Listed
TM 027 Lot 006	Deweese, Lisa	38 Mushrall Lane	Orland, ME 04472	6879-487
TM 027 Lot 005- A	Mushrall, Barbara	40 Mushrall Lane	Orland, ME 04472	2655-440
TM 027 Lot 005	Dibiase, Mary Charlene	41 Mushrall Lane	Orland, ME 04472	1288-350
TM 027 Lot 004	Dodges Lodge Inc.	11249 Egeria Drive	Odessa, FL 33556	1398-410
TM 027 Lot 004- a	Dodge Trust, Richard N & Sue A	723 Ellery	Jackson, MI 49202	4942-52
TM 027 Lot 003	Pierce Family Real Estate Trust	PO Box 424	Orland, ME 04472	4986-281
TM 027 Lot 002	Emery Family Camps Trust Agmt	64 Wardwell Point Rd	Penobscot, ME 04476	5246-304
TM 027 Lot 001	Wienges, Othniel H.	6 Beach Rd	Lincolnton, ME 04849	7063-756
TM 026 Lot 020- a	Wheelden, James	250 Johnson Mill Rd	Orrington, ME 04474	6638-118
TM 026 Lot 018	Wheelden, James	250 Johnson Mill Rd	Orrington, ME 04474	3848-81
TM 026 Lot 017	Bisbee, Holly	29535 Reddish Lane	Red Level, AL 36474	6656-251
TM 026 Lot 019	Ames, Ryan & Lynella	320 Betts Rd	Orrington, ME 04474	6680-312
TM 026 Lot 021	Sanborne, Joanne	81 Gilpin Rd	Orland, ME 04472	6978-147; 1680-93
TM 026 Lot 021- a	Sanborne, Joanne	81 Gilpin Rd	Orland, ME 04472	6978-147; 1680-93
TM 026 Lot 016	Stevens, Arthur	9 Bings Boulevard	Swanville, ME 04915	5102-300
TM 026 Lot 010	Aim Demolition USA LLC	PO Box 1874	Bucksport, ME 04416	4588-26
TM 026 Lot 009	Aim Demolition USA LLC	PO Box 1874	Bucksport, ME 04416	4588-26
TM 026 Lot 008	Fowler, David O.	1115 Pushaw Rd	Glenburn, ME 04401	7056-466
TM 026 Lot 007	Carrier, Michael A.	31 Leaches Point Rd	Orland, ME 04472	2271-166
TM 026 Lot 006	Chattin, Daniel A.	75 Perkins Hill Rd	Harwinton, CT 06791	3394-17
TM 026 Lot 005	Chattin, Daniel A.	75 Perkins Hill Rd	Harwinton, CT 06791	3142-315

Tax Map-Lot	Property Owner	Mailing Address	Mailing T/S/Z	Deed Reference
TM 026 Lot 004	Wescott, Theodore P., Jr.	52 Patterson Ridge Rd	Thorndike, ME 04986	1546-477
TM 026 Lot 003	Fontaine, Stephanie	514 Indian Point Rd	Bar Harbor, ME 04609	6615-50
TM 026 Lot 002	Laslie, John H.	PO Box 82	Orland, ME 04472	4361-156
TM 010 Lot 011	Peninsula Farms, LLC	PO Box 407	Orland, ME 04472	6909-509
TM 010 Lot 012	Van Leer Mayflower Properties LLC	PO Box 1385	Lexington, VA 24450	6045-172
TM 010 Lot 013	Van Leer Mayflower Properties LLC	PO Box 1385	Lexington, VA 24450	6045-168
TM 010 Lot 013-a	Trust for Maine Properties	2080 Beans Bright Rd NE	Bainbridge Island, WA 98110	6866-482
TM 010 Lot 014	Sunnyside High Acres LLC	2801 N 71 Street	Millwaukee, WI 53210	3758-80
TM 010 Lot 045	Wadleigh, Kim	480 Central Street	Bucksport, ME 04416	7035-284
TM 010 Lot 045.2	Blodgett, Frederic S., II	68 Charlie Star Lane	Orland, ME 04472	7094-438
TM 010 Lot 014-B	Sunnyside High Acres LLC	2801 N 71 Street	Milwaukee, WI 53210	3758-80
TM 010 Lot 020	Saunders, Kenneth M.	241 Upper Falls Road	Orland, ME 04472	6142-93
TM 010 Lot 025	Ratte, Darlene S.	217 Skowhegan Rd	Fairfield, ME 04937	6355-288
TM 010 Lot 029	Nanson, Brian C.	29 Sprucewood Lane	Orland, ME 04472	3291-222
TM 010 Lot 029A	Rene, Natacha N.	2125 Gregory Creek Dr.	Little Elm, TX 75068	5106-275
TM 010 Lot 030	Oldenburg Cottage Trust	238 Woburn Street	Wilmington, MA 01887	6505-310
TM 010 Lot 028d	McGuckian-Smith, Family Trust	3812 SE 16th Place	Cape Coral, FL 33904	7155-123
TM 010 Lot 031	Kesnig, Christine	305 Esplanade	Maywood, NJ 07607	7045-160; 5861-191
TM 010 Lot 032	Peterson, Tedford M.	PO Box 280	Orland, ME 04472	1979-245
TM 010 Lot 043	Best, Francis Hawkes	104 Randall Lane	Orland, ME 04472	6878-1
TM 010 Lot 035-1	Pillsbury, Pat	1109 Via La Cuesta	Escondido, CA 92029	7143-533
TM 010 Lot 035B	Pillsbury, Pat	1029 Inspiration Lane	Escondido, CA 92025	7143-533
TM 010 Lot 035	Clifford, Ordway T., Heirs	123 East 75th St, Apt 6E	New York, NY 10021	788-50
TM 010 Lot 040	Clifford, Ordway T., Heirs	123 East 75th St, Apt 6E	New York, NY 10021	1544-533
TM 010 Lot 036	Clifford, Ordway T., Heirs	123 East 75th St, Apt 6E	New York, NY 10021	1271-656

Tax Map-Lot	Property Owner	Mailing Address	Mailing T/S/Z	Deed Reference
TM 010 Lot 037	Not Listed	Not Listed	Not Listed	Not Listed
TM 010 Lot 038	McCormick, Trina	1345 Springbank Road	Kingtree, SC 29556	4575-202
TM 010 Lot 039	Sumner, Stephen	6205 Tim Drive	Wadsworth, OH 44281	1815-453
TM 010 Lot 014R	Not Listed	Not Listed	Not Listed	Not Listed
TM 028 Lot 012	Trust for Maine Properties Nathaniel B. Page, Trustee	2080 Beans Bight Road NE	Bainbridge Island, WA 98110	6866-476
TM 026 Lot 002 A	William H. Carrier, Jr.	27 Chickadee Lane	Orland, ME 04472	4495-78
TM 026 Lot 002 B	Matthew P. Carrier	31 Leaches Point Rd	Orland, ME 04472	5261-190
TM 026 Lot 011	Levandoski Trust	513 Colonel Ledyard Hwy	Ledyard, CT 06339	4286-240
TM 026 Lot 012	Thomas D. Mackey Julie R. Mackey	PO Box 69	Orland, ME 04472	1568-155
TM 026 Lot 013	Edythe B. Gray	44 Soper Road	Orland, ME 04472	3760-343
TM 026 Lot 015	Kelly Jean Ronco Matthew Scott Ronco	75 Soper Road	Orland, ME 04472	7065-260
TM 010 Lot 014-C	Frederic S. Blodgett, II	68 Charlie Star Lane	Orland, ME 04472	4053-74
TM 010 Lot 027	Sean S. Harriman Robert E. Harriman, Jr. Catherine M. Harriman Day	PO Box 1657	Bucksport, ME 04416	6411-256
TM 010 Lot 028 G	Roland Hutchins	PO Box 47	Penobscot, ME 04476	3212-72
TM 010 Lot 045	Kim Wadleigh	480 Central Street	Bucksport, ME 04416	7035-284
TM 010 Lot 045-1	Sunnyside High Acres LLC	2801 N 71 Street	Millwaukee, WI 53210	3758-80
TM 010 Lot 045-2	Frederic S. Blodgett, II	68 Charlie Star Lane	Orland, ME 04472	7094-438
TM 010 Lot 045-3	Frederic S. Blodgett, II	68 Charlie Star Lane	Orland, ME 04472	7128-94

Attachment to Public Notice – List of Abutters – Silver Lake

Note this list is based on the 2023-2024 Real Estate Tax Commitment Book and 2021 Tax Maps on file with the Town of Bucksport, Maine

Tax Map-Lot	Property Owner	Mailing Address	Mailing T/S/Z	Deed Reference
TM 001-	Catholic Cemetery			
TM 001-004	Penobscot Narrow Solar, LLC	111 Speen Street	Framingham, MA 01701	717-693
TM 001-019	Paul P. Bires, Tr Keith Bires	294 Silver Lake Road	Bucksport, ME 04416	4046-180
TM 001-022	Sally A. Farnham	300 Silver Lake Road	Bucksport, ME 04416	1153-524
TM 001-023	Paul P. Bires, III Betty A. Bires	310 Silver Lake Road	Bucksport, ME 04416	1903-412
TM 001-024	Paul P. Bires, III Betty A. Bires	310 Silver Lake Road	Bucksport, ME 04416	1140-655
TM 001-081	Silver Lake Cemetary Ass'n c/o Kathy Downes	PO BOX 59	Bucksport, ME 04416	1739-211 1039-178
TM 001-082	Bucksport Mill, LLC AIM Development (USA) LLC	30 Generation Lane	Bucksport, ME 04416	4853-16
TM 001-083	Candace J. Dunbar	PO BOX 1096	Bucksport, ME 04416	4138-267
TM 005-001	Wesley C. Stubbs Marie E. Stubbs	45 Turkey Path	Bucksport, ME 04416	2684-96
TM 005-002	Estate of Harry C. Stubbs Estate of Clara E. Stubbs	c/o William B. Stubbs 350 Bucksfills Road	Bucksport, ME 04416	1578-143
TM 005-003	John C. Stubbs	426 Birch Street	Bangor, ME 04401	1501-243
TM 005-005	Neil Poglese Genieveve MS Hass	39 Elm Street	Bangor, ME 04401	7052-931
TM 005-007	Linda J. Lowell	555 Silver Lake Road	Bucksport, ME 04416	2780-647
TM 005-009	Town of Bucksport	PO Drawer X	Bucksport, ME 04416	4324-1
TM 005-010	Town of Bucksport	PO Drawer X	Bucksport, ME 04416	5568-333
TM 005-011	Bucksport Mill, LLC AIM Development (USA) LLC	30 Generation Lane	Bucksport, ME 04416	4853-16
TM 005-012-001	Chris Ames	PO BOX 244	Bucksport, ME 04416	7185-215
TM 005-013	Glenn S. Findlay Judith R. Findlay	56 Lakeside Drive	Bucksport, ME 04416	2742-197
TM 005-014	Daniel E. Cutshall	871 Bar Harbor Road	Trenton, ME 04605	6154-299
TM 005-015	Town of Bucksport	PO Drawer X	Bucksport, ME 04416	2864-409
TM 005-022	Pam Smith	16 Katahdin Drive	Bucksport, ME 04416	unknown
TM 005-028	Jeffrey L. Smith	78 Millvale Road	Bucksport, ME 04416	1458-51

Tax Map-Lot	Property Owner	Mailing Address	Mailing T/S/Z	Deed Reference
TM 005-029	Jeffrey L. Smith	78 Millvale Road	Bucksport, ME 04416	4447-19-22
TM 005-031	Arthur N. Plourde Linda J. Plourde	PO BOX 1717	Bucksport, ME 04416	2414-134
TM 005-067	Jonathan K. Goss	26 Lakeside Drive	Bucksport, ME 04416	7103-395
TM 009-003	Robert L. Chasse Earlene R. Chasse	699 Silver Lake Road	Bucksport, ME 04416	1114-738
TM 009-007	Sandra Robshaw	280 Millvale Road	Bucksport, ME 04416	1428-547
TM 009-015	Barbara Ann Raymond Revocable Trust	16103 Ridgewood Avenue	Montverde, FL 34756	6816-121
TM 009-040	Central Maine Power Company c/o Avangrid Mgmt Co	One City Center, 5th Flr	Portland, ME 04101	unknown
TM 009-084	Jessica Moretti	1325 Bayport Avenue	Marco Island, FL 34145	5687-191
TM 009-085	Brian R. Seekins	33 Town Farm Road	Bucksport, ME 04416	1464-276
TM 009-093	John Michael Jackson, Trustee John Michael Jackson Irrevocable Trust	PO BOX 808	Bucksport, ME 04416	6644-246
TM 009-094	Robert L. Chasse Earlene R. Chasse	699 Silver Lake Road	Bucksport, ME 04416	1114-738
TM 009-095	Sandra Robshaw	280 Millvale Road	Bucksport, ME 04416	5132-3
TM 009-096	Bucksport Mill, LLC AIM Development (USA) LLC	30 Generation Lane	Bucksport, ME 04416	4853-16
TM 001-080	Scott Findlay Kathleen Findlay	177 Silver Lake Road	Bucksport, ME 04416	3451-148
TM 001-063-1	Wesley J. Sutherland	49 Scott's Lane	Bucksport, ME 04416	5659-315
TM 001-069	Central Maine Power Company c/o Avangrid Mgmt Co	One City Center, 5th Flr	Portland, ME 04101	1020-195 1019-93
TM 031-001	Scott A. Larrabee Angelica Larrabee	178 Central Street	Bucksport, ME 04416	7104-96
TM 031-002	Qi Qi Chen	258 Swan Road	Hermon, ME 04401	7125-72
TM 031-003	Tamatha Hendricks Stacey Kelley David E. George, Life estate	192 Central Street	Bucksport, ME 04416	3336-28
TM 031-004	Richard K. Ames, II	198 Central Street	Bucksport, ME 04416	6466-73
TM 031-005	Naomi R. Graychase	202 Central Street	Bucksport, ME 04416	5315-266
TM 031-006	John Alden Grindle Celeste T. Grindle	208 Central Street	Bucksport, ME 04416	6177-329 2279-1

Tax Map-Lot	Property Owner	Mailing Address	Mailing T/S/Z	Deed Reference
TM 031-007	John A. Grindle Celeste T. Grindle	208 Central Street	Bucksport, ME 04416	6178-254
TM 031-014	Stephen M. Leonard	212 Central Street	Bucksport, ME 04416	3813-241

Attachment to Public Notice – List of Abutters – Toddy Pond

Note this list is based on the 2023-2024 Real Estate Tax Commitment Book and 2021 Tax Maps on file with the Town of Bucksport, Maine.

Tax Map-Lot	Property Owner	Mailing Address	Mailing T/S/Z
TM 039-001	Peter Bates Moseley	231 Main St, Apt 6	North Easton, MA 02356
TM 039-002	AIM Demolition USA LLC	PO Box 1874	Bucksport, ME 04416
TM 039-006	Janice E. Winchester	PO Box 29	East Orland, ME 04431
TM 039-006-1	Richard Ferland Julie Lynch	PO Box 59	East Orland, ME 04431
TM 039-006-A	Manuele Verdi Sheila Rothenberg	61 Saint Marks Place, Unit 1A	New York, NY 10003
TM 039-007	State of Maine, Dept of Conservation		Augusta, ME 04333
TM 039-008	John E. Harris, Jr.	12 Industrial Road	Ellsworth, ME 04605
TM 039-008-A	Elmer McAuliffe Debora McAuliffe	PO Box 590	Winterport, ME 04496
TM 039-009	Ray Lambert Sandra Lambert	PO Box 49	East Orland, ME 04431
TM 039-010	Ray Lambert Sandra Lambert	PO Box 49	East Orland, ME 04431
TM 039-012-A	Shirley H. Dexter Robert H. Dexter	14210 Wild Turkey Lane	Thonotosassa, FL 33592
TM 039-016	Phillip H. Osborne Vickie J. Osborne	PO Box 430	Orland, ME 04472
TM 039-017	Nancy J. Carter Reginald P. Carter, Jr.	12 Back Ridge Road	Orland, ME 04472
TM 040-002	Kevin Sedgwick Sarah Sedgwick	1136 Eastern Avenue	Holden, ME 04429
TM 040-003	Patricia A. Noonan William J. Noonan, JR.	8 Kings Court	Broad Brook, CT 06016
TM 040-004	Sylvia L. Mooney Joyce M. Mooney	29 Wood Street	Bangor, ME 04401
TM 040-005	David Redman Lynn Redman	PO Box 168	East Orland, ME 04431
TM 040-006	Donald & Lori Rumney Living Trust	PO Box 91	East Orland, ME 04431
TM 040-007	Helen J. Lewis 1998 Trust, Dated April 17, 1998	20 Bartlett Dr Apt. 104	Rockland, ME 04841

TM 040-008	William R. Martin Janet Martin	3017 Princess Anne Crescent	Chesapeake, VA 23321
TM 040-009	Donald J. Driscoll Corinne E. Driscoll	1305 Toddy Pond Road	Surry, ME 04684
TM 040-011	Pelletier Living Trust	PO Box 274	Hulls Cove, ME 04644
TM 040-012	Richard L. Tennant, Jr	211 US Route 1	Bucksport, ME 04416
TM 040-013	Ray H. Davis, Jr. Elizabeth A. Davis	92 Violette Way	Orland, ME 04472
TM 040-013-A	Ray H. Davis Elizabeth A. Davis	PO Box 82	East Orland, ME 04431
TM 040-014	Richard Wright Michelle Loiselle	PO Box 593	Blue Hill, ME 04614
TM 040-015	Heirs of Susan J. Violette Larry J. Violette, Jr. PR	17 Garland Road	Ellsworth, ME 04605
TM 040-016	Kevin W. Curran Rhonda L. Curran	PO Box 337	Orland, ME 04472
TM 040-017	Carolyn P. Bennett Irrevocable Trust c/o Jason Bennett, Trustee	32 Cedar Street	Bucksport, ME 04416
TM 040-018	Bryant A. A. Ciomei	43 N. Stonington Road	Stonington, ME 04681
TM 040-019	Patricia S. Grant Nicholas G. Grant	15 Maebelle Avenue	Bar Harbor, ME 04609
TM 040-020	Jon Thompson Rebecca Thompson	435 Eastern Road	Warren, ME 04864
TM 041-001	Jon Thompson Rebecca Thompson	435 Eastern Road	Warren, ME 04864
TM 041-002	Patricia E. Betts-Levine et als	348 Betts Road	Orrington, ME 04474
TM 041-003	Nancy J. Lord	PO Box 537	Bucksport, ME 04416
TM 041-004	Lynn M. Augustine Lawrence H. Augustine	PO Box 98	Orland, ME 04472
TM 041-005	Donna M. Violette	PO Box 24	Orland, ME 04472
TM 041-006	Robert G. Violette Barbara A. Violette	PO Box 182	East Orland, ME 04431
TM 041-007	Kenneth J. Nelson	168 Violette Way	Orland, ME 04472
TM 041-007-A	Lenny M. Lawson Marilyn E. Lawson	PO Box 1663	Blue Hill, ME 04614
TM 041-007-A1	Connie M. Fish	285 Bucksmills Road	Bucksport, ME 04416

TM 041-008	Elizabeth J. Cutler	PO Box 806	Bar Harbor, ME 04609
TM 041-009	David A. Cuthbertson	PO Box 224	East Orland, ME 04431
TM 041-010	Terrie L. Perrine	PO Box 142	East Orland, ME 04431
TM 041-011	Philip Tardif Living Trust	PO Box 81	Penobscot, ME 04476
TM 041-012	Lorre Webster Ames	PO Box 112	Bucksport, ME 04416
TM 041-013	Michael A. Astbury et al	PO Box 91	Blue Hill, ME 04614
TM 042-001	Dwayne L. Carter	168 Pond Shore Way	Orland, ME 04472
TM 042-002	Margaret Thursland	133 Luray Avenue	Front Royal, VA 22630
TM 042-003	Terance J. Ashe Gloria S. Ashe	333 East Side Drive	Verona, ME 04416
TM 042-004	Melissa Ann Tweedie Marcus Paul Tweedie	10 Elijah Lane	Orland, ME 04472
TM 042-005	Ann Cleveland Edwin Alan Verde	PO Box 540	Castine, ME 04421
TM 042-006	Stephen C. Gray Lennie D. Gray	95 Jordan Avenue	Brunswick, ME 04011
TM 042-008	Basil A. Gross et al c/o Basil Upton	128 Pond Shore Way	Orland, ME 04472
TM 043-001	Belinda L. Overman	40 Britton Road	Stockton, NJ 08559
TM 043-002	Darren J. Shute	6 McKenney Road	Stockton Springs, ME 04981
TM 043-003	Darren J. Shute	6 McKenney Road	Stockton Springs, ME 04981
TM 043-004	Dmitry Isakbayev Oksana Isakbayev	7470 Bronson Way	Cumming, GA 30041
TM 043-005	Jacques Revocable Trust	626 Silver Lake Road	Bucksport, ME 04416
TM 043-006	Dagostino Trust c/o J. Dagostino Trustee	20 Rosebud Lane	Brewer, ME 04412
TM 043-007	John B. Halberstadt Penny S. Halberstadt	204 Falcon Drive	Kennett Square, PA 19348
TM 043-007-A	Donald Baker, Jr. Dorothy Baker	PO Box 153	East Orland, ME 04431
TM 043-008	Dandaneau, Inc. c/o Knights of Columbus St. Vincent De Paul		Bucksport, ME 04416
TM 043-009	Donald Mark Baker Sarah Gail Baker	21 Rokie Way	Orrington, ME 04474
TM 043-009-A	Dale L. Carter Gail D. Carter	PO Box 488	Blue Hill, ME 04614
TM 043-010-A	Not Listed		

TM 043-011	John Halberstadt, Jr. Susan Halberstadt	56 Fogg Road	Readfield, ME 04355
TM 043-012	R. DiMartino Nancy A. McWhorter	14 Lenhome Drive	Cranford, NJ 07016
TM 043-013	Donald Mark Baker Sarah Gail Baker	21 Rokie Way	Orrington, ME 04474
TM 046-016	Robert R. Harriman Elaine L. Harriman	4 Maura Court	Waterville, ME 04901
TM 046-017	Robert R. Harriman Elaine L. Harriman	4 Maura Court	Waterville, ME 04901
TM 046-017-1	Kevin B. Tilton	1243 Acadia Highway	Orland, ME 04472
TM 046-019	Kevin B. Tilton	1243 Acadia Highway	Orland, ME 04472
TM 046-019-A	Hautepoint, LLC	105 Arlington Road	Paoli, PA 19301
TM 046-023-1	Gerald D. Heath Katherine A. Heath	PO Box 83	East Orland, ME 04431
TM 046-023-2	Dana A. Doane, Jr. Carrie L. Doane	690 Acadia Highway	Orland, ME 04472
TM 046-023-3	Ellery W. Bouchard May B. Bouchard	PO Box 84	East Orland, ME 04431
TM 046-023-4	Johnson Living Trusts	PO Box 55	East Orland, ME 04431
TM 046-023-5	Margaret Rybczyk Francis Rybczyk	PO Box 274	Orland, ME 04472
TM 046-023-6	Sadie Alley Ferreira Jonathan Ferreira	43 Evergreen Way	Orland, ME 04472
TM 046-023-7	Dean Martin Sharon Martin	PO Box 6	Orland, ME 04472
TM 046-024	Shelby H. Silvernail 2014 Declaration of Trust	471 Hastings Road	Lake Forest, IL 60045
TM 046-025	Shelby H. Silvernail 2014 Declaration of Trust	471 Hastings Road	Lake Forest, IL 60045
TM 046-026	Estate of Margaret Parker	318 Haverhill Street	N. Reading, MA 01864
TM 047-001	Joseph V. Pacileo Elizabeth A. Pacileo	8826 Warm Granite Drive	Columbia, MD 21045
TM 047-001-A	Heather L. Treneer Jeremy J. Treneer	111 Bayview Street	Camden, ME 04843
TM 047-002	Dennis J. Castonguay Suzanne R. Castonguay	PO Box 172	East Orland, ME 04431
TM 047-003	E. Bruce Carlsten Dorothy Q. Carlsten	85 Highland Road	Bristol, RI 02809

TM 047-004	James L. Lemieux	PO Box 1598	Bucksport, ME 04416
TM 047-005	Jean R. Goss Judith L. Findlay	41 Cove Street	Brewer, ME 04412
TM 047-006	Gregory P. Hawes Meagan W. Hawes	PO Box 221	Holden, ME 04429
TM 047-007	Tara Millicent Taylor	513 Fernon Street	Philadelphia, PA 19148
TM 047-008	L. Donna Hoffman	PO Box 92	Bucksport, ME 04416
TM 047-009	Bradley S. Moll	156 West Elm Street	Yarmouth, ME 04096
TM 047-010	Scott Findlay Kathleen Findlay	177 Silver Lake Road	Bucksport, ME 04416
TM 047-011	Scott Findlay Kathleen Findlay	177 Silver Lake Road	Bucksport, ME 04416
TM 047-012	Bernard C. Rump K. E. Mushrall	19 Ring Woods	Orrington, ME 04474
TM 047-013	Richard Whelan, Jr. William Whelan Holly Jean Whelan	15 Crescent Avenue	Norwood, MA 02062
TM 047-014	Mark L. Fowler Laurie A. Fowler	PO Box 83	Orland, ME 04472
TM 047-015	Alayne M. Perkins	1006 River Road	Bucksport, ME 04416
TM 047-016	Manuel Trust	51 Crescent Street	Skowhegan, ME 04976
TM 047-017	William R. Redman Karen A. Redman	PO Box 300	Bucksport, ME 04416
TM 047-018	Gary W. Redman Helen D. Redman	13 Allen Lane	Verona, ME 04416
TM 048-001	Diane H. Barlow et al.	15 Cross Road	Orland, ME 04472
TM 048-003	St. Francis Community	PO Box 44	East Orland, ME 04431
TM 048-005	Gloria Britto Gary Hatch	3 Halet Avenue	Rockland, ME 04841
TM 048-006	Michael C. Jacques	626 Silver Lake Road	Bucksport, ME 04416
TM 048-006-A	Lois J. Barrows	4560 Alder Drive	Port Orange, FL 32127
TM 048-006-B	McKee Timberlands LLC	4201 Aftonshire Drive	Wilmington, NC 28412
TM 048-007	John M. Jaser K. Larkin Jaser	33 Hawley Avenue	Milford, CT 06460
TM 049-001	Robert F. Wiswell, Jr.	140 Roundabout Way	Orland, ME 04472
TM 049-002	Liam O. Riordan S. Thibedeau Riordan	149 Fountain Street	Bangor, ME 04401
TM 049-003	Robert Bishop Jane Bishop	93 Fairwind Drive	Orrington, ME 04474

TM 049-005	Slepp Trusts c/o Elizabeth Ziolkowski	743 Iron Latch Road	Franklin Lakes, NJ 07417
TM 049-006	Martha Mikkelson et al	2708 Tillett Road	Roanoke, VA 24015
TM 049-007	Gordon E. Howard Daniel S. Howard	741 Range Road	Blue Hill, ME 04614
TM 049-008	Christopher W. Parsons Lisa L. Parsons	187 Walker Road	Lamoine, ME 04605
TM 049-009	SRB Properties, LLC	329 Main Street, Apt C	Bar Harbor, ME 04609
TM 049-010	Aline L. Jacques	626 Silver Lake Road	Bucksport, ME 04416
TM 049-011	Ingrid H. Perkins	117 Buck Street	Bangor, ME 04401
TM 050-001	Ingrid H. Perkins	117 Buck Street	Bangor, ME 04401
TM 050-002	Kenneth A. Wilmot Gail D. Wilmot	PO Box 45	Orland, ME 04472
TM 050-003	Poddy Tond, LLC	1076 Norway Road	Glenburn, ME 04401
TM 050-004	Sarah Guerette Christopher Strout et als	68 Brentwood Street	Portland, ME 04103
TM 050-005	Katheryn Gundersen et als	16 Pojananchuck Way	Orland, ME 04472
TM 050-006	Jeremy Tyler Megan Tyler	38 Beech Hill Road	Blue Hill, ME 04614
TM 050-007	Kathy A. Gray Adele K. Simpson Bryan F. Simpson	32 Bayview Avenue	Bucksport, ME 04416
TM 050-008	Steven M. McWilliams, Trustee Kay A. McWilliams, Trustee	PO Box 700	Comanche, TX 76442
TM 050-009	Lary E. Davis Lynn M. Davis (f/k/a Joslin)	30 Guadalcanal Drive	Brunswick, ME 04011
TM 050-010	Betsey Peters Epstein Daniel Epstein	235 West 76th St. Apt 2B	New York, NY 10023
TM 050-011	Eugene R. Merry	20 Neil Way	Orland, ME 04472
TM 050-012	Brenda Norwood (f/k/a Campbell)	17 Maple Ridge Drive	Bucksport, ME 04416
TM 050-013	Brenda Norwood (f/k/a Campbell)	17 Maple Ridge Drive	Bucksport, ME 04416
TM 050-014	Robin Carter Hilary E. C. Grimes Madeline J. Grimes et al	PO Box 100	East Orland, ME 04431

TM 050-015	Eugene R. Merry April McLaughlin-Merry	20 Neil Way	Orland, ME 04472
TM 050-016	Kent Conary Donna Conary	1589 Acadia Highway	Orland, ME 04472
TM 050-017	James A. Gaspar Diane D. Gaspar	220 Conary Way	Orland, ME 04472
TM 050-018	Bruce R. Schober Andrea Schober	PO Box 334	Orland, ME 04472
TM 050-019	Daniel Guerette Phyllis Guerette	35 Crestview Drive	Portland, ME 04103
TM 051-001	Dennis Lewin	PO Box 85	Orland, ME 04472
TM 051-002	Denise Weser Peter N. Weser	13 Loon Way	Orland, ME 04472
TM 051-003	Thomas Lentilhon	104 N Main Street	South Deerfield, MA 01373
TM 051-004	Allan G. Snell Cheryl M. Snell	371 Snows Corner Road	Orrington, ME 04474
TM 051-005	Sean S. Harriman Robert E. Harriman, Jr.	PO Box 1657	Bucksport, ME 04416
TM 051-006	Alice P. Hearn et al	115 Longfellow Drive	Lancaster, PA 17602
TM 051-007	Alice P. Hearn et al	115 Longfellow Drive	Lancaster, PA 17602
TM 051-008	David F. Vroom Vicki P. Vroom	35 Brentwood Avenue	Bangor, ME 04401
TM 051-009	David F. Vroom Vicki P. Vroom	35 Brentwood Avenue	Bangor, ME 04401
TM 051-010	David Donley	386 North Main Street	West Lebanon, NH 03784
TM 051-011	Bernadette Dempsy	PO Box 244	Blue Hill, ME 04614
TM 051-012	David Marker Gladys Bat	6048 25th Road N	Arlington, VA 22207
TM 051-013	Porter Enterprises, LLC	5 Ash Road	Dedham, ME 04429
TM 051-014	Robert W. Field, Jr. Revocable Living Trust	PO Box 76	Dunkirk, MD 20754
TM 051-015	Carol A. Donnelly Gary R. Field William F. Field	PO Box 91	Surry, ME 04684
TM 051-016	Eugene M. Berry Donna R. Berry	PO Box 225	Orland, ME 04472
TM 051-017	Eugene M. Berry Donna R. Berry	PO Box 225	Orland, ME 04472
TM 051-018-1	Michael T. Paige Ellen C. Paige	327 Surry Road	Orland, ME 04472

TM 051-018-D	James Davis Carrie Davis	660 Sunset Drive	Naperville, IL 60540
TM 051-018-E	Davis Revocable Trust Nina C. Davis Dadian Revocable Trust	72 Freilino Way	Orland, ME 04472
TM 051-019	Christine C. Malinowski Peter S. Malinowski	99 Bens Hill Road	Sabattus, ME 04280
TM 051-020 & 21	The Dullea Family Revocable Trust	46 Whiteley Drive	Dover, NH 03820
TM 051-022	David C. Wilson	PO Box 20	East Orland, ME 04431
TM 051-023	Richard V. Wardwell Annemarie N. Wardwell	13939 Deanna Drive	Belleville, MI 48111
TM 051-023-A	Andrew Zwycart Wilma Zwycart	PO Box 204	Cutler, ME 04626
TM 006-055	Andrew I. McKinnon	235 French Street	Bangor, ME 04401
TM 036-034	AIM Demolition USA LLC	PO Box 1874	Bucksport, ME 04416
TM 036-036	Andrew I. McKinnon	235 French Street	Bangor, ME 04401
TM 038-012	Richard D. Gilley Lauralee Gilley	PO Box 118	East Orland, ME 04431
TM 038-014	Mary M. Ford Edwin F. Parsons, III	640 Register Avenue	Baltimore, MD 21212
TM 038-015	E. Joy Russell Will L. Russell, Jr.	PO Box 13	East Orland, ME 04431
TM 038-015-A	E. Joy Russell Will L. Russell, Jr.	PO Box 13	East Orland, ME 04431
TM 038-016	Frederick Oldfield Patricia Oldfield c/o Paul Oldfield	125 Allen Street	Bangor, ME 04401

U.S. Postal Service™

KAJ 53420-2

CERTIFIED MAIL® RECEIPT

BSSN

Domestic Mail Only

For delivery information, visit our website at www.usps.com®.

OFFICIAL USE

Certified Mail Fee

\$ 4.40

Extra Services & Fees (check box, add fee as appropriate)

- Return Receipt (hardcopy) \$ 3.65
- Return Receipt (electronic) \$ _____
- Certified Mail Restricted Delivery \$ _____
- Adult Signature Required \$ _____
- Adult Signature Restricted Delivery \$ _____

Postage

\$.64

Total Postage and Fees

\$ 8.69

Sent To

Street

City, St

Penobscot Tribal Nation
 12 Wabanaki Way
 Indian Island, Maine 04468

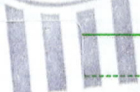

7017 0190 0000 2712 2T22 0000 0610 2102

U.S. Postal Service™

KAJ 53420-2

CERTIFIED MAIL® RECEIPT

Domestic Mail Only

BSSN

For delivery information, visit our website at www.usps.com®.

OFFICIAL USE

Certified Mail Fee

\$ 4.40

Extra Services & Fees (check box, add fee as appropriate)

- Return Receipt (hardcopy) \$ 3.65
- Return Receipt (electronic) \$ _____
- Certified Mail Restricted Delivery \$ _____
- Adult Signature Required \$ _____
- Adult Signature Restricted Delivery \$ _____

Postage

\$.64

Total Postage and Fees

\$ 8.69

Sent To

Street at

City, Sta

PS For

Town of Orland
PO Box 67
Orland, Maine 04472

Page 36

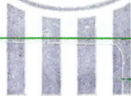

uctions

2166 2122 0000 0610 4102

U.S. Postal Service™ **CERTIFIED MAIL® RECEIPT**

Domestic Mail Only

KAJ 53420-2

BSSN

For delivery information, visit our website at www.usps.com®.

OFFICIAL USE

Certified Mail Fee

\$ 4.40

Extra Services & Fees (check box, add fee as appropriate)

- Return Receipt (hardcopy) \$ 3.65
- Return Receipt (electronic) \$
- Certified Mail Restricted Delivery \$
- Adult Signature Required \$
- Adult Signature Restricted Delivery \$

Postage

\$.64

Total Postage and Fees

\$ 5.09

Sent To

Street or

Great Pond Mtn Conservation Trust

City, Sta

PO Box 338

Bucksport, ME 04416



Page 37

7202 1670 0001 0064 6611

U.S. Postal Service™

KAJ 53420-2

CERTIFIED MAIL® RECEIPT

Domestic Mail Only

BSSN

For delivery information, visit our website at www.usps.com®.

OFFICIAL USE

Certified Mail Fee

\$ 4.40

Extra Services & Fees (check box, add fee as appropriate)

- Return Receipt (hardcopy) \$ 3.65
- Return Receipt (electronic) \$ _____
- Certified Mail Restricted Delivery \$ _____
- Adult Signature Required \$ _____
- Adult Signature Restricted Delivery \$ _____

Postage

\$.64

Total Postage and Fees \$ 8.69

Sent To

Street a

City, St.

Frenchman Bay Conservancy

PO Box 150

Hancock ME 04640-0150



7017 0190 0000 2712 0000 0610 4101 6698 2122

U.S. Postal Service™
CERTIFIED MAIL® RECEIPT
Domestic Mail Only

KAT 53420-2
BSSN

For delivery information, visit our website at www.usps.com®.

OFFICIAL USE

Certified Mail Fee

\$ 4.40

Extra Services & Fees (check box, add fee as appropriate)

- Return Receipt (hardcopy) \$ 3.65
- Return Receipt (electronic) \$
- Certified Mail Restricted Delivery \$
- Adult Signature Required \$
- Adult Signature Restricted Delivery \$

Postage

\$ -64

Total Postage and Fees

\$ 8.69

Sent To

Street

City, St

Trout Unlimited
1700 N Moore Bldg Suite 2005
Arlington, VA 22209-2793



5399 4900 7000 029T 2202

U.S. Postal Service™

KAJ 53420-2

CERTIFIED MAIL® RECEIPT

Domestic Mail Only

BSSN

For delivery information, visit our website at www.usps.com®.

OFFICIAL USE

Certified Mail Fee \$ 4.40

Extra Services & Fees (check box, add fee as appropriate)

- Return Receipt (hardcopy) \$ 3.65
- Return Receipt (electronic) \$ _____
- Certified Mail Restricted Delivery \$ _____
- Adult Signature Required \$ _____
- Adult Signature Restricted Delivery \$ _____

Postage \$.64

Total Postage and Fees \$ 8.69

Sent To _____

Street _____

City, State _____

PS Fo _____



Conservation League
 Page 40
 53 Exchange St., #200
 Portland, ME 04101

8299 4900 1000 0291 2202

U.S. Postal Service™

KAJ 53420-2

CERTIFIED MAIL® RECEIPT

Domestic Mail Only

BSSN

For delivery information, visit our website at www.usps.com®.

OFFICIAL USE

Certified Mail Fee 4.40
\$

Extra Services & Fees (check box, add fee as appropriate)

- Return Receipt (hardcopy) \$ 3.65
- Return Receipt (electronic) \$ _____
- Certified Mail Restricted Delivery \$ _____
- Adult Signature Required \$ _____
- Adult Signature Restricted Delivery \$ _____

Postage 1.64
\$

Total Postage and Fees 8.69
\$

Sent To
Street a
City, St
Hancock County
50 State Street
Ellsworth, ME 04605



6599 4900 1000 0291 2202

U.S. Postal Service™

KAJ 53420-2

CERTIFIED MAIL® RECEIPT

Domestic Mail Only

BSSN

For delivery information, visit our website at www.usps.com®.

OFFICIAL USE

Certified Mail Fee

\$

4.40

Extra Services & Fees (check box, add fee as appropriate)

- Return Receipt (hardcopy) \$ 3.65
- Return Receipt (electronic) \$ _____
- Certified Mail Restricted Delivery \$ _____
- Adult Signature Required \$ _____
- Adult Signature Restricted Delivery \$ _____

Postage

\$

.64

Total Postage and Fees

\$

8.69

Sent T

Street

City, S

Natural Resources Council of Maine
 PO Box 1048 Page 42
 Farmington 04938-1048

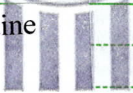

2499 4900 T000 029T 2202

U.S. Postal Service™

CERTIFIED MAIL® RECEIPT

Domestic Mail Only

KAT 53420-2

BSSN

For delivery information, visit our website at www.usps.com®.

OFFICIAL USE

Certified Mail Fee

\$

4.40

Extra Services & Fees (check box, add fee as appropriate)

- Return Receipt (hardcopy) \$ 3.65
- Return Receipt (electronic) \$ _____
- Certified Mail Restricted Delivery \$ _____
- Adult Signature Required \$ _____
- Adult Signature Restricted Delivery \$ _____

Postage

\$

.64

Total Postage and Fees

\$

9.69

Sent To

Street

City, St

Atlantic Salmon Federation
P.O. Box 807
Calais, ME 04619-0807

Page 43

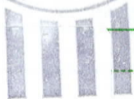

466 272 000 0610 2102

U.S. Postal Service™

CERTIFIED MAIL® RECEIPT

Domestic Mail Only

KAJ 53420-2

BSSN

For delivery information, visit our website at www.usps.com®.

OFFICIAL USE

Certified Mail Fee

4.40

\$

Extra Services & Fees (check box, add fee as appropriate)

- Return Receipt (hardcopy) \$ 3.65
- Return Receipt (electronic) \$ _____
- Certified Mail Restricted Delivery \$ _____
- Adult Signature Required \$ _____
- Adult Signature Restricted Delivery \$ _____

Postage

.64

\$

Total Postage and Fees

8.69

\$

Sent To

Street

City, State

Town of Bucksport
 P.O. Box X
 Bucksport, ME 04416

Page 44

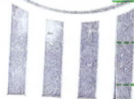

6266 2722 0000 0610 2102

U.S. Postal Service™

CERTIFIED MAIL® RECEIPT

Domestic Mail Only

KAJ 53420-2

BSSN

For delivery information, visit our website at www.usps.com®.

OFFICIAL USE

Certified Mail Fee

4.40

\$

Extra Services & Fees (check box, add fee as appropriate)

- Return Receipt (hardcopy) \$ 3.65
- Return Receipt (electronic) \$ _____
- Certified Mail Restricted Delivery \$ _____
- Adult Signature Required \$ _____
- Adult Signature Restricted Delivery \$ _____

Postage

.64

\$

Total Postage and Fees

8.09

\$

Sent

Street

City

Maine Department of Inland Fisheries & Wildlife

41 State House

Augusta, ME 04333-0041



0546 2722 0000 0610 2102

PS F

structions

U.S. Postal Service™

CERTIFIED MAIL® RECEIPT

Domestic Mail Only

KAJ 53420-2

BSSN

For delivery information, visit our website at www.usps.com®.

OFFICIAL USE

Certified Mail Fee

\$

4.40

Extra Services & Fees (check box, add fee as appropriate)

- Return Receipt (hardcopy) \$ 3.65
- Return Receipt (electronic) \$
- Certified Mail Restricted Delivery \$
- Adult Signature Required \$
- Adult Signature Restricted Delivery \$

Postage

\$

.64

Total Postage and Fees

\$

8.69

Sent

Street

City, State

PS Form

Maine Emergency Management Agency

72 State House Station

45 Commerce Drive

Augusta, Maine 04333



Instructions

9666 2722 0000 0670 7707

Bernstein, Shur,
Sawyer & Nelson, P.A.
100 Middle Street
PO Box 9729
Portland, ME 04104-5029

7017 0190 0000 2712 3950
7017 0190 0000 2712 3950

CERTIFIED MAIL

U.S. Postal Service™ **KAJ 53420-2**
CERTIFIED MAIL® RECEIPT
Domestic Mail Only **BSSN**

For delivery information, visit our website at www.usps.com

OFFICIAL USE

Certified Mail Fee \$	
Extra Services & Fees (check box, add fee as appropriate)	
<input type="checkbox"/> Return Receipt (hardcopy) \$	
<input type="checkbox"/> Return Receipt (electronic) \$	
<input type="checkbox"/> Certified Mail Restricted Delivery \$	
<input type="checkbox"/> Adult Signature Required \$	
<input type="checkbox"/> Adult Signature Restricted Delivery \$	
Postage \$	
Total Postage and Fees \$	
Sent To Street City, State	Maine Department of Inland Fisheries & Wildlife 41 State House Station Augusta, ME 04333-0041

Postmark Here

PS Form 3800, April 2004 PSN 7530-02-000-9000 See Reverse for Instructions

Bernstein, Shur,
Sawyer & Nelson, P.A.
100 Middle Street
PO Box 9729
Portland, ME 04104-5029

7017 0190 0000 2712 3943
7017 0190 0000 2712 3943

CERTIFIED MAIL

U.S. Postal Service™ **KAJ 53420-2**
CERTIFIED MAIL® RECEIPT
Domestic Mail Only **BSSN**

For delivery information, visit our website at www.usps.com

OFFICIAL USE

Certified Mail Fee \$	
Extra Services & Fees (check box, add fee as appropriate)	
<input type="checkbox"/> Return Receipt (hardcopy) \$	
<input type="checkbox"/> Return Receipt (electronic) \$	
<input type="checkbox"/> Certified Mail Restricted Delivery \$	
<input type="checkbox"/> Adult Signature Required \$	
<input type="checkbox"/> Adult Signature Restricted Delivery \$	
Postage \$	
Total Postage and Fees \$	
Sent To Street City, State	Atlantic Salmon Federation P.O. Box 807 Calais, ME 04619-0807

Postmark Here

PS Form 3800, April 2004 PSN 7530-02-000-9000 See Reverse for Instructions

Bernstein, Shur,
Sawyer & Nelson, P.A.
100 Middle Street
PO Box 9729
Portland, ME 04104-5029



CERTIFIED MAIL



7017 0190 0000 2712 3929
7017 0190 0000 2712 3929

U.S. Postal Service™ **KAJ 53420-2**
CERTIFIED MAIL® RECEIPT
Domestic Mail Only **BSSN**

For delivery information, visit our website at www.usps.com

OFFICIAL USE

Certified Mail Fee	
\$	
Extra Services & Fees (check box, add fee as appropriate)	
<input type="checkbox"/> Return Receipt (hardcopy) \$	
<input type="checkbox"/> Return Receipt (electronic) \$	
<input type="checkbox"/> Certified Mail Restricted Delivery \$	
<input type="checkbox"/> Adult Signature Required \$	
<input type="checkbox"/> Adult Signature Restricted Delivery \$	
Postage	
\$	
Total Postage and Fees	
\$	
Sent	
Street	Town of Bucksport
City, State	P.O. Box X
	Bucksport, ME 04416

PS Form 3800, September 2008 Edition Instructions

Postmark
Here

Bernstein, Shur,
Sawyer & Nelson, P.A.
100 Middle Street
PO Box 9729
Portland, ME 04104-5029



CERTIFIED MAIL

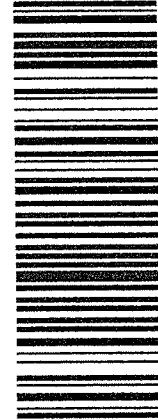

7017 0190 0000 2712 3936
7017 0190 0000 2712 3936

U.S. Postal Service™ **KAJ 53420-2**
CERTIFIED MAIL® RECEIPT
Domestic Mail Only **BSSN**

For delivery information, visit our website at www.usps.com

OFFICIAL USE

Certified Mail Fee	
\$	
Extra Services & Fees (check box, add fee as appropriate)	
<input type="checkbox"/> Return Receipt (hardcopy) \$	
<input type="checkbox"/> Return Receipt (electronic) \$	
<input type="checkbox"/> Certified Mail Restricted Delivery \$	
<input type="checkbox"/> Adult Signature Required \$	
<input type="checkbox"/> Adult Signature Restricted Delivery \$	
Postage	
\$	
Total Postage and Fees	
\$	
Sent	Maine Emergency Management Agency
Street	72 State House Station
City, State	45 Commerce Drive
	Augusta, Maine 04333

PS Form 3800, September 2008 Edition Instructions

Postmark
Here

Bernstein, Shur,
Sawyer & Nelson, P.A.
100 Middle Street
PO Box 9729
Portland, ME 04104-5029

CERTIFIED MAIL



7022 1670 0001 0064 6611
7022 1670 0001 0064 6611

U.S. Postal Service™ KAJ 53420-2 CERTIFIED MAIL® RECEIPT Domestic Mail Only BSSN	
For delivery information, visit our website at www.usps.com ®	
OFFICIAL USE	
Certified Mail Fee \$ _____	Postmark Here
Extra Services & Fees (check box, add fee as appropriate)	
<input type="checkbox"/> Return Receipt (hardcopy) \$ _____	
<input type="checkbox"/> Return Receipt (electronic) \$ _____	
<input type="checkbox"/> Certified Mail Restricted Delivery \$ _____ <input type="checkbox"/> Adult Signature Required \$ _____ <input type="checkbox"/> Adult Signature Restricted Delivery \$ _____	
Postage \$ _____	
Total Postage and Fees \$ _____	
Sent To _____	
Street or _____	
City, State _____	
Bucksport, ME 04416	
PS Form 3800, January 2002 (PSN 7530-02-000-9000) Use reverse for instructions	

CERTIFIED MAIL

Bernstein, Shur,
Sawyer & Nelson, P.A.
100 Middle Street
PO Box 9729
Portland, ME 04104-5029



7017 0190 0000 2712 3899
7017 0190 0000 2712 3899

U.S. Postal Service™ KAJ 53420-2 CERTIFIED MAIL® RECEIPT Domestic Mail Only BSSN	
For delivery information, visit our website at www.usps.com ®	
OFFICIAL USE	
Certified Mail Fee \$ _____	Postmark Here
Extra Services & Fees (check box, add fee as appropriate)	
<input type="checkbox"/> Return Receipt (hardcopy) \$ _____	
<input type="checkbox"/> Return Receipt (electronic) \$ _____	
<input type="checkbox"/> Certified Mail Restricted Delivery \$ _____ <input type="checkbox"/> Adult Signature Required \$ _____ <input type="checkbox"/> Adult Signature Restricted Delivery \$ _____	
Postage \$ _____	
Total Postage and Fees \$ _____	
Sent To _____	
Street or _____	
City, State _____	
Frenchman Bay Conservancy PO Box 150 Hancock ME 04640-0150	
PS Form 3800, January 2002 (PSN 7530-02-000-9000) Use reverse for instructions	

Bernstein, Shur,
Sawyer & Nelson, P.A.
100 Middle Street
PO Box 9729
Portland, ME 04104-5029

CERTIFIED MAIL®



7017 0190 0000 2712 3912
7017 0190 0000 2712 3905

U.S. Postal Service™ **KAJ 53420-2**
CERTIFIED MAIL® RECEIPT
Domestic Mail Only **BSSN**

For delivery information, visit our website at www.usps.com®

OFFICIAL USE

Certified Mail Fee	\$	Postmark Here
Extra Services & Fees (check box, add fee as appropriate)		
<input type="checkbox"/> Return Receipt (hardcopy)	\$	
<input type="checkbox"/> Return Receipt (electronic)	\$	
<input type="checkbox"/> Certified Mail Restricted Delivery	\$	
<input type="checkbox"/> Adult Signature Required	\$	
<input type="checkbox"/> Adult Signature Restricted Delivery	\$	
Postage	\$	
Total Postage and Fees	\$	
Sent To		
Street	Penobscot Tribal Nation	
City, State	12 Wabanaki Way	
ZIP Code	Indian Island, Maine 04468	

PS Form 3800, October 2009 (Rev. 10/09) See reverse side for instructions

Bernstein, Shur,
Sawyer & Nelson, P.A.
100 Middle Street
PO Box 9729
Portland, ME 04104-5029

CERTIFIED MAIL®



7017 0190 0000 2712 3912
7017 0190 0000 2712 3912

U.S. Postal Service™ **KAJ 53420-2**
CERTIFIED MAIL® RECEIPT
Domestic Mail Only **BSSN**

For delivery information, visit our website at www.usps.com®

OFFICIAL USE

Certified Mail Fee	\$	Postmark Here
Extra Services & Fees (check box, add fee as appropriate)		
<input type="checkbox"/> Return Receipt (hardcopy)	\$	
<input type="checkbox"/> Return Receipt (electronic)	\$	
<input type="checkbox"/> Certified Mail Restricted Delivery	\$	
<input type="checkbox"/> Adult Signature Required	\$	
<input type="checkbox"/> Adult Signature Restricted Delivery	\$	
Postage	\$	
Total Postage and Fees	\$	
Sent To		
Street	Town of Orland	
City, State	PO Box 67	
ZIP Code	Orland, Maine 04472	

PS Form 3800, October 2009 (Rev. 10/09) See reverse side for instructions

Bernstein, Shur,
Sawyer & Nelson, P.A.
100 Middle Street
PO Box 9729
Portland, ME 04104-5029



7022 1670 0001 0064 6635
7022 1670 0001 0064 6635

U.S. Postal Service™ KAJ 53420-2
CERTIFIED MAIL® RECEIPT
Domestic Mail Only BSSN

For delivery information, visit our website at www.usps.com®

OFFICIAL USE

Certified Mail Fee \$	Postmark Here
Extra Services & Fees (check box, add fee as appropriate)	
<input type="checkbox"/> Return Receipt (hardcopy) \$	
<input type="checkbox"/> Return Receipt (electronic) \$	
<input type="checkbox"/> Certified Mail Restricted Delivery \$	
<input type="checkbox"/> Adult Signature Required \$	
<input type="checkbox"/> Adult Signature Restricted Delivery \$	
Postage \$	
Total Postage and Fees \$	
Sent To Street: Trout Unlimited City, St: 1700 N Moore St, Suite 2005 Arlington, VA 22209-2793	

PS Form 3800, April 2013 PSN 7630-02-000-9047 See Reverse for Instructions

Bernstein, Shur,
Sawyer & Nelson, P.A.
100 Middle Street
PO Box 9729
Portland, ME 04104-5029



7022 1670 0001 0064 6628
7022 1670 0001 0064 6628

U.S. Postal Service™ KAJ 53420-2
CERTIFIED MAIL® RECEIPT
Domestic Mail Only BSSN

For delivery information, visit our website at www.usps.com®

OFFICIAL USE

Certified Mail Fee \$	Postmark Here
Extra Services & Fees (check box, add fee as appropriate)	
<input type="checkbox"/> Return Receipt (hardcopy) \$	
<input type="checkbox"/> Return Receipt (electronic) \$	
<input type="checkbox"/> Certified Mail Restricted Delivery \$	
<input type="checkbox"/> Adult Signature Required \$	
<input type="checkbox"/> Adult Signature Restricted Delivery \$	
Postage \$	
Total Postage and Fees \$	
Sent To Street: Conservation Law Foundation City, St: 53 Exchange St., #200 Portland, ME 04101	

PS Form 3800, April 2013 PSN 7630-02-000-9047 See Reverse for Instructions

**Bernstein, Shur,
Sawyer & Nelson, P.A.**
100 Middle Street
PO Box 9729
Portland, ME 04104-5029

CERTIFIED MAIL



7022 1670 0001 0064 6659
7022 1670 0001 0064 6659

U.S. Postal Service™ **CERTIFIED MAIL® RECEIPT**
Domestic Mail Only

KAT 53420-2
BSSN

For delivery information, visit our website at www.usps.com®.

OFFICIAL USE

Certified Mail Fee \$	Postmark Here
Extra Services & Fees (check box, add fee as appropriate)	
<input type="checkbox"/> Return Receipt (hardcopy) \$	
<input type="checkbox"/> Return Receipt (electronic) \$	
<input type="checkbox"/> Certified Mail Restricted Delivery \$	
<input type="checkbox"/> Adult Signature Required \$	
<input type="checkbox"/> Adult Signature Restricted Delivery \$	
Postage \$	
Total Postage and Fees \$	
Sent To	
Street	Hancock County
City, St	50 State Street Ellsworth, ME 04605

PS Form 3800, April 2015 PSN 7530-02-000-9047 See Reverse for Instructions

CERTIFIED MAIL

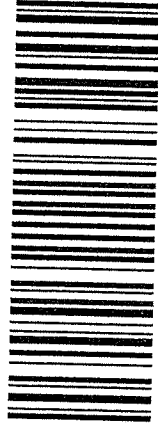

7022 1670 0001 0064 6642
7022 1670 0001 0064 6642

**Bernstein, Shur,
Sawyer & Nelson, P.A.**
100 Middle Street
PO Box 9729
Portland, ME 04104-5029

NNR

U.S. Postal Service™ **CERTIFIED MAIL® RECEIPT**
Domestic Mail Only

KAT 53420-2
BSSN

For delivery information, visit our website at www.usps.com®.

OFFICIAL USE

Certified Mail Fee \$	Postmark Here
Extra Services & Fees (check box, add fee as appropriate)	
<input type="checkbox"/> Return Receipt (hardcopy) \$	
<input type="checkbox"/> Return Receipt (electronic) \$	
<input type="checkbox"/> Certified Mail Restricted Delivery \$	
<input type="checkbox"/> Adult Signature Required \$	
<input type="checkbox"/> Adult Signature Restricted Delivery \$	
Postage \$	
Total Postage and Fees \$	
Sent To	
Street	Natural Resources Council of Maine
City, St	PO Box 1048 Farmington 04938-1048

PS Form 3800, April 2015 PSN 7530-02-000-9047 See Reverse for Instructions