

NOTE:
 1. COMPACT TRENCH BACKFILL IN 8" LIFTS TO AT LEAST 95% OF ITS MAXIMUM DRY DENSITY AS DETERMINED BY ASTM D-1557 "MODIFIED PROCTOR DENSITY".

STORMWATER TRENCH SECTION
 NO SCALE

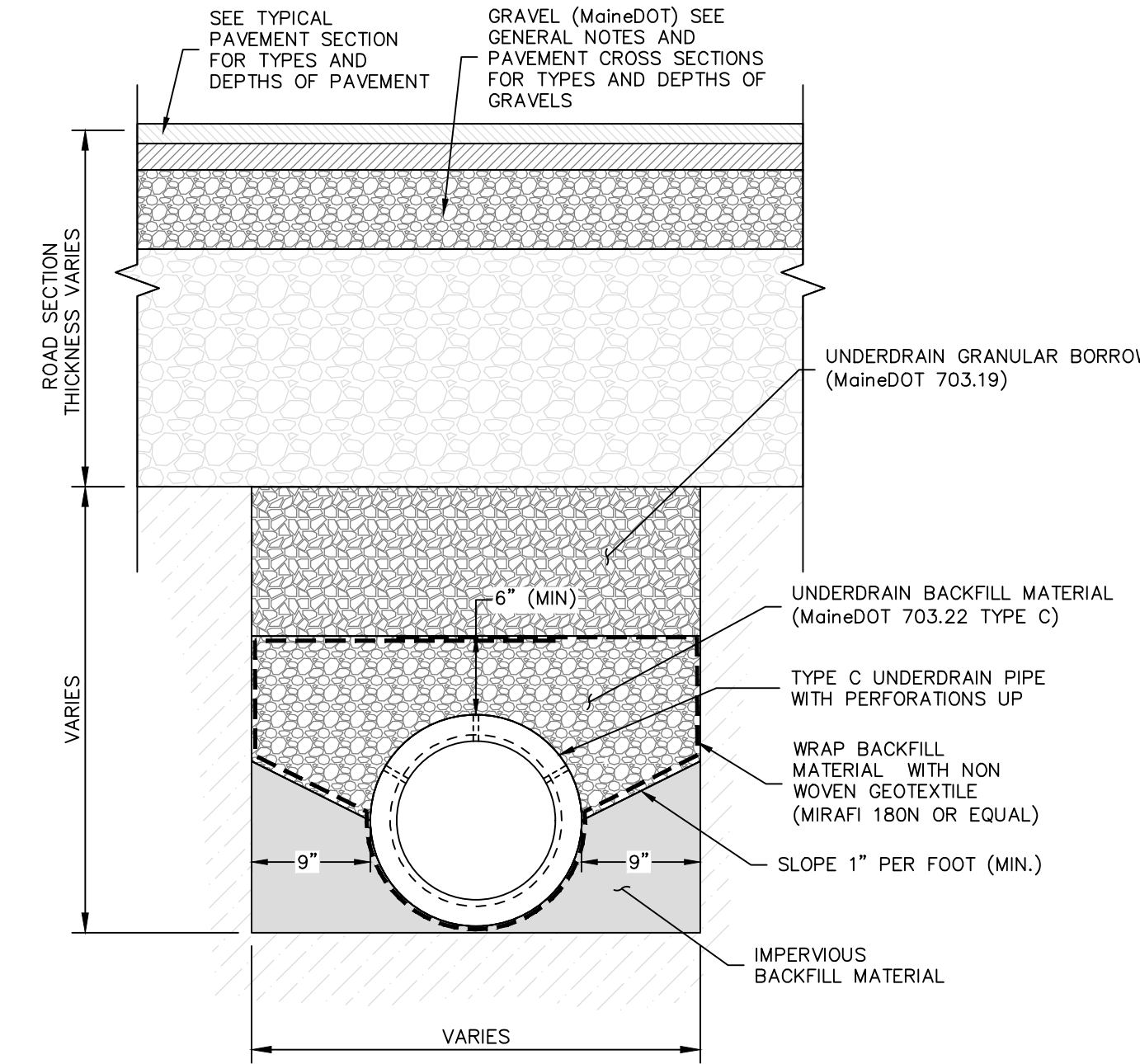

UNDERDRAIN GRANULAR BORROW FOR TYPE C: (MaineDOT 703.19)		UNDERDRAIN BACKFILL MATERIAL FOR TYPE C: (MaineDOT 703.22 TYPE C)	
SIEVE DESIGNATION	PERCENTAGE BY WEIGHT PASSING SQUARE MESH SIEVES	SIEVE DESIGNATION	PERCENTAGE BY WEIGHT PASSING SQUARE MESH SIEVES
1/2" INCH No. 200	0-70	1" INCH	100
	0-10.0	3/4" INCH	90-100
		3/8" INCH	0-75
		No. 4	0-25
		No. 10	0-5

TYPICAL TYPE C UNDERDRAIN TRENCH SECTION
 NO SCALE

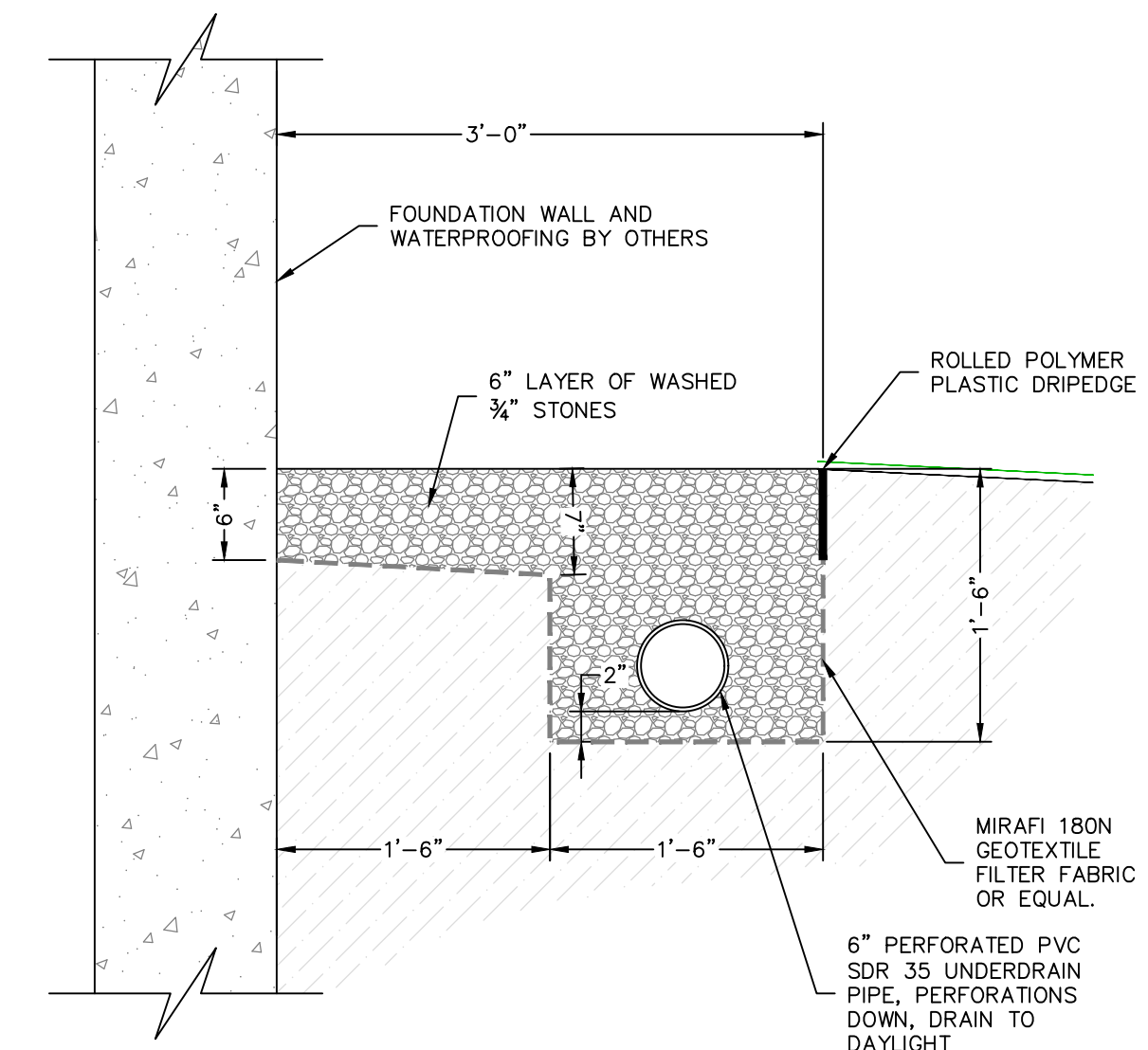

DRIP APRON DETAIL
 NO SCALE

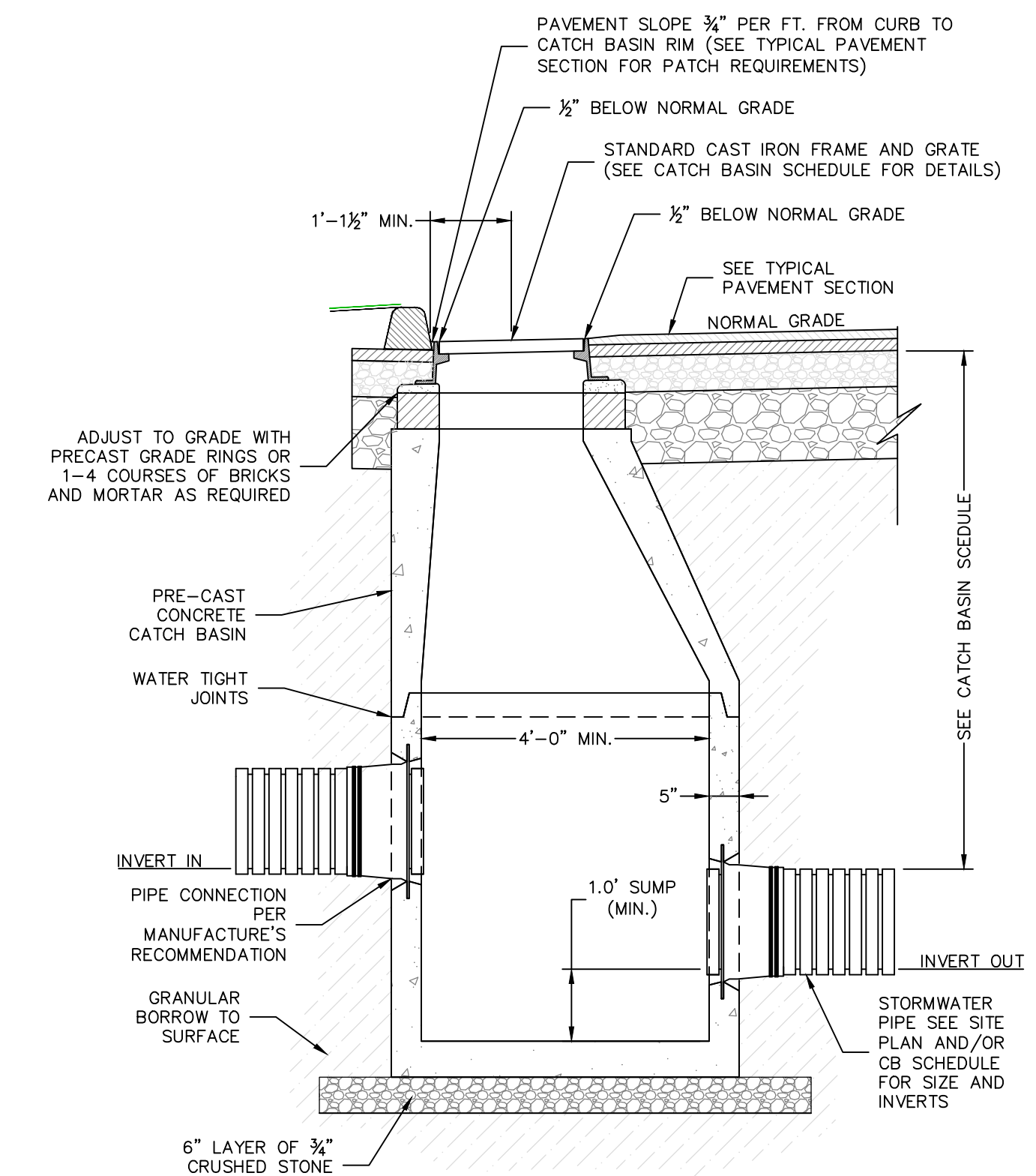

PRECAST CATCH BASIN
 NO SCALE

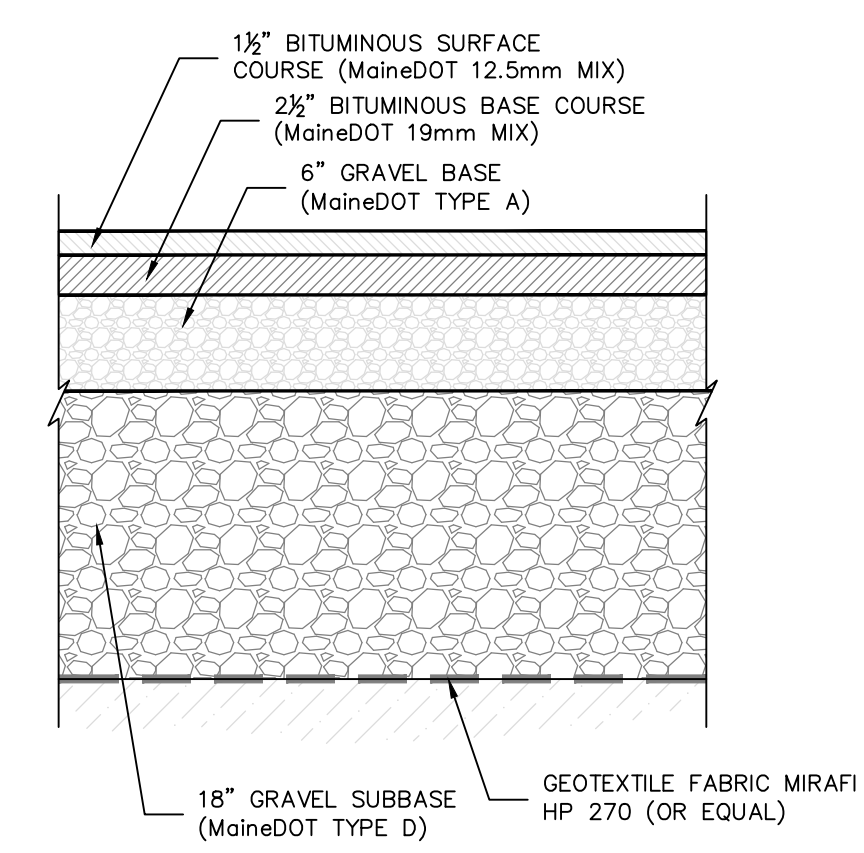

TYPICAL PAVEMENT SECTION
 NO SCALE

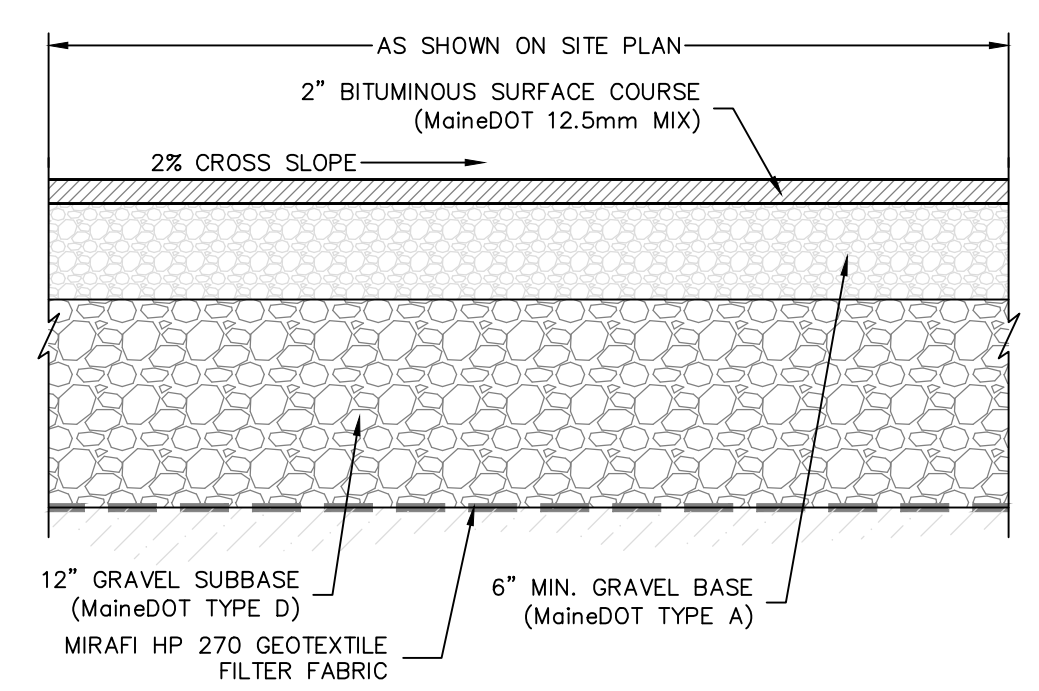

PAVED WALKWAY DETAIL
 NO SCALE

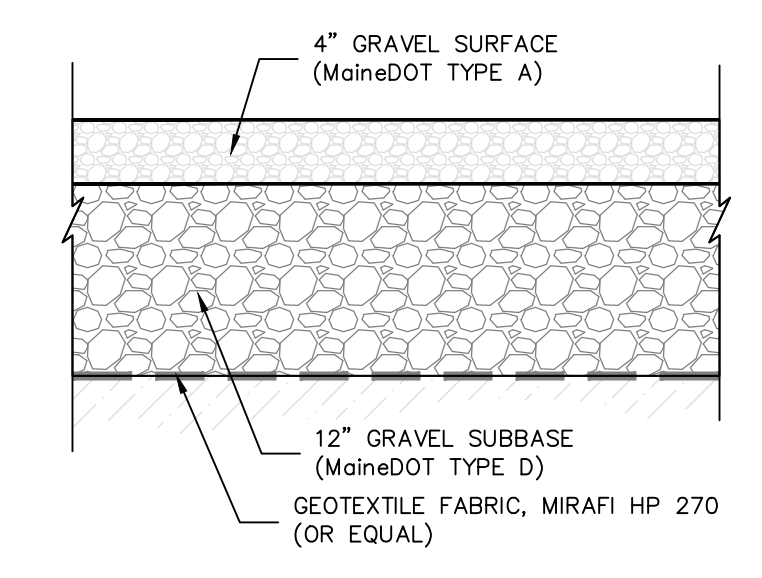

TYPICAL GRAVEL YARD SECTION
 NO SCALE

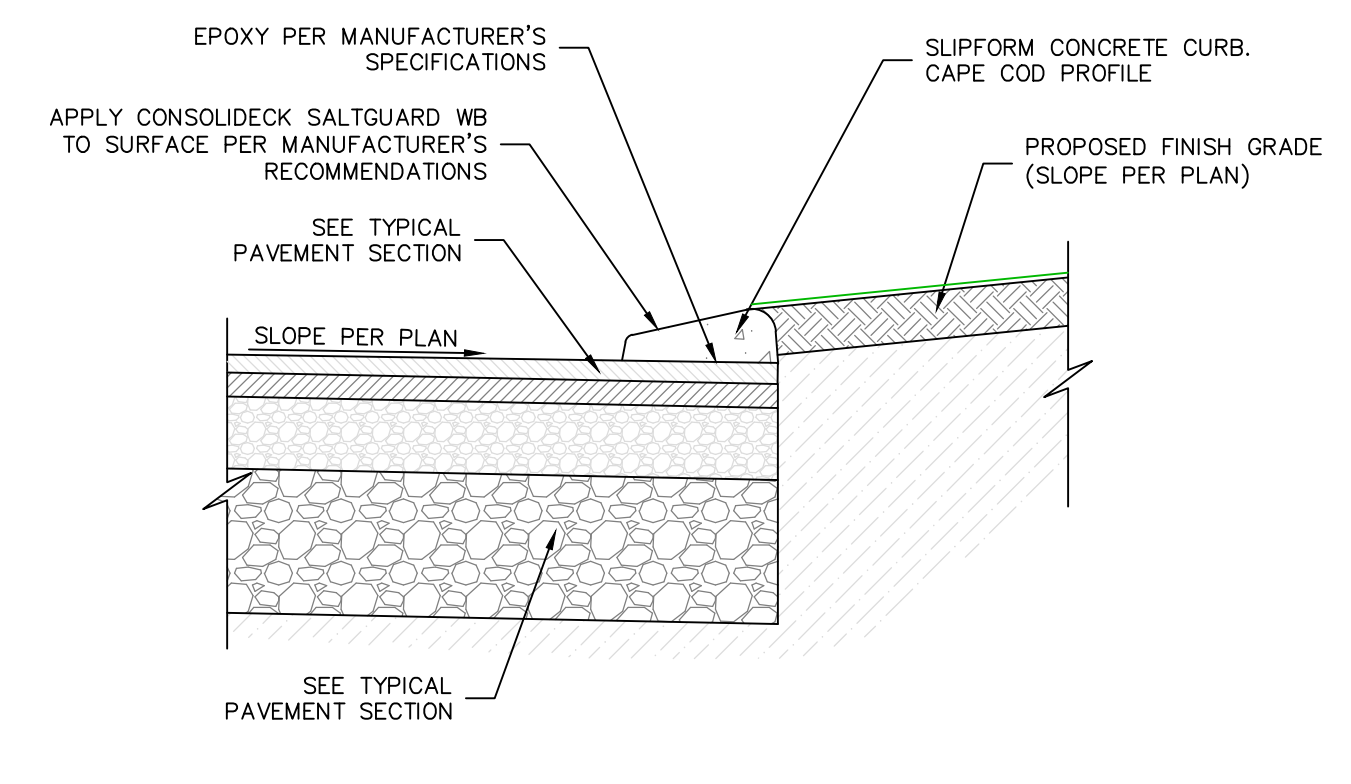

PAVED SECTION W/ SLIPFORM CAPE COD CURB SECTION
 NO SCALE

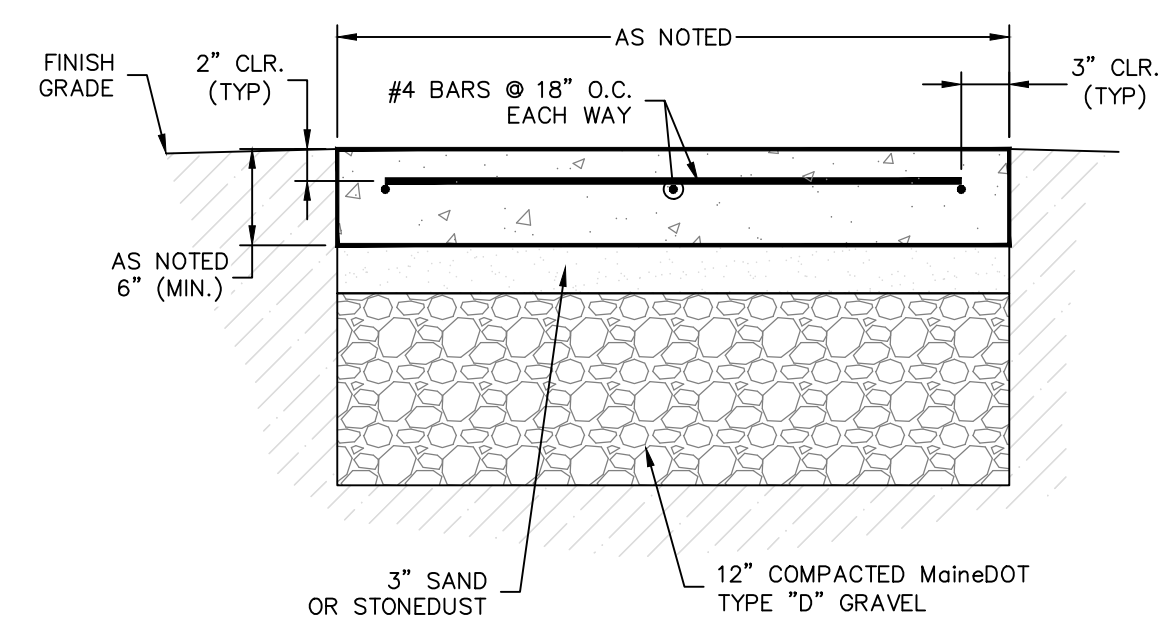

- CONCRETE SPECIFICATION:**
- 4000 P.S.I.
 - SLUMP = 4" ± 1"
 - 3/4" STONE
 - FINE BROOM FINISH
 - 6% AIR ENTRAINMENT
 - CONTROL JOINTS 12' MAX. SPACING
 - REINFORCING AND ANCHORING:
 • GRADE 60 DEFORMED BARS
 • ANCHOR BOLTS, 1/2" GALVANIZED, SET WITH TEMPLATE OR WITH MANUFACTURER'S DIMENSIONS, SCHEDULE PER MANUFACTURER.

EXTERIOR CONCRETE SLAB DETAIL
 NO SCALE

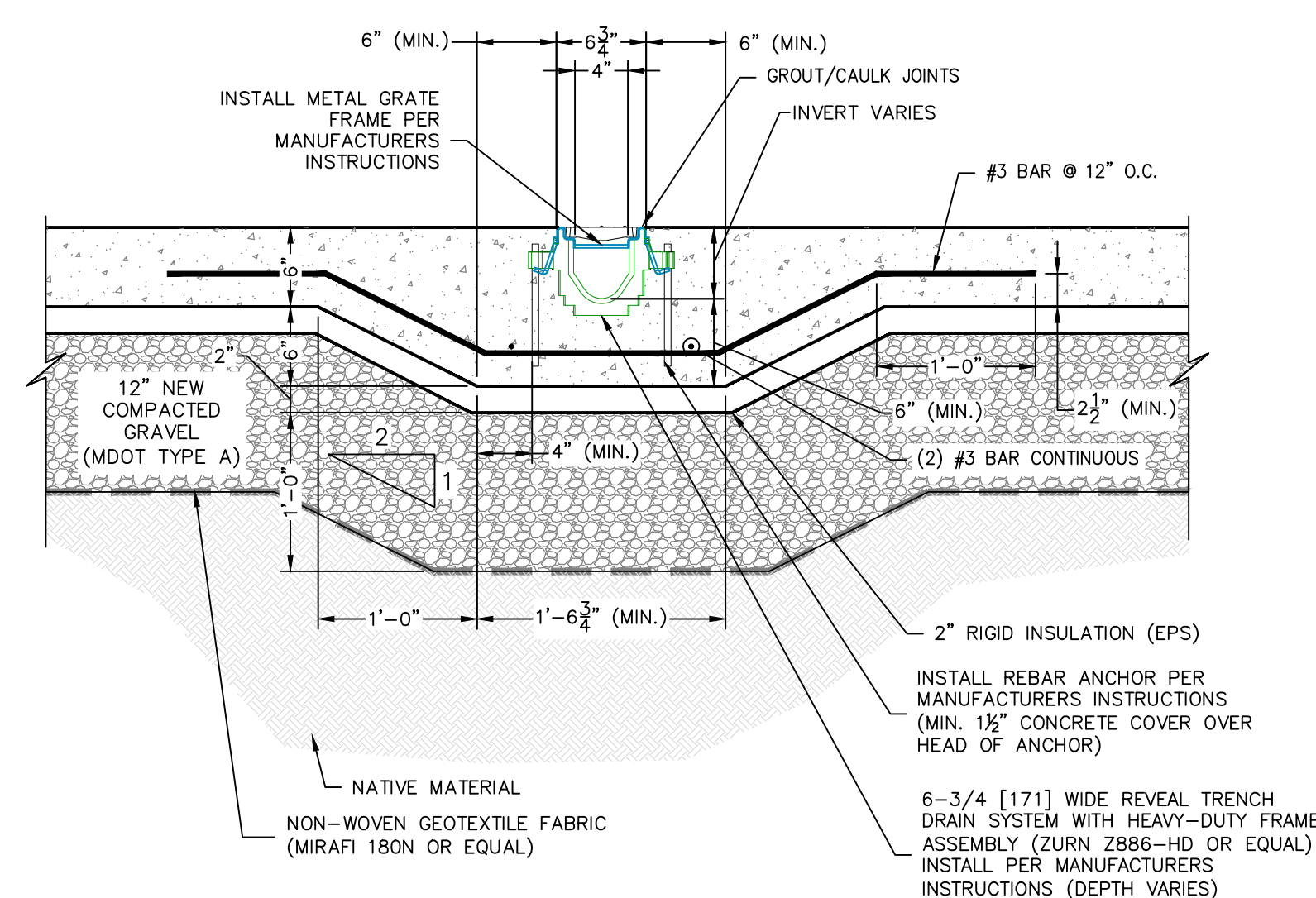

CONCRETE TRENCH DRAIN DETAIL
 NO SCALE

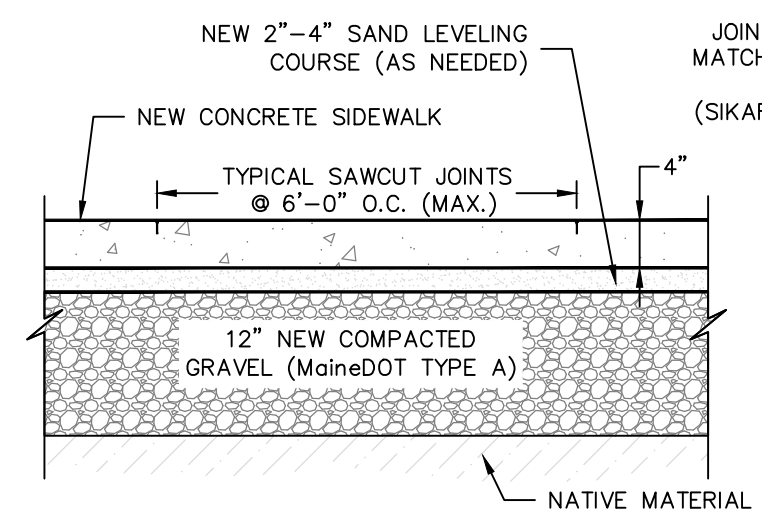

- CONCRETE SPECIFICATION:**
- 4000 P.S.I.
 - 3/4" STONE
 - 6%-8% AIR ENTRAINMENT
 - FIBER REINFORCEMENT
 - SLUMP = 3" ± 1"
 - SAWCUT JOINTS DEPTH SHALL BE 1" (MIN.) OR 1/4 THE SLAB THICKNESS.
- FINISH SPECIFICATION:**
- FINE BROOM FINISH
 - SAWCUT JOINTS A.S.A.P. @ 6'-0" O.C. (MAX.)
 - AFTER JOINTS HAVE BEEN FILLED AND SEALED APPLY CONSOLIDOCK SALTGUARD WB (APPLY ACCORDING TO MANUFACTURER'S SPECIFICATIONS).
 - SIDEWALK SHALL BE SLOPED TO DRAIN 2%

TYPICAL CONCRETE SIDEWALK DETAIL
 NO SCALE

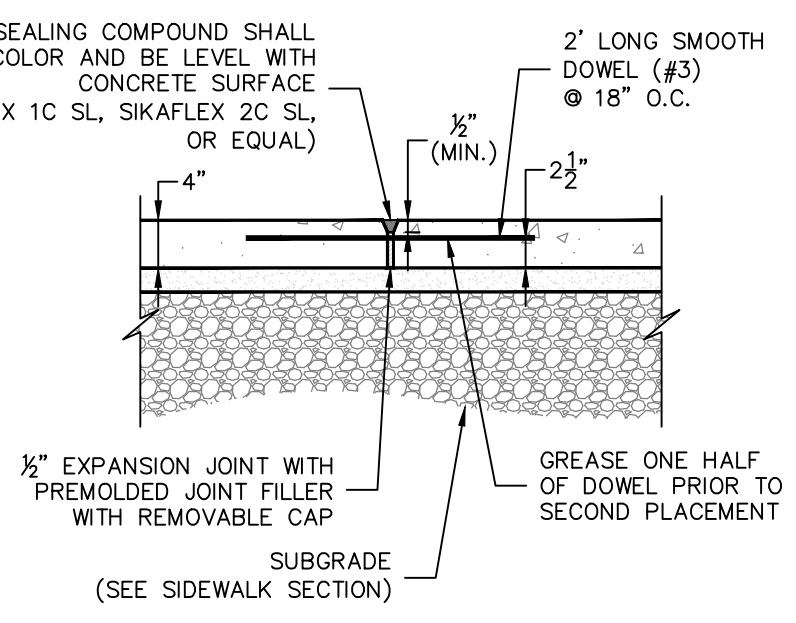

- EXPANSION JOINT SPECIFICATIONS:**
- SIDEWALK EXPANSION JOINTS SHALL BE PLACED @ 25' O.C. (MAX.).
 - NO CONCRETE MATERIAL SHALL FLOW UNDER FORMS.
 - DOWELS SHALL BE PLACED 18" O.C WITH 6" (MIN.) EDGE CLEARANCE.
 - CONTRACTOR MUST SAWCUT EXISTING SIDEWALK AT EXISTING TOOL JOINTS.

EXPANSION JOINT SECTION
 NO SCALE

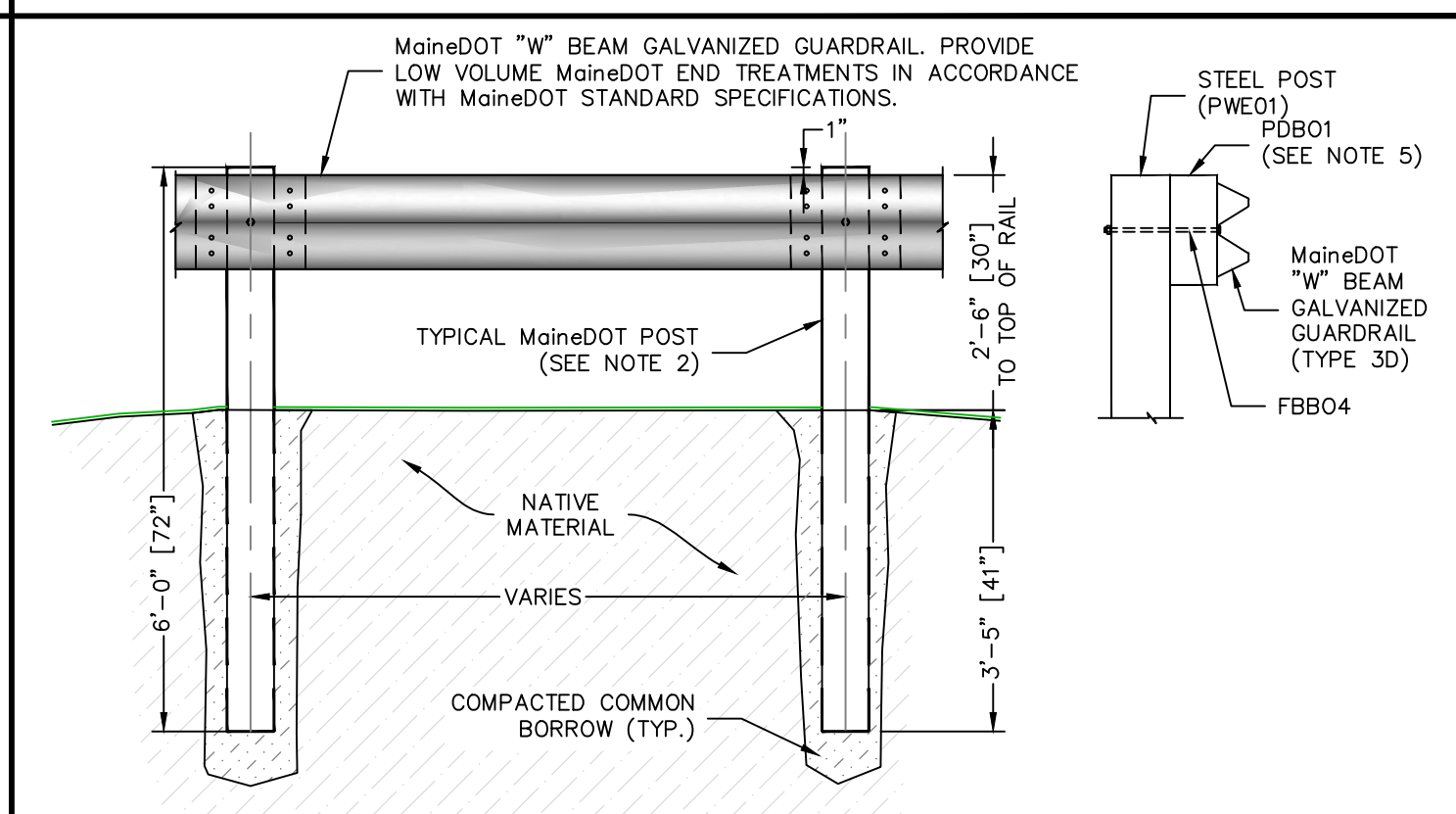

- GUARDRAIL NOTES:**
- INSTALL PER MAINE DEPARTMENT OF TRANSPORTATION STANDARD DETAILS.
 - THESE NOTES SHALL APPLY UNLESS SUPERSEDED BY NEWER MAINE DEPARTMENT OF TRANSPORTATION STANDARDS, IDENTIFIED IN MAINEDOT STANDARD DETAILS SECTION 606.
 - STEEL POSTS FOR GUARDRAIL SHALL BE W6x9.0 OR W6x8.5.
 - OFFSET BLOCKS SHALL BE INSTALLED ON ALL POSTS.
 - COMPOSITE OFFSET BLOCKS MAY BE AN ALTERNATIVE TO WOOD OFFSET BLOCKS PROVIDED THEY MEET NCHRP 350 REQUIREMENTS AND ARE INSTALLED ACCORDING TO MANUFACTURER'S SPECIFICATIONS.
 - BEAM TYPE GUARDRAIL SET ON A RADIUS OF 150' OR LESS SHALL BE CIRCULAR GUARDRAIL.
 - GUARDRAIL TERMINAL END (RWE03A) TO BE USED ONLY ON TRAILING END OF GUARDRAIL ON DIVIDED HIGHWAYS. WASHERS (FW03) SHALL BE INSTALLED ON THE LAST 9 POST.
 - IDENTIFICATION LETTERS AND NUMBERS ON DRAWINGS REFER TO STANDARD DETAIL DRAWING SHOWN IN "A GUIDE TO STANDARDIZED HIGHWAY BARRIER HARDWARE BY AASHTO-AGC-ARTBA JOINT COMMITTEE.

GALVANIZED GUARDRAIL DETAIL
 NOT TO SCALE

CIVIL DETAILS

KINGFISH MAINE

DUN GARVIN ROAD

WASHINGTON STATE/MAINE

JONESPORT

DATE: MARCH 25, 2021

SCALE: AS NOTED

CHECKED BY: HTL

DRAWN BY: LP

NO. _____

REVISIONS _____

DATE _____

Gartley & Dorsky ENGINEERING SURVEYING

59 Union Street, Unit 1, P.O. Box 1031 Camden, ME 04843-1031
 Ph: (207) 236-4365 Fax: (207) 236-3055 Toll Free: 1-888-282-4365
 105 Main Street, Suite 210 P.O. Box 1072 Dunbar, Maine 04845
 Ph: (207) 790-5405

PROJ. NO. 2019-412

C19