

EXHIBIT

15

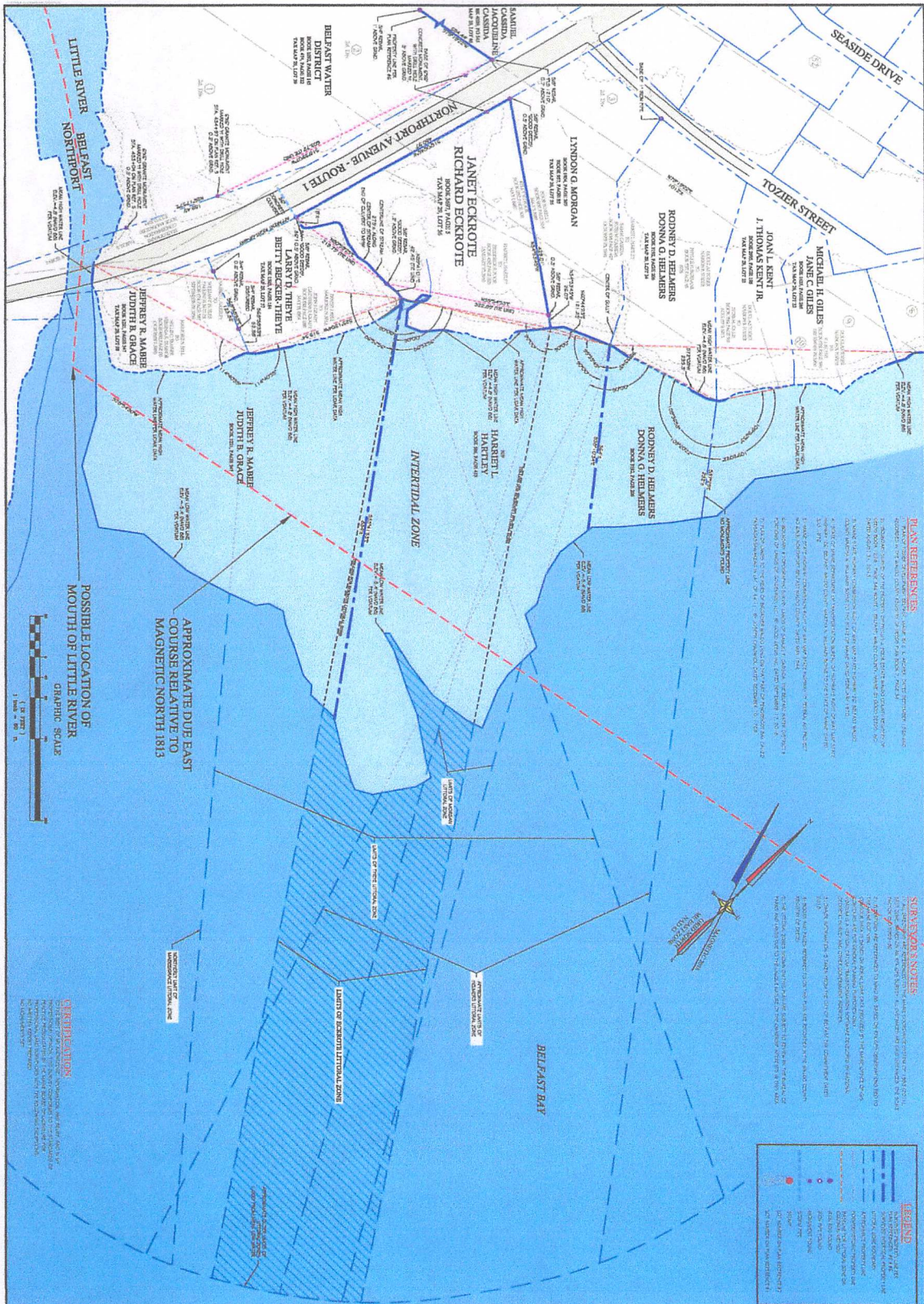

PLAN REFERENCES:
 1. BELFAST WATER DISTRICT MAP NO. 10-11-10, DATED 10/11/10, SHOWING PROPERTY LINES AND INTERESTS.
 2. BELFAST WATER DISTRICT MAP NO. 10-11-10, DATED 10/11/10, SHOWING PROPERTY LINES AND INTERESTS.
 3. BELFAST WATER DISTRICT MAP NO. 10-11-10, DATED 10/11/10, SHOWING PROPERTY LINES AND INTERESTS.
 4. BELFAST WATER DISTRICT MAP NO. 10-11-10, DATED 10/11/10, SHOWING PROPERTY LINES AND INTERESTS.
 5. BELFAST WATER DISTRICT MAP NO. 10-11-10, DATED 10/11/10, SHOWING PROPERTY LINES AND INTERESTS.
 6. BELFAST WATER DISTRICT MAP NO. 10-11-10, DATED 10/11/10, SHOWING PROPERTY LINES AND INTERESTS.
 7. BELFAST WATER DISTRICT MAP NO. 10-11-10, DATED 10/11/10, SHOWING PROPERTY LINES AND INTERESTS.
 8. BELFAST WATER DISTRICT MAP NO. 10-11-10, DATED 10/11/10, SHOWING PROPERTY LINES AND INTERESTS.
 9. BELFAST WATER DISTRICT MAP NO. 10-11-10, DATED 10/11/10, SHOWING PROPERTY LINES AND INTERESTS.
 10. BELFAST WATER DISTRICT MAP NO. 10-11-10, DATED 10/11/10, SHOWING PROPERTY LINES AND INTERESTS.

SURVEYOR'S NOTES:
 1. THIS SURVEY WAS CONDUCTED ON 1/25/19 BY GARTLEY & DORSKY ENGINEERING & SURVEYING, INC. (G&D).
 2. THE SURVEY WAS CONDUCTED USING A LEICA TS15 TOTAL STATION AND A LEICA DISTO D2 DISTANCE MEASURING DEVICE.
 3. THE SURVEY WAS CONDUCTED AT THE BELFAST WATER DISTRICT PROPERTY.
 4. THE SURVEY WAS CONDUCTED AT THE BELFAST WATER DISTRICT PROPERTY.
 5. THE SURVEY WAS CONDUCTED AT THE BELFAST WATER DISTRICT PROPERTY.
 6. THE SURVEY WAS CONDUCTED AT THE BELFAST WATER DISTRICT PROPERTY.
 7. THE SURVEY WAS CONDUCTED AT THE BELFAST WATER DISTRICT PROPERTY.
 8. THE SURVEY WAS CONDUCTED AT THE BELFAST WATER DISTRICT PROPERTY.
 9. THE SURVEY WAS CONDUCTED AT THE BELFAST WATER DISTRICT PROPERTY.
 10. THE SURVEY WAS CONDUCTED AT THE BELFAST WATER DISTRICT PROPERTY.

LEGEND	
	PROPOSED PROPERTY LINE
	INTERSTITIAL ZONE
	WATER BODY
	PROPERTY LINE
	EASEMENT
	RIGHT-OF-WAY
	OTHER

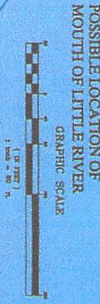

REMARKS:
 THIS SURVEY WAS CONDUCTED IN ACCORDANCE WITH THE STANDARDS AND PRACTICES OF THE PROFESSION OF SURVEYING AS SET FORTH IN THE RULES AND REGULATIONS OF THE BOARD OF SURVEYING ENGINEERS AND SURVEYORS OF THE STATE OF MAINE.

PROJECT NO. 181433 SK2	ADVANCE COPY	Gartley & Dorsky ENGINEERING & SURVEYING 99 Cedar Street, Two 1, P.O. Box 1031 - Gardon, ME 04845-0101 PH: (207) 234-6800 Fax: (207) 234-6801 Toll Free: 1-800-250-6800 165 Main Street Suite 20 P.O. Box 1872-Dunsmuir, Maine 04843 PH: (207) 790-9000	CLIENT/FIRM:	NORDIC AQUAFARMS	DRAWN BY:	AR/JAD
			LOCATION:	NORTHPORT AVENUE	SCALE:	1" = 80'
			TOWN:	BELFAST	DATE:	JANUARY 25, 2019
			COUNTY:	WALDO	STATE:	MAINE
			PRELIMINARY SKETCH PLAN		SHEET NO. OF BELFAST INTERSTITIAL ZONE	
					DATE	

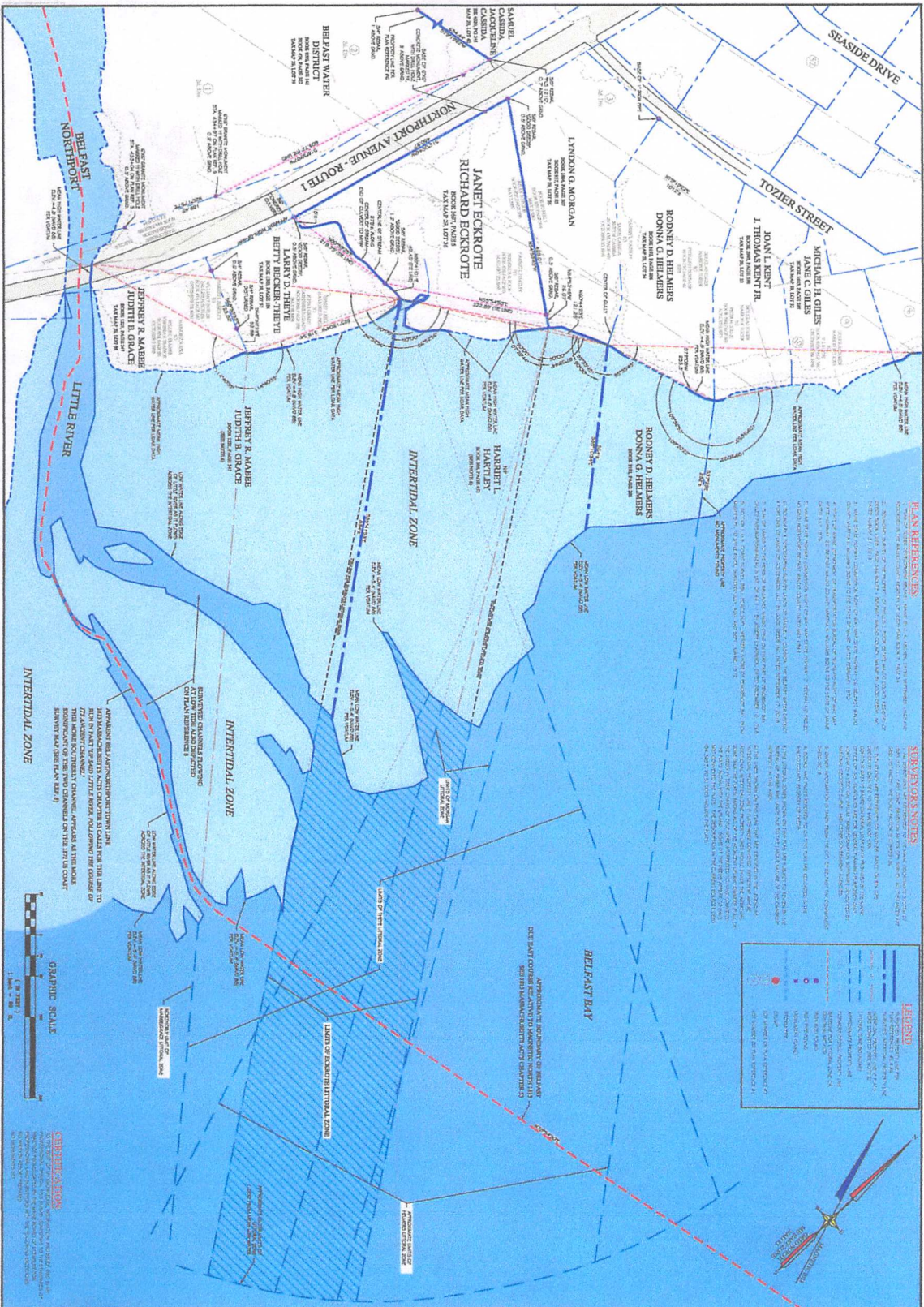

PLAN REFERENCES

REVISIONS

LEGEND

THIS PLAN IS PRELIMINARY
 STATE OF MAINE
 GARTLEY & DORSKY
 ENGINEERING SURVEYING
 50 Union Street, Unit 1, P.O. Box 1030, Camden, ME 04843-1030
 Tel: (207) 236-4363 Fax: (207) 236-3055 Toll Free: 1-800-282-4365
 103 Main Street, Suite 27, P.O. Box 1072, Scarborough, Maine 04953
 Tel: (207) 766-9865

NO.	DATE	DESCRIPTION
1	NOVEMBER 14, 2010	ISSUED FOR PERMIT
2		
3		
4		
5		
6		
7		
8		
9		
10		

PROJECT NO.	10-000
DATE	NOVEMBER 14, 2010
DRAWN BY	AW/JAD
CHECKED BY	JAD
SCALE	1" = 50'
LOCATION	NORTHPORT AVENUE
TOWN	BELFAST
COUNTY	WALDO
STATE	MAINE
DATE	NOVEMBER 14, 2010



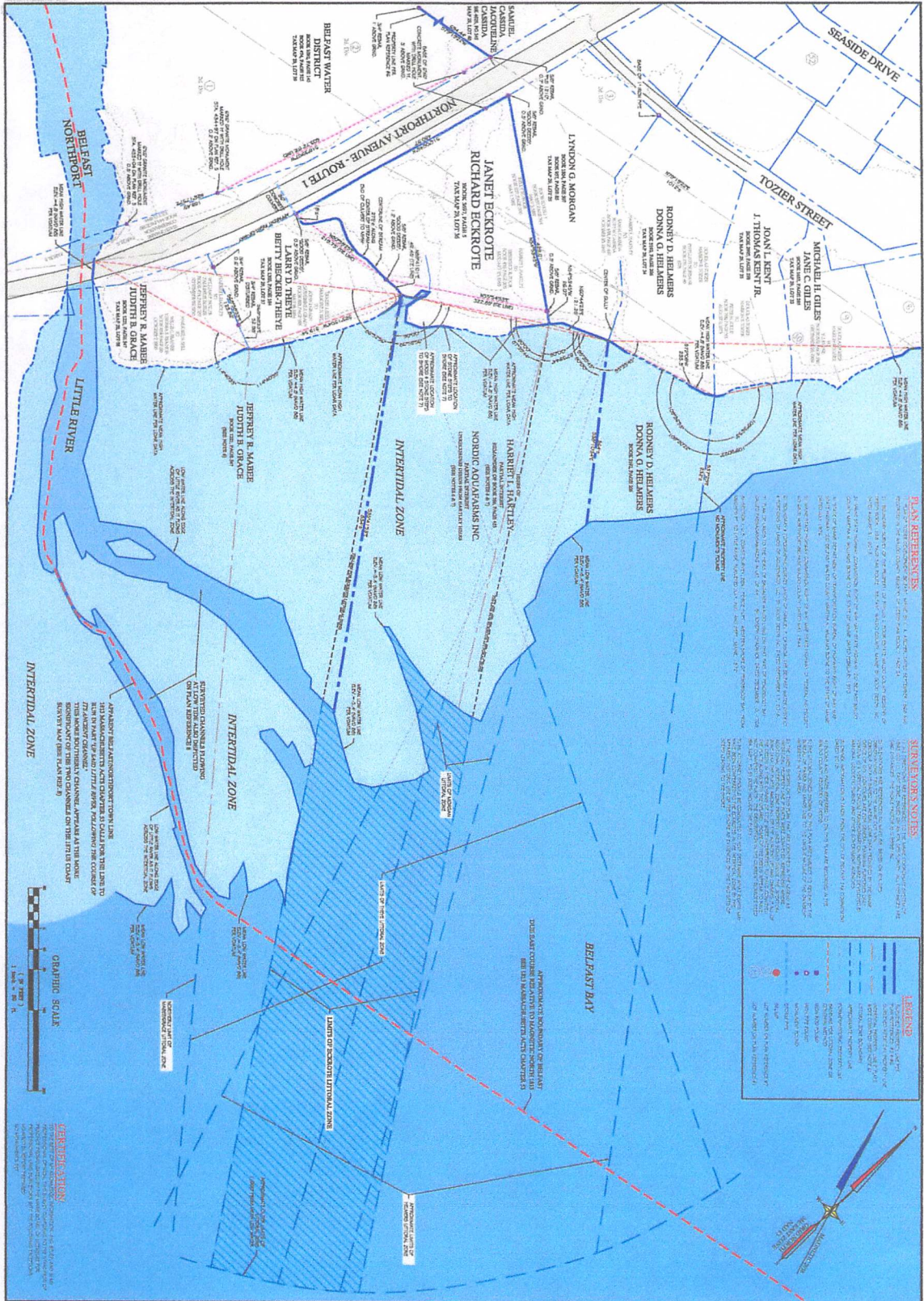

PLAN REFERENCES

GENERAL NOTES

LEGEND

1. This map was prepared for the purpose of showing the littoral and intertidal zones of Belfast, Maine, as defined in the Maine Revised Statutes, Title 30-A, § 1000. The map was prepared from a survey conducted on November 14, 2018, and is based on the best available information at that time.

2. The map shows the littoral zone, which is the area between the low tide line and the high tide line, and the intertidal zone, which is the area between the low tide line and the mean high water line. The map also shows the mean high water line, the mean low water line, and the low tide line.

3. The map is based on a survey conducted on November 14, 2018, and is based on the best available information at that time. The map is subject to change as more information becomes available.

4. The map is not to be used for any purpose other than that for which it was prepared. The map is not a warranty of any kind.

5. The map is the property of Gartley & Dorsky Surveying, Inc. and is not to be reproduced without the written consent of Gartley & Dorsky Surveying, Inc.



GRAPHIC SCALE
1" = 100'

REVISIONS

NO.	DESCRIPTION	DATE
1	ADDITIONAL INTERSTITIAL ZONE INFORMATION	04/18/2018
2	CONFORMANCE AND INTERSTITIAL ZONE ADJUSTMENT	08/20/18
3	REVISION OF COASTAL ZONE	08/20/18

Gartley & Dorsky
ENGINEERING SURVEYING

28 Union Street, Unit 1, P.O. Box 1031, Columbia, ME 04043-3032
 Tel: (207) 284-4543 Fax: (207) 284-4545 TOLL FREE: 1-800-363-8666
 145 Main Street, Suite 207 P.O. Box 1072, Easton, Maine 04545
 Tel: (207) 790-8800

CLIENT PROJECT:	NORDIC AQUAFARMS
LOCATION:	NORTHPORT AVENUE
TOWN:	BELFAST COUNTY: WALDO STATE: MAINE

SHEET TITLE:	LITTORAL ZONE & INTERSTITIAL ZONE SURVEY
SCALE:	1" = 80'
DATE:	NOVEMBER 14, 2018
DRAWN BY:	AMZ/SD
CHECKED BY:	JMG

DATE	
REVISIONS	

VI

ADVANCE COPY

