



APPLICATION FOR LEASE RENEWAL



Lease Acronym	MAQ BRE
Name of Leaseholder	Maine Oyster, Inc ; Edward Bradley
Name of Contact Person	Eric Horne or Valy Steverlock
Address	62 Pine St.
City	Freeport,
State, Zip	ME , 04032
Telephone	207. 522. 1520
Email	eric.lhorne@hotmail.com
Term Requested	20 yrs.

1. Describe the type and amount of aquaculture to be conducted during the new lease term:

As with the first term of the lease, we plan to use this site as a floating nursery (ADPI Bags). We plan to stock it with 1-2 million oysters each year. Seasonal use only June thru September.

2. Describe the amount of aquaculture conducted on the lease site during the previous lease term, including but not limited to seeding, cultivation or harvest of organisms:

This ^{is} was a nursery-only site - 1-2 million juvenile oysters in ADPI cages (Hoeking).
June thru September use, only.

3. Suspended culture gear can attract birds that roost on the gear and defecate, potentially creating a pollution source impacting shellfish held within gear. In order to comply with the National Shellfish Sanitation Program (NSSP) Model Ordinance (MO), if the lease site is permitted for the culture of shellfish in suspended gear, please include a description of mitigation or deterrent measures to minimize the potential pollution impacts of birds at the lease site. If appropriate, include sketches or photos that clearly depict those measures put into practice.

Examples may include:

- Suspended gear submerged at depth sufficient to deter roosting for at least two weeks before harvest
- Attaching physical deterrents (i.e. zip ties) to gear
- The lease site is used to culture shellfish seed only
- Only adductor-only shellfish are cultured on the lease site

Lease is for seed only. No direct market harvest.

4. Tax Maps and Riparian List

Is your existing lease within 1,000ft of shorefront land (which extends to mean low water or 1,650 ft. from shore, whichever is less, according to NOAA charts)?

Yes No

If yes, the following supporting documents are required:

A. Tax Map.

A labeled copy of the appropriate tax map(s) depicting the location of the proposed lease site.

The map(s) needs to include the following elements:

- Label the map "Tax Map: Town of (name of town)."
- Legible scale
- Tax lot numbers clearly displayed
- The boundaries of the existing lease

B. Riparian List.

Please use the Riparian Landowner List (included on the next page) to list the name and address of every shorefront landowner within 1,000 feet of your existing lease. Have the tax collector or clerk of the municipality certify the riparian list. Refer to the Riparian Determination guidance document to ensure all riparian landowners are included: <https://www.maine.gov/dmr/aquaculture/forms/documents/RiparianDetermination.pdf>

C. Check for \$1500 application fee

Signature of Leaseholder: _____



Date: _____

7/17/24

RIPARIAN LANDOWNER LIST

THIS LIST MUST BE CERTIFIED

On this list, please show the current landowners' names and mailing addresses as listed in the municipal tax records for all riparian shorefront parcels within 1,000 feet of the existing lease site along with the map and lot number for each parcel. **It is the applicant's responsibility to assemble the information for the Town Clerk to certify.** The Town Clerk only certifies that the information is correct according to the Town's records. Once you have completed the form, ask the Town Clerk to complete the certification section below. If the parcels are within more than one municipality, provide a separate, certified riparian list for each municipality.

TOWN OF: Brunswick, ME

MAP #	LOT #	Landowner name(s) and address(es)
28	13	Chase Reserve, LLC P.O. Box 419, Topsham, ME 04086
29	31	Kanwit John H. 4 Bunganuc Landing Rd. Kanwit, Evelyn H. Brunswick, ME 04011
29	32	McLaughlin, Daniel ; 6 Bunganuc Landing Rd. Wilson, Suzan Brunswick, ME 04011
29	33	Butler-Trustee, Katherine F Butler Revocable Trust & Bunganuc Landing Road. Brunswick, ME 04011

Please use additional sheets if necessary and attach hereto.

CERTIFICATION

I, Nancy G. Pinette, Appraiser Town Clerk for the Town of Brunswick certify that the names and addresses of the property owners listed above, as well as the map and lot numbers, are those listed in the records of this municipality and are current as of this date.

SIGNED: Nancy G. Pinette DATE: 7/17/24

RIPARIAN LANDOWNER LIST

THIS LIST MUST BE CERTIFIED

On this list, please show the current landowners' names and mailing addresses as listed in the municipal tax records for all riparian shorefront parcels within 1,000 feet of the existing lease site along with the map and lot number for each parcel. **It is the applicant's responsibility to assemble the information for the Town Clerk to certify.** The Town Clerk only certifies that the information is correct according to the Town's records. Once you have completed the form, ask the Town Clerk to complete the certification section below. If the parcels are within more than one municipality, provide a separate, certified riparian list for each municipality.

TOWN OF: Freeport, ME

MAP #	LOT #	Landowner name(s) and address(es)
<u>19</u>	<u>1</u>	<u>Jane Bradley 242 Flying Point Rd. - Freeport, ME 04032</u>
<u>19</u>	<u>1A</u>	<u>James R + Pamela M Matson Living Trusts 244 Flying Point Rd. Freeport, ME 04032</u>

Please use additional sheets if necessary and attach hereto.

CERTIFICATION

I, Carrie Weeman ^{Deputy} Town Clerk for the Town of Freeport certify that the names and addresses of the property owners listed above, as well as the map and lot numbers, are those listed in the records of this municipality and are current as of this date.

SIGNED: [Signature] DATE: 7/17/2024

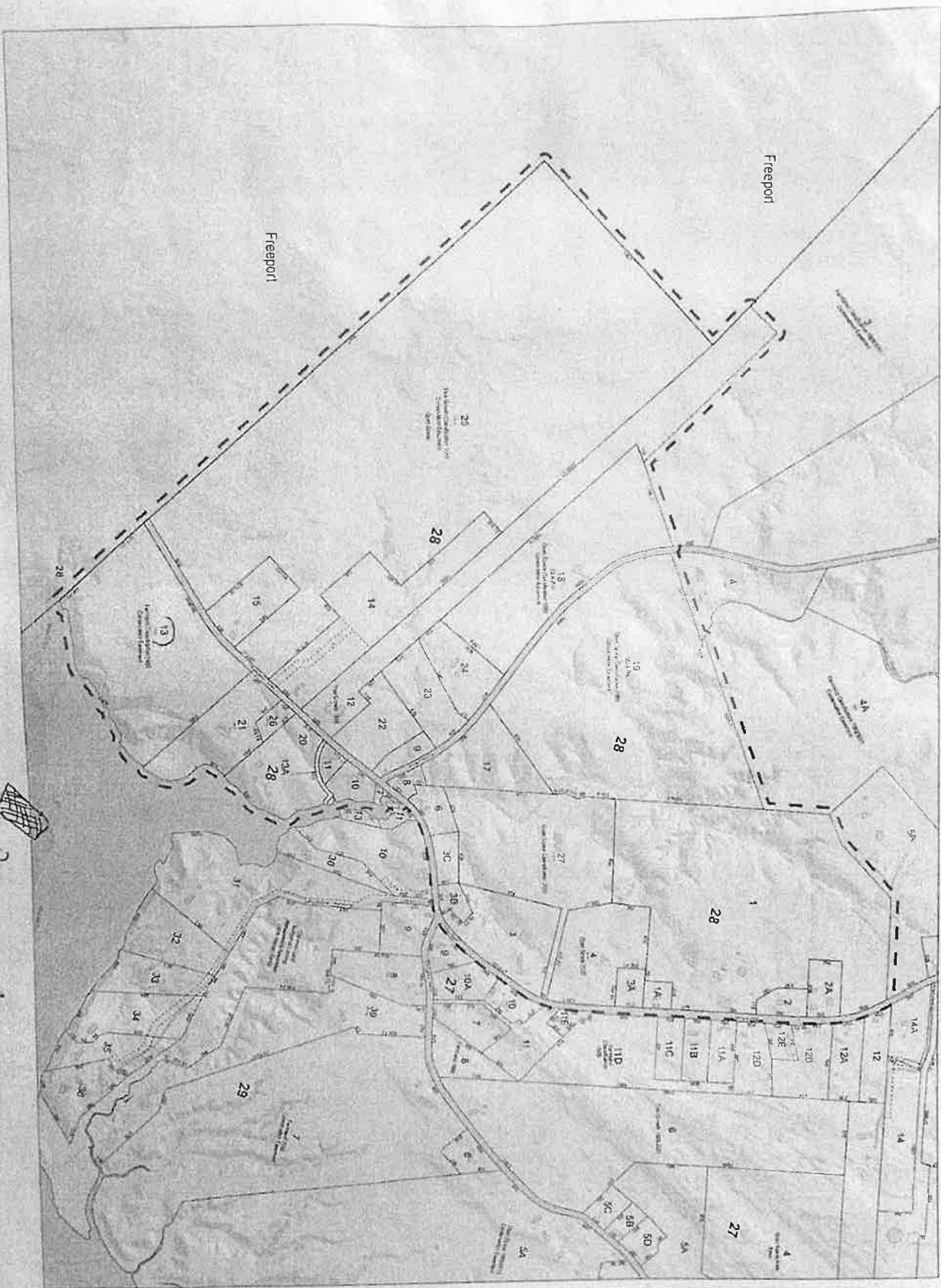

Revised! Loc. Approx.
 site (not really to scale)



- Legend**
- 100M Property Assessor
 - Town Boundary
 - Other T-1 Boundary
 - Precinct Lines
 - Water
 - Road
 - Rail
 - Air

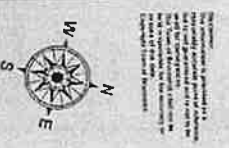

Map Prepared by
 GIS Administrator
 Town of Brunswick

MAP
28



Renewal
 Proposed
 Site
 (Not really to scale)
 Lot approx.



MAP: 019

2021



Scale = 500'

These maps are intended to be
 used for the purpose of providing
 the Assessor and should not
 be used for any other purpose.
 Revised to April 1st
 James H. Thomas
 Assessor of Freeport
 jth@freeportme.com



TOWN OF FREEPORT, MAINE
 PROPERTY MAPS

